

NOTICE DE MONTAGE
INSTRUCTIONS FOR ASSEMBLY
MONTAGEANLEITUNG
GEBRUIKSAANWIJZING
ISTRUZIONI DI MONTAGGIO
INSTRUCCIONES DE MONTAJE
INSTRUÇÕES DE MONTAGEM

buronomic
FABRICANT FRANÇAIS
N° DV40812

CONCEPTION ET REALISATION BUREAU D'ETUDES BURONOMIC

GARANTIE (vices cachés)
_ Référence produit à nous communiquer impérativement en cas de litige :
Voir étiquette apposée au dos du produit

GARANTIE (defekt)
_ In the event of complaint, it is essential to mention the product reference :
See label affixed to the back of the product.

GARANTIE (fabrikationsfeil)
_ Im streifall sit uns die produktreferenz mitzuteilen :
Siehe etikett auf produkdruckseite.

WAARBORG (de verborgen gebreken)
_ Vermeld in geval van klachten altijd het productnummer :
Zie label op de achterzijde van het product

GARANZIA (vizi occulti)
_ Specificare obbligatoriamente il riferimento prodotto in caso di contestazioni :
Si veda l'etichetta applicata dietro il prodotto

GARANTIA (defectos ocultos)
_ Referencia de producto citese obligatoriamente en caso de reclamacion :
Ver etiqueta en la parte posterior del producto.

GARANTIA (vices ocultas)
_ Em caso de reclamacao indiq-nos imperativamente a referencia do produto :
Ver etiqueta fixada na parte posterior do produto

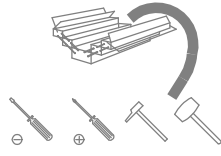
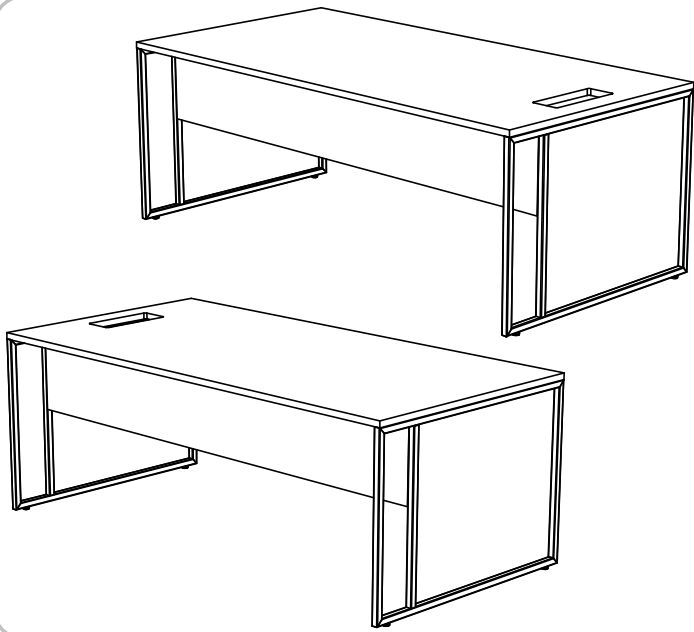
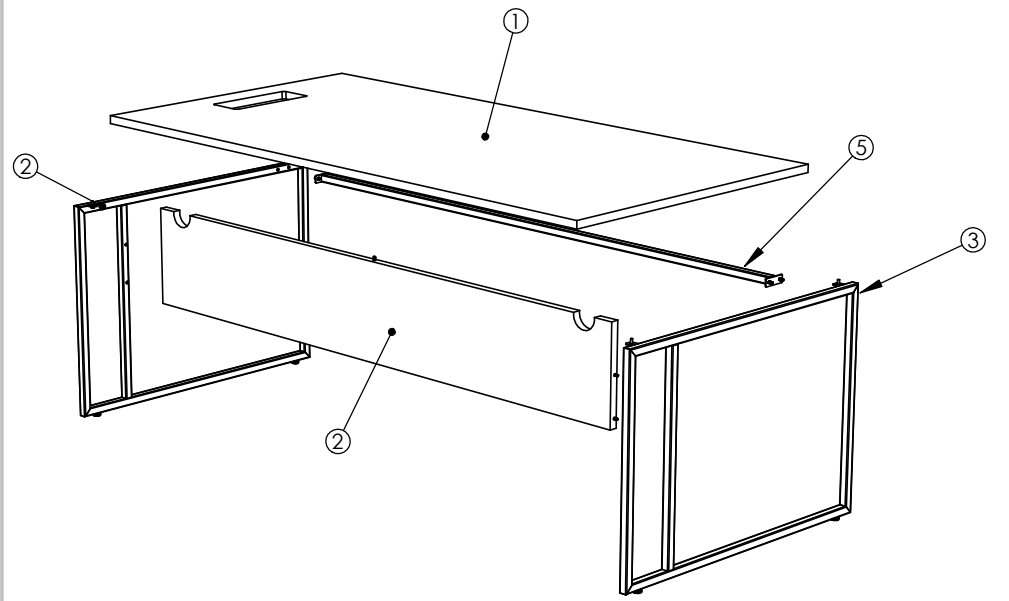

NOMENCLATURE

(Parts list)
(Stückliste)
(Onderdelenlijst)
(Nomenclatura)
(Lista de peças)

Rep.	Pièce	Qté
1	PLAN DE TRAVAIL TOP ACCESS	1
2	VDF	1
3	PIED 1000	1
4	PIED 1000	1
5	TRAVERSE	1

QUINCAILLERIE

(Hardware)
(Beschläge)
(Ijzerwaren)
(Ferramenta)
(Herrajes)
(Quinquilharia)

Rep.	Pièce	Qté	A	B	C
A	Excentrique Ø15	5			
B	Goujon métal	5			
C	VERIN Ø25 M8X17	4			
D	VIS TCHC M6x16	4			
E	VIS TBHc M6x16	8			
F	Clé 6 pans 4mm	1			
G	Clé 6 pans 5mm	1			
H	Cache excent.	5			
i*	GUIDE CABLE	1			

AIDE

HELP
HILFE
HULP
AYUDA
AJUDA
AIUTO

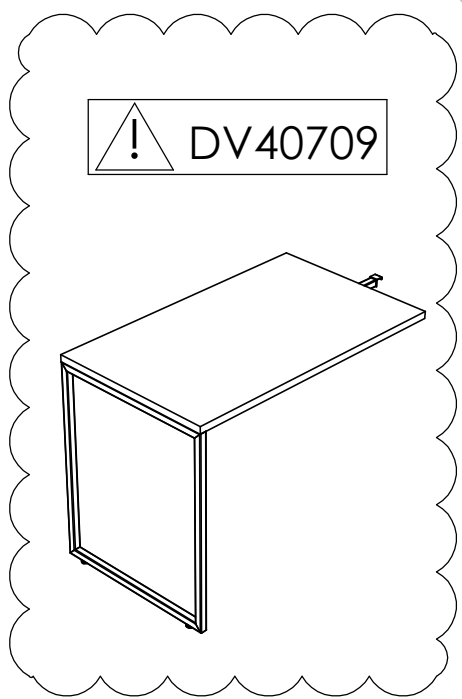
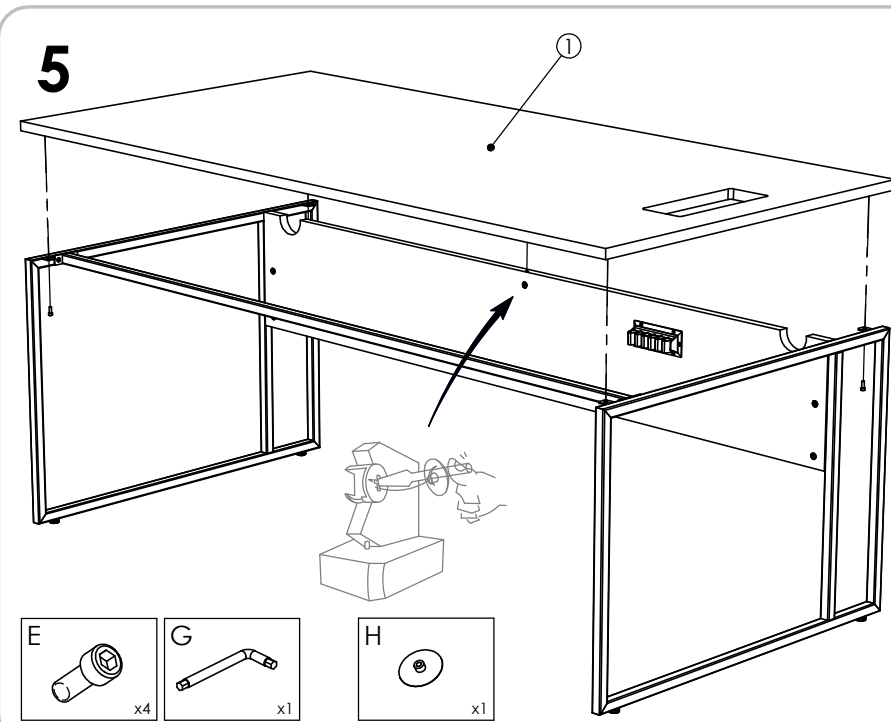
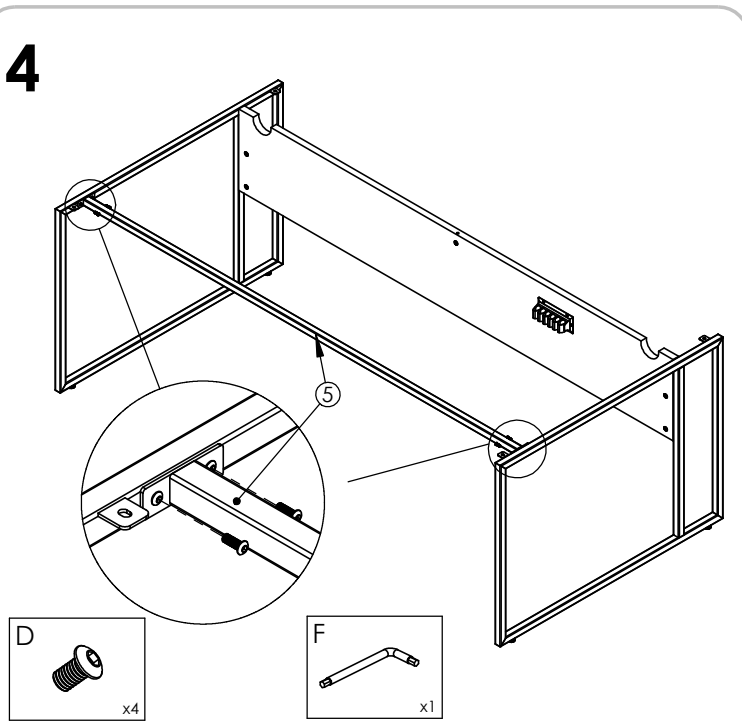
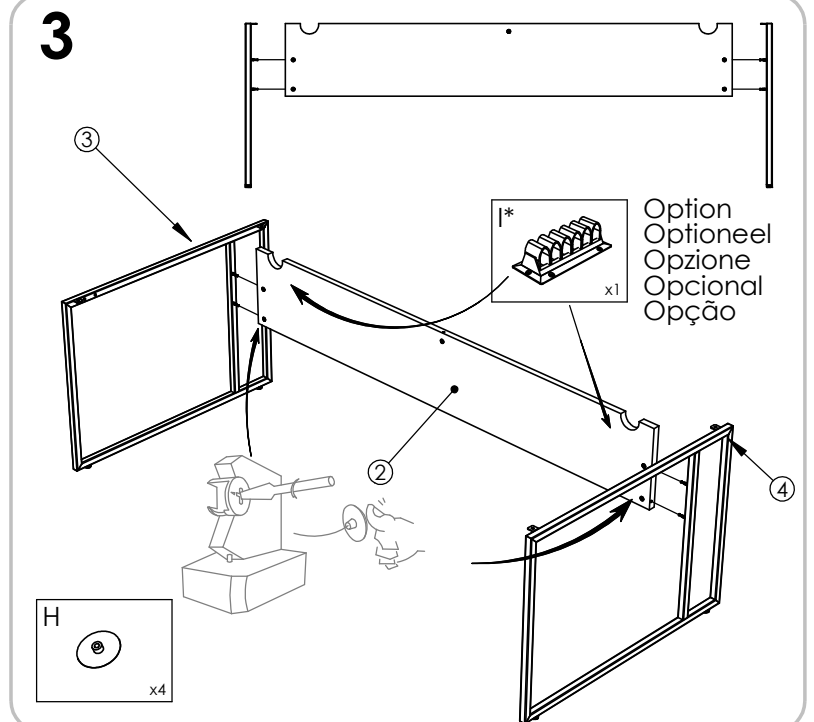
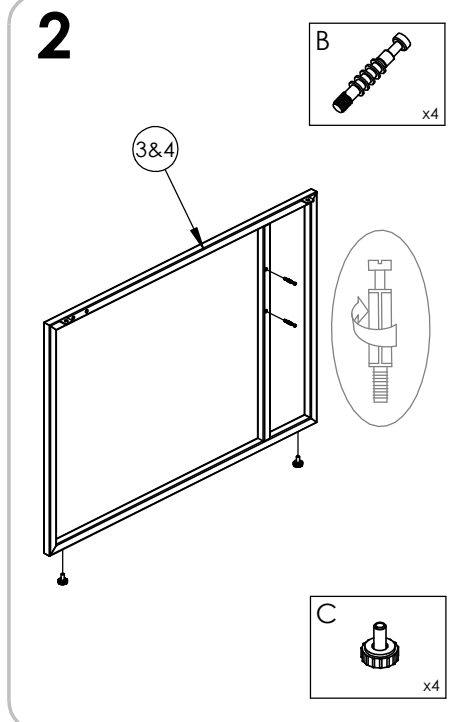
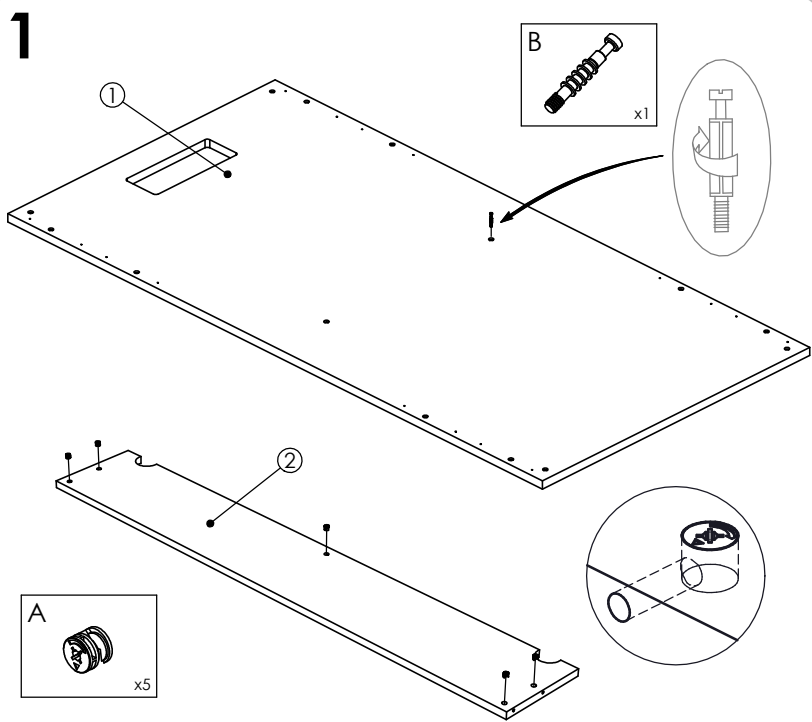
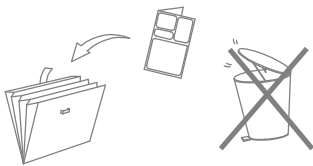
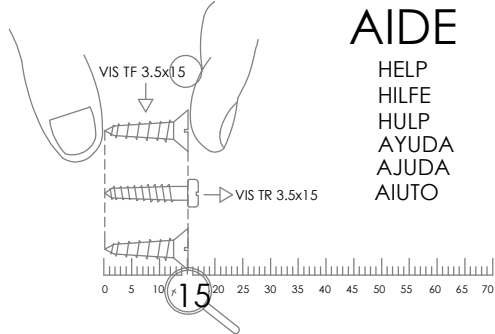

NOTICE DE MONTAGE
INSTRUCTIONS FOR ASSEMBLY
MONTAGEANLEITUNG
GEBRUIKSAANWIJZING
ISTRUZIONI DI MONTAGGIO
INSTRUCCIONES DE MONTAJE
INSTRUCCOES DE MONTAGEM

buronomic
FABRICANT FRANÇAIS
N° DV40709/02

CONCEPTION ET REALISATION BUREAU D'ETUDES BURONOMIC

GARANTIE (vices cachés)
_ Référence produit à nous communiquer impérativement en cas de litige :
Voir étiquette apposée au dos du produit

GARANTEE (defekt)
_ In the event of complaint, it is essential to mention the product reference :
See label affixed to the back of the product.

GARANTIE (fabrikationfehler)
_ Im streitfall sit uns die produktreferenz mitzuteilen :
Siehe etikett auf produktuckseite.

WAARBORG (de verborgen gebreken)
_ Vermeld in geval van klachten altijd het productnummer :
Zie label op de achterzijde van het product

GARANZIA (vizi occulti)
_ Specificare obbligatoriamente il riferimento prodotto in caso di contestazioni :
Si veda l'etichetta applicata dietro il prodotto

GARANTIA (defectos ocultos)
_ Referencia de producto citese obligatoriamente en caso de reclamacion :
Ver etiqueta en la parte posterior del producto.

GARANTIA (vices ocultas)
_ Em caso de reclamacao indiqu-nos imperativamente a referencia do produto :
Ver etiqueta fixada na parte posterior do produto

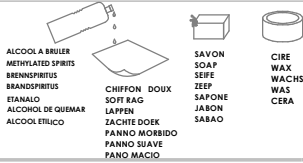
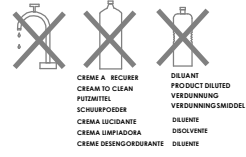
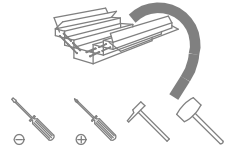
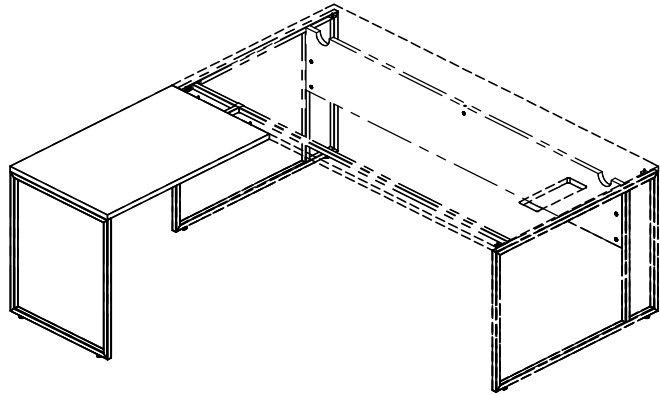
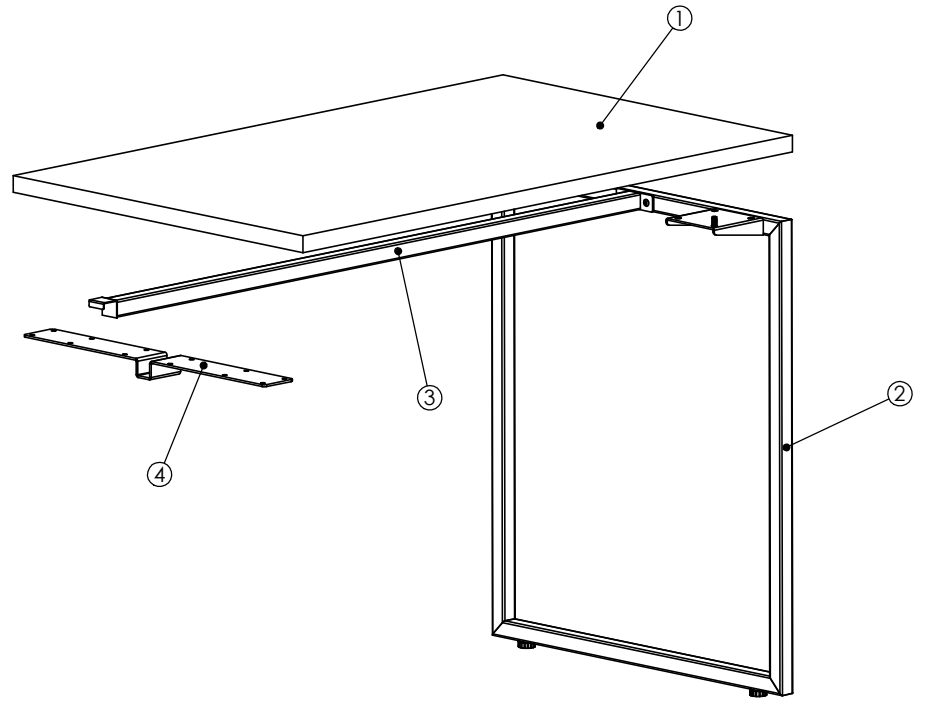

NOMENCLATURE

(Parts list)
(Stückliste)
(Onderdelenlijst)
(Nomenclatura)
(Lista de peças)

Rep.	Pièce	Qté
1	TOP	1
2	PIED de RETOUR	1
3	TRAVERSE RETOUR	1
4	PLATINE DE LIAISON	1

QUINCAILLERIE

(Hardware)
(Beschläge)
(Izerwaren)
(Ferramentas)
(Quinquilharia)

Rep.	Pièce	Qté	A	B	C
A	VERIN Ø25 M8X17	6			
B	VIS TBHc M6x10	2			
C	VIS TBHc M6x16	8			
D	Clé 6 pans 4mm	1			
			G	H	I
			J	K	L
			M	N	O
			P	Q	R

AIDE

HELP
HILFE
HULP
AYUDA
AJUDA
AIUTO

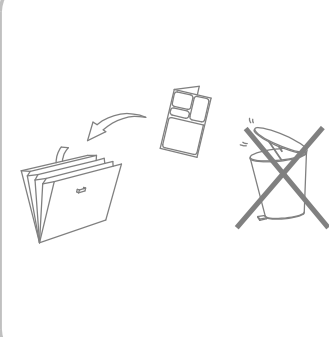
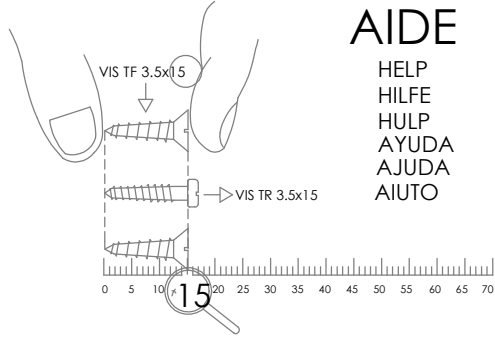

1

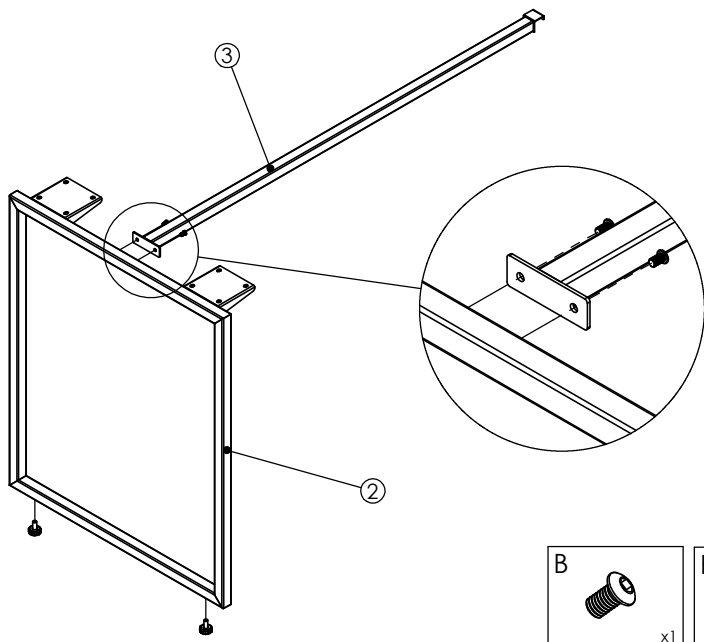

2

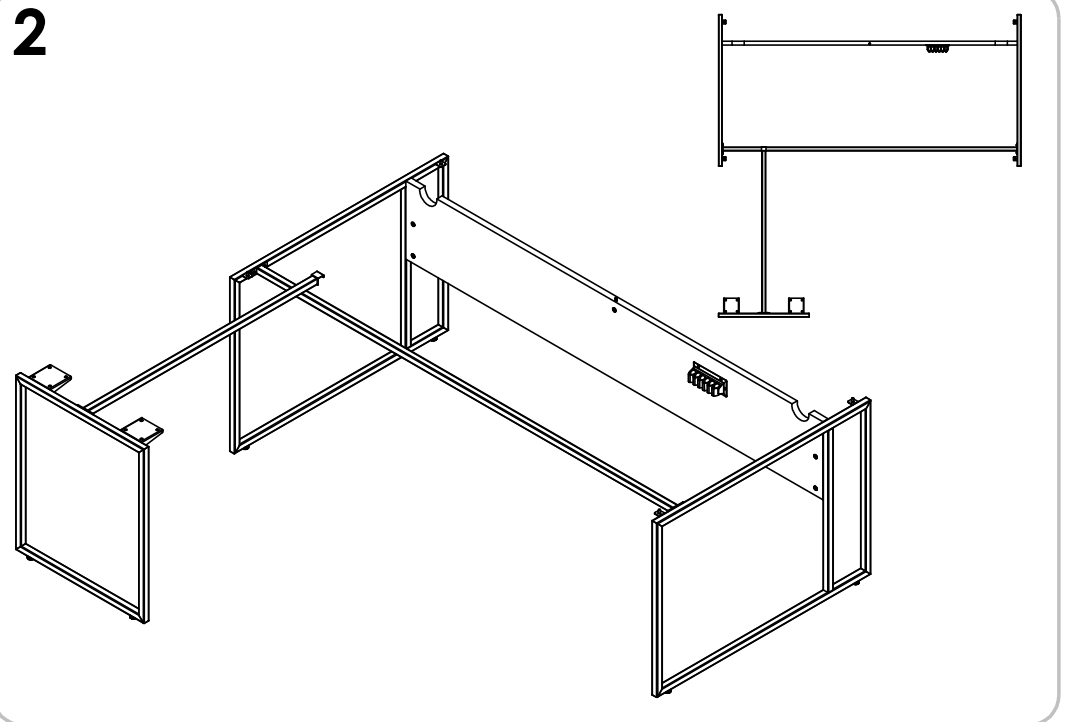

3

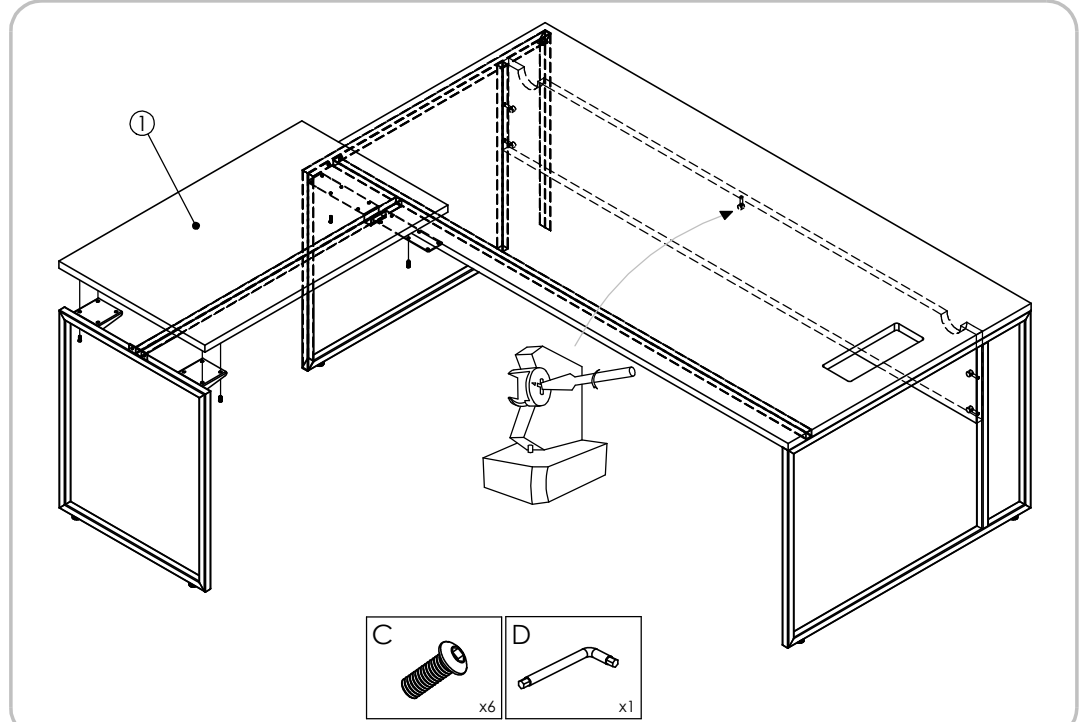
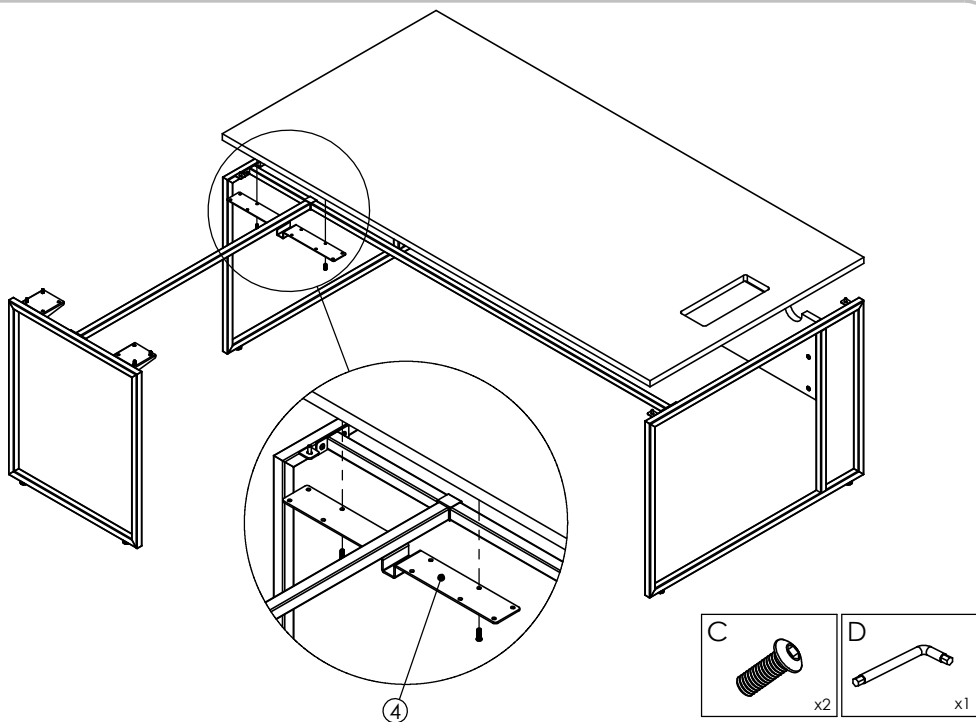

NOTICE DE MONTAGE
INSTRUCTIONS FOR ASSEMBLY
MONTAGEANLEITUNG
GEBRUIKSAANWIJZING
ISTRUZIONI DI MONTAGGIO
INSTRUCCIONES DE MONTAJE
INSTRUÇÕES DE MONTAGEM

buronomic
FABRICANT FRANÇAIS
N° DV40713/01

CONCEPTION ET REALISATION BUREAU D'ETUDES BURONOMIC

GARANTIE (voies cachées)
_ Référence produit à nous communiquer impérativement en cas de litige :
Voir étiquette apposée au dos du produit

GARANTIE (defekt)
_ In the event of complaint, it is essential to mention the product reference :
See label affixed to the back of the product.

GARANTIE (fabrikationsfeil)
_ Im streifall sit uns die produktreferenz mitzuteilen :
Siehe etikett auf produktrückseite.

WAARBORG (de verborgen gebreken)
_ Vermeld in geval van klachten altijd het productnummer :
Zie label op de achterzijde van het product

GARANZIA (vizi occulti)
_ Specificare obbligatoriamente il riferimento prodotto in caso di contestazioni :
Si veda l'etichetta applicata dietro il prodotto

GARANTIA (defectos ocultos)
_ Referencia de producto citese obligatoriamente en caso de reclamacion :
Ver etiqueta en la parte posterior del producto.

GARANTIA (vizi oculte)
_ Em caso de reclamação indiqu-nos imperativamente a referência do produto :
Ver etiqueta fixada na parte posterior do produto

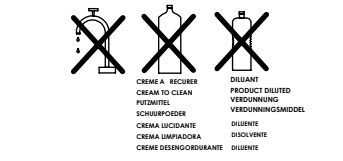
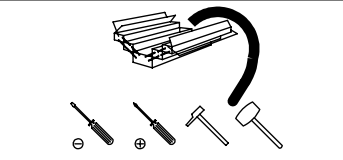
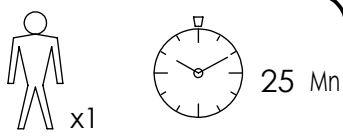
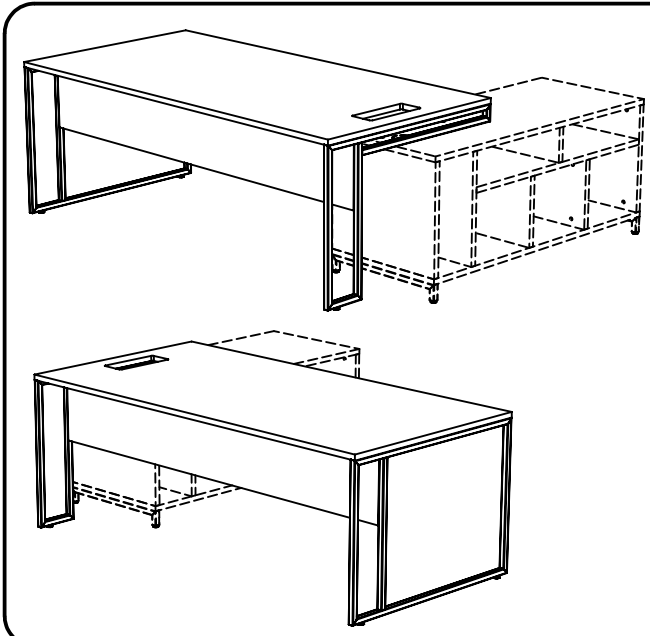
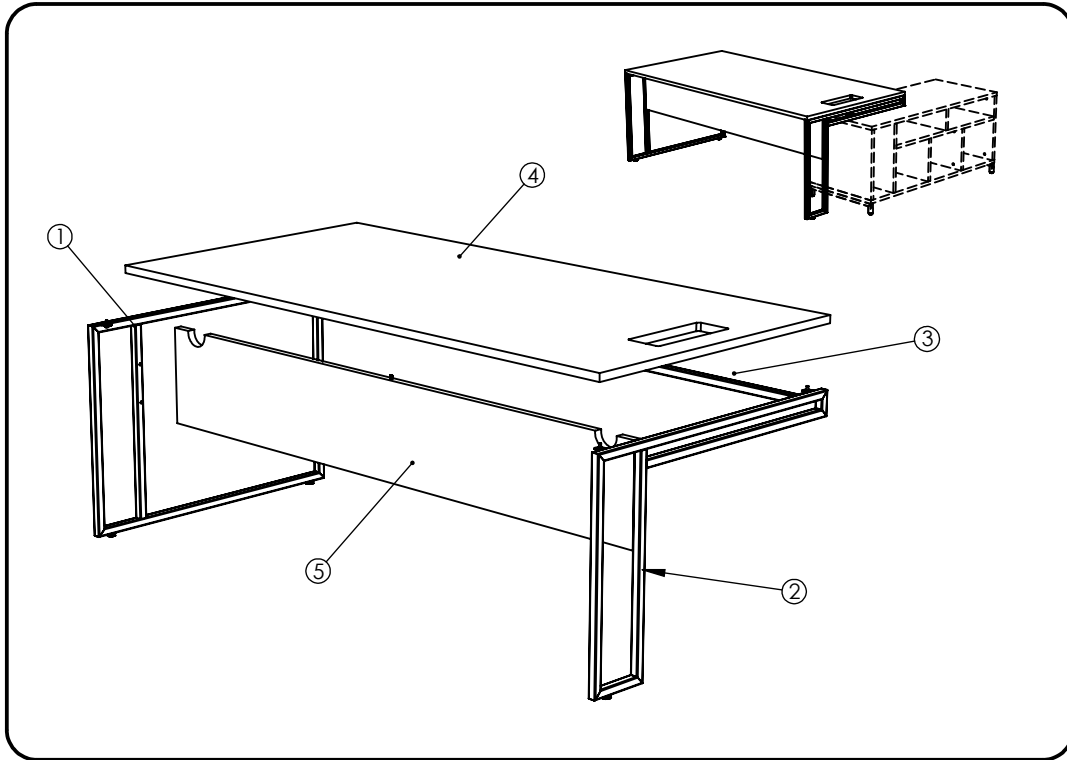

NOMENCLATURE
(Parts list)
(Stückliste)
(Onderdelenlijst)
(Nomenclatura)
(Lista de peças)

Rep.	Pièce	Qté
1	PIED 1000	1
2	PIED DE RETOUR CABINET	1
3	TRAVERSE	1
4	PLAN DE TRAVAIL TOP ACCESS	1
5	VDF	1

QUINCAILLERIE
(Hardware)
(Beschläge)
(Ijzerwaren)
(Ferramentas)
(Herrajes)
(Quinquilharia)

Rep.	Pièce	Qté	A	B	C
A	Excentrique Ø15	5			
B	Goujon métal	5			
C	VERIN Ø25 M8X17	3			
D	VIS TCHC M6x16	4			
E	VIS TBHC M6x16	4			
F	Cache excent.	5			
G	Clé 6 pans 4mm	1			
H	Clé 6 pans 5mm	1			
J					
K					
L					
M					
N					
O					
P					
Q					
R					

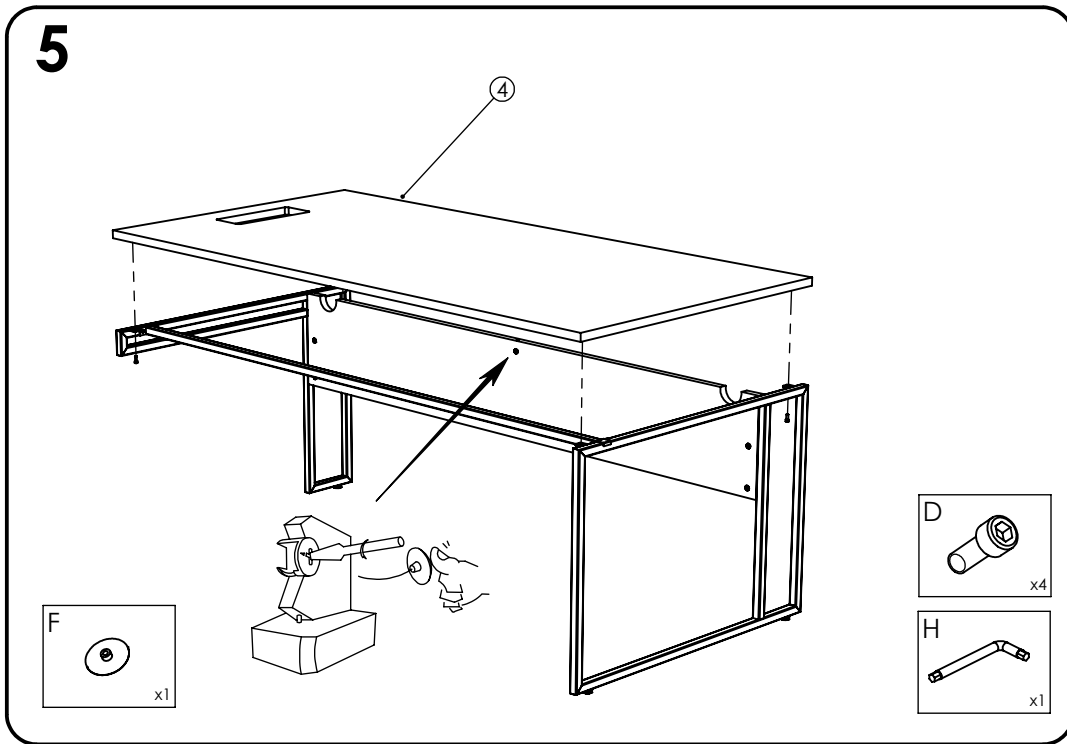
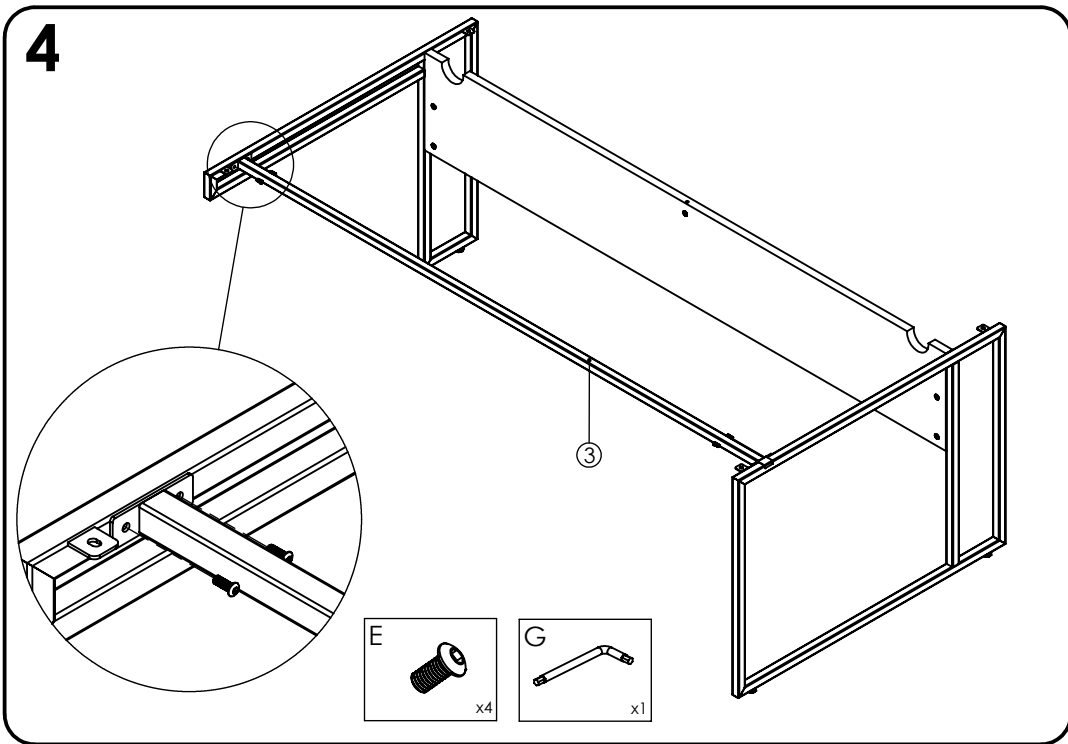
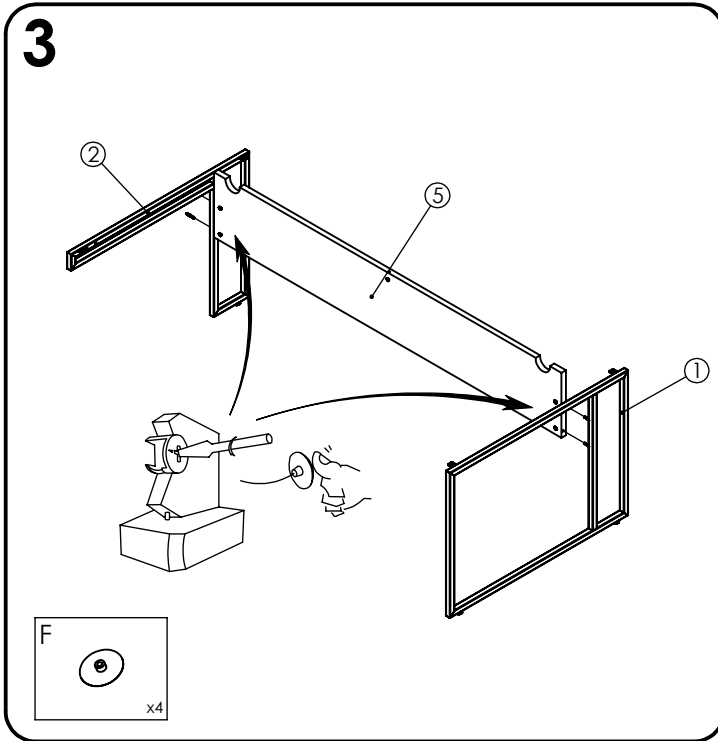
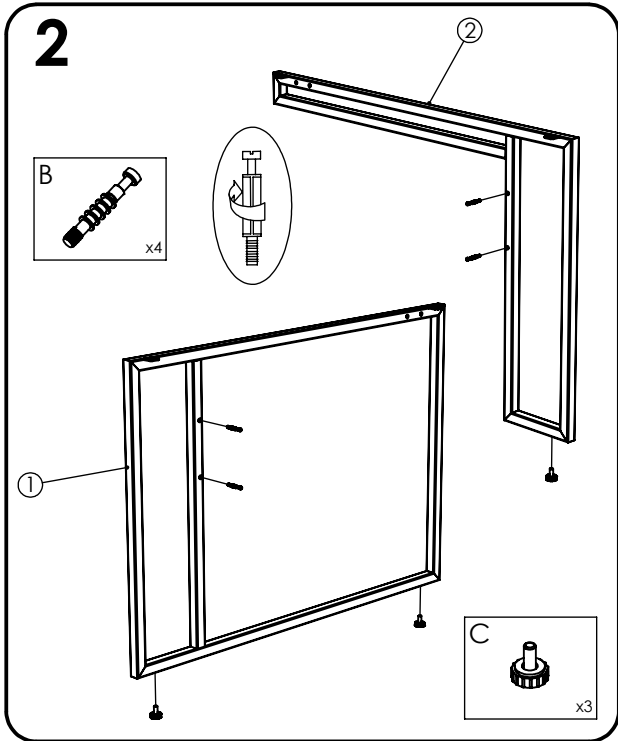
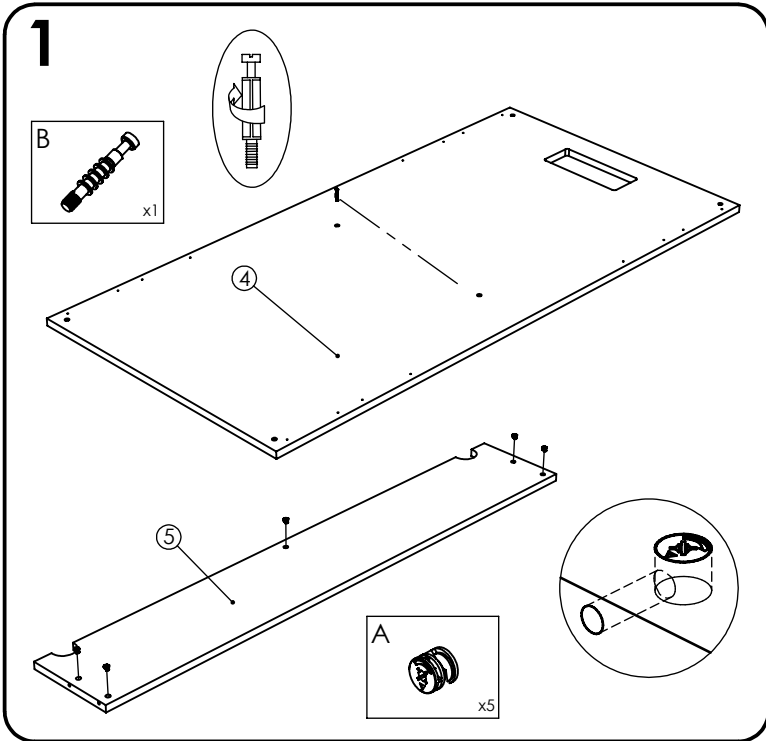
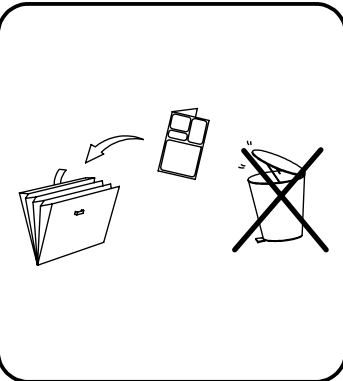
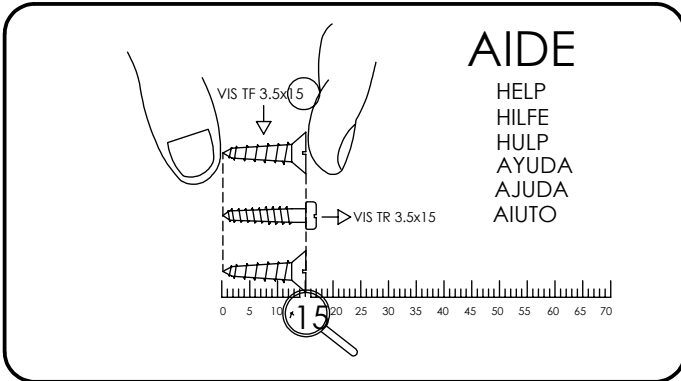

NOTICE DE MONTAGE
INSTRUCTIONS FOR ASSEMBLY
MONTAGEANLEITUNG
GEBRUIKSAANWIJZING
ISTRUZIONI DI MONTAGGIO
INSTRUCCIONES DE MONTAJE
INSTRUCCOES DE MONTAGEM

buronomic

N° DV40716/01

CONCEPTION ET REALISATION BUREAU ETUDES BURONOMIC

GARANTIE (vires cachets)
Référence produit à nous communiquer impérativement en cas de litige :
Voir étiquette apposée au dos du produit

GARANTIE (vires cachets)
In the event of complaint, it is essential to mention the product reference :
See label affixed to the back of the product.

GARANTIE (fabrikgarantie)
Im streitfall sit uns die produktreferenz mitzutellen :
Siehe etikett auf produkttruckselle.

WAARBORG (de vestoggen gebroeken)
Vermeld in geval van klachten altijd het productnummer :
Zie label op de achterzijde van het product

GARANZIA (vires cachets)
Specificare obbligatoriamente il riferimento prodotto in caso di contestazioni :
Si veda l'etichetta applicata dietro il prodotto

GARANTIA (de factura recibida)
Referencia de producto citese obligatoriamente en caso de reclamacion :
Ver etiqueta en la parte posterior del producto.

GARANTIA (vires cachets)
Em caso de reclamacao indiqu-nos imperativamente a referencia do produto :
Ver etiqueta fixada na parte posterior do produto

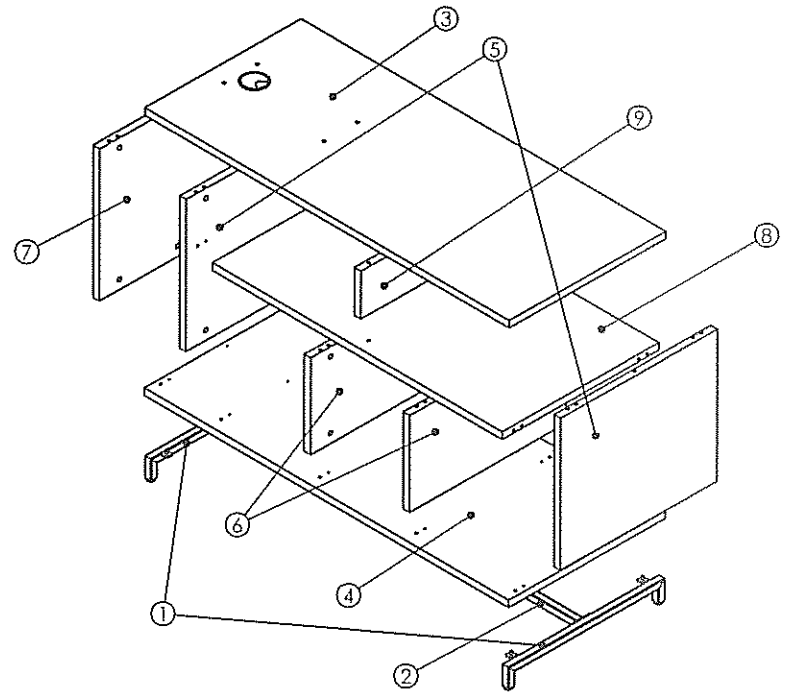
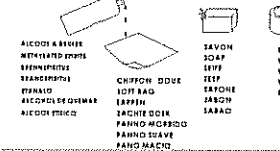
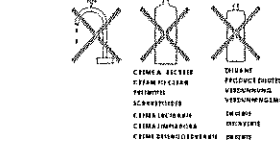
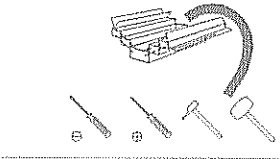
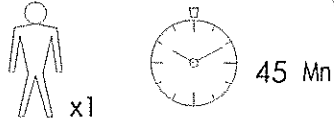
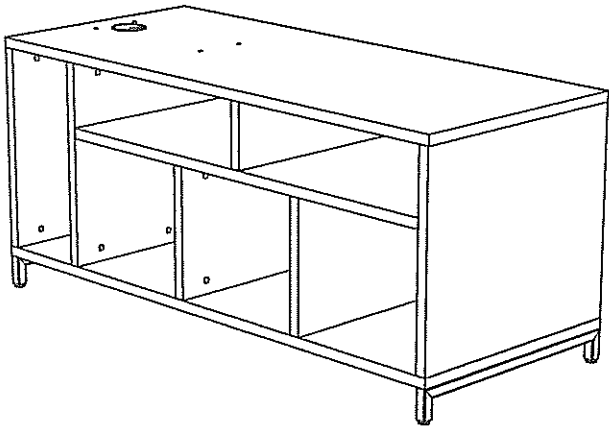

NOMENCLATURE (Parts list)
(Stückliste)
(Nomenclatura)
(Lista de peças)

Rep.	Pièce	Qté
1	PIED MEUBLE BAS	2
2	TRAVERSE	1
3	DESSUS	1
4	FOND	1
5	COTE & SEPARATIONS	2
6	COTE & SEPARATIONS	2
7	COTE & SEPARATIONS	1
8	COTE & SEPARATIONS	1
9	SEPARATION HAUTE	1

QUINCAILLERIE

Rep.	Pièce	Qté
A	Excentrique Ø15	30
B	Goujon bois	30
C	VERIN Ø25 M8X17	4
D	VIS TBHc M6x10	4
E	VIS TCHC M6x16	4
F	Cache exent.	30
G	VIS TBHc M8x35	2
H	Cache Ø10	2
I	Clé 6 pans 4mm	1
J	Clé 6 pans 5mm	1

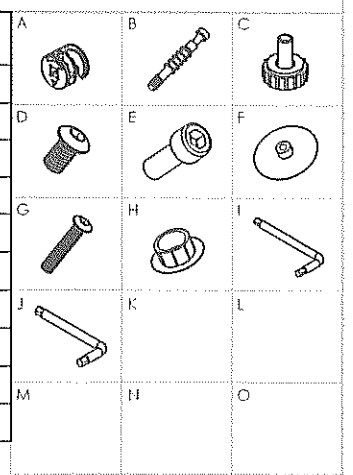

AIDE

HELP
HILFE
HULP
AYUDA
AJUDA
AIUTO

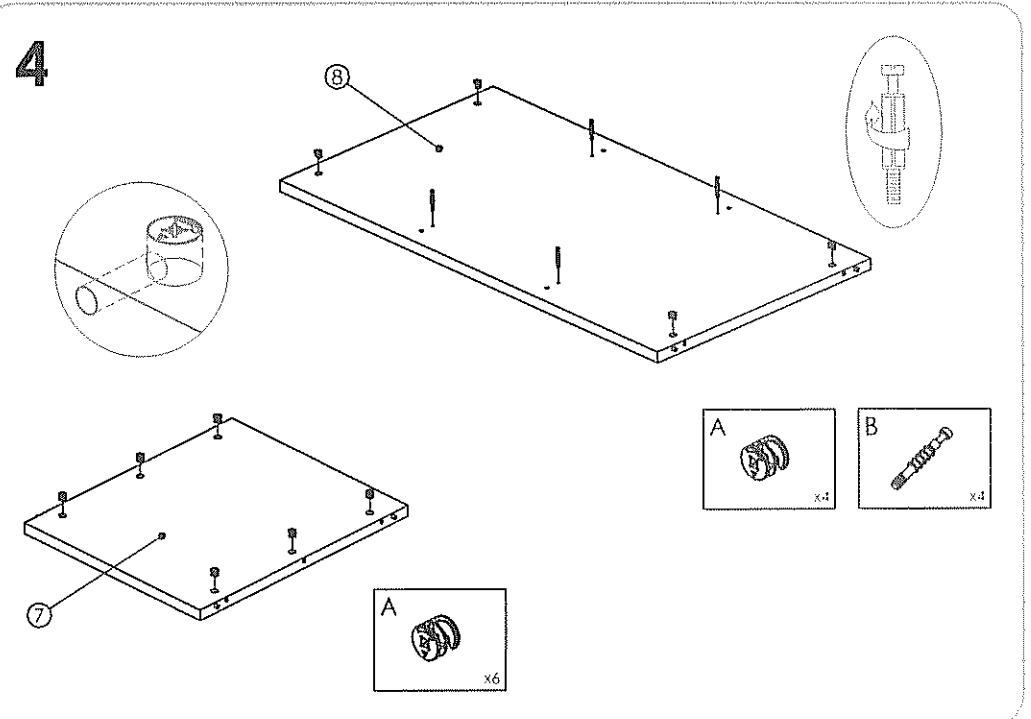
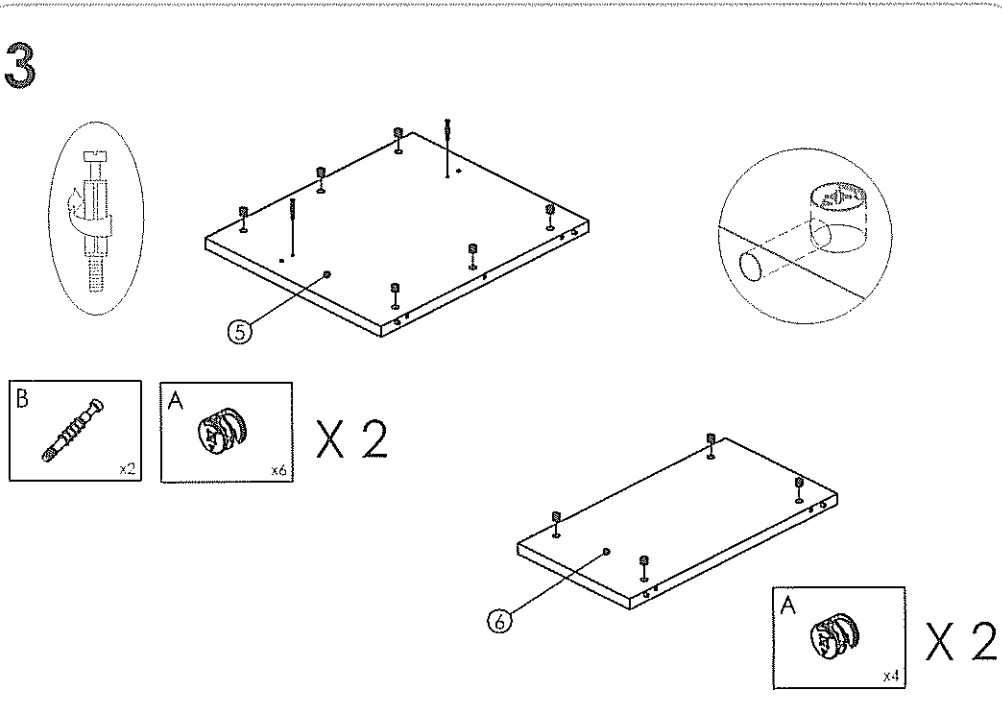
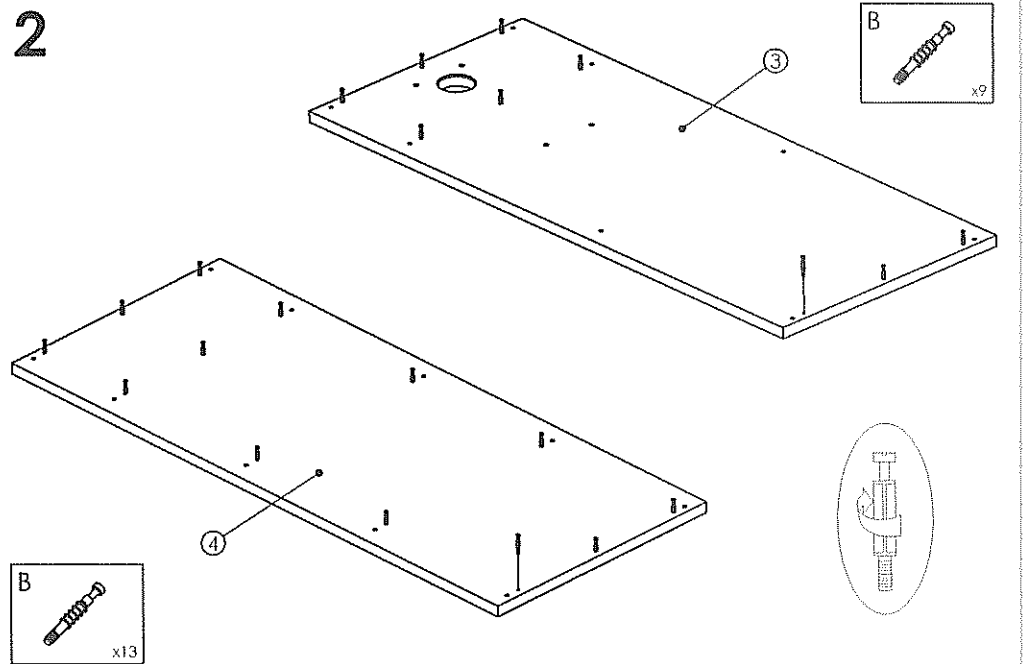
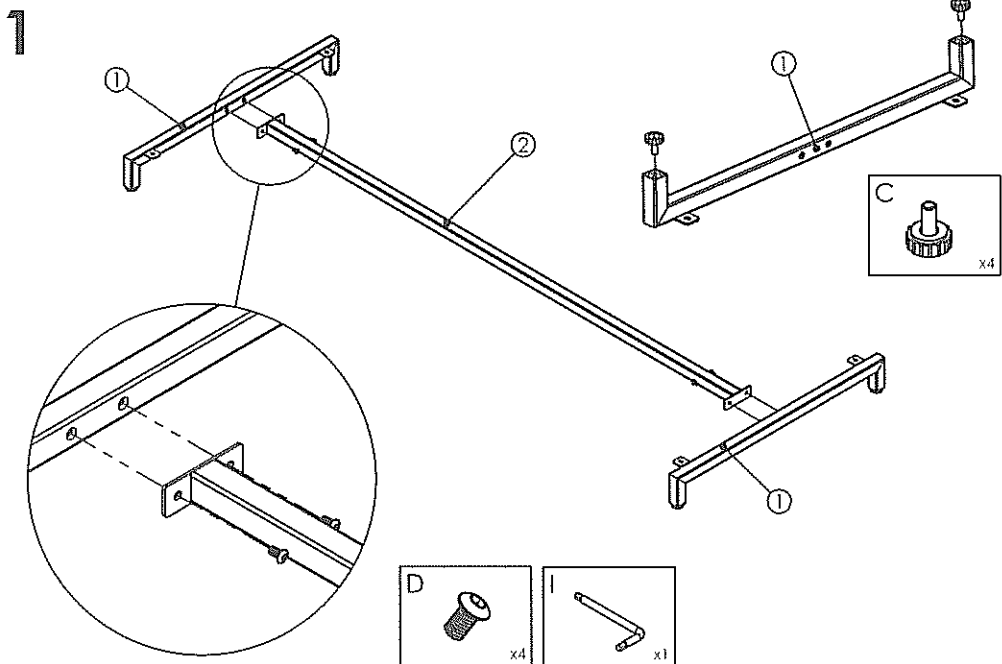
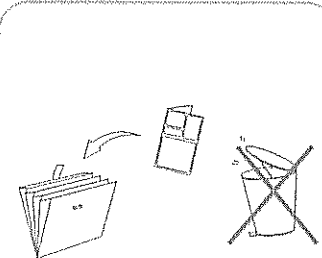
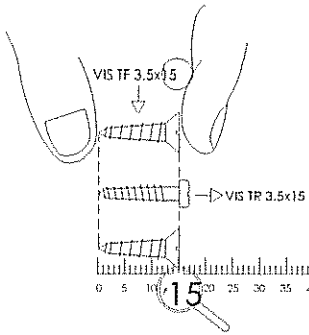

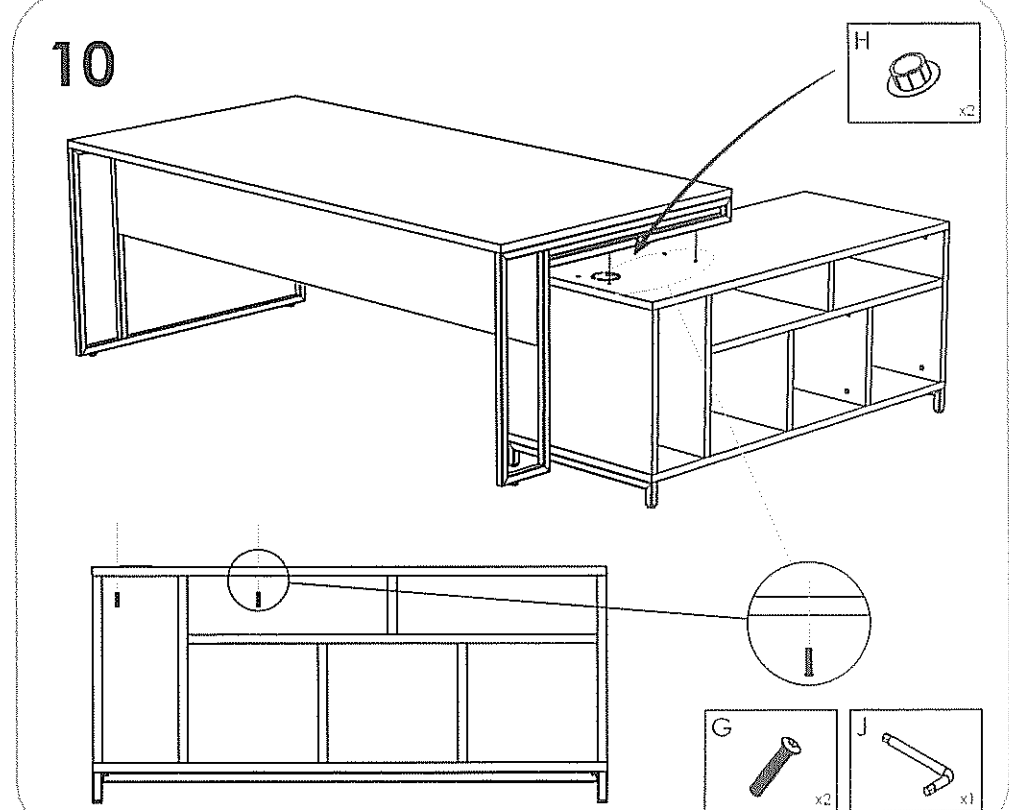
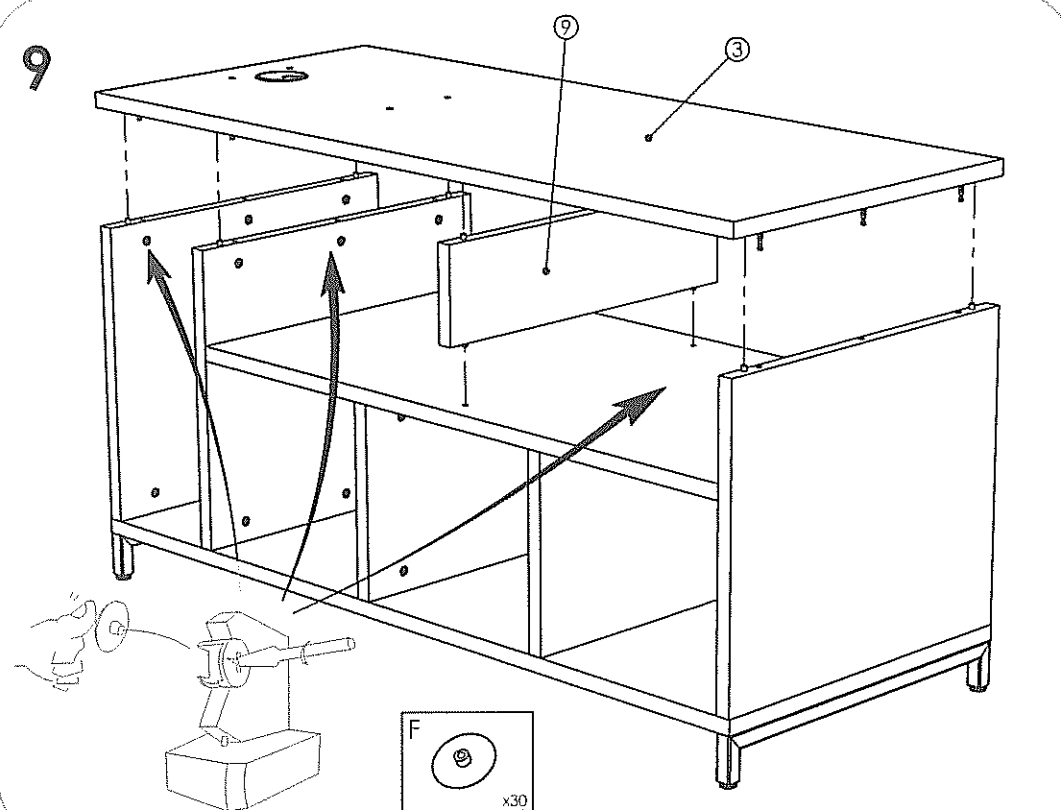
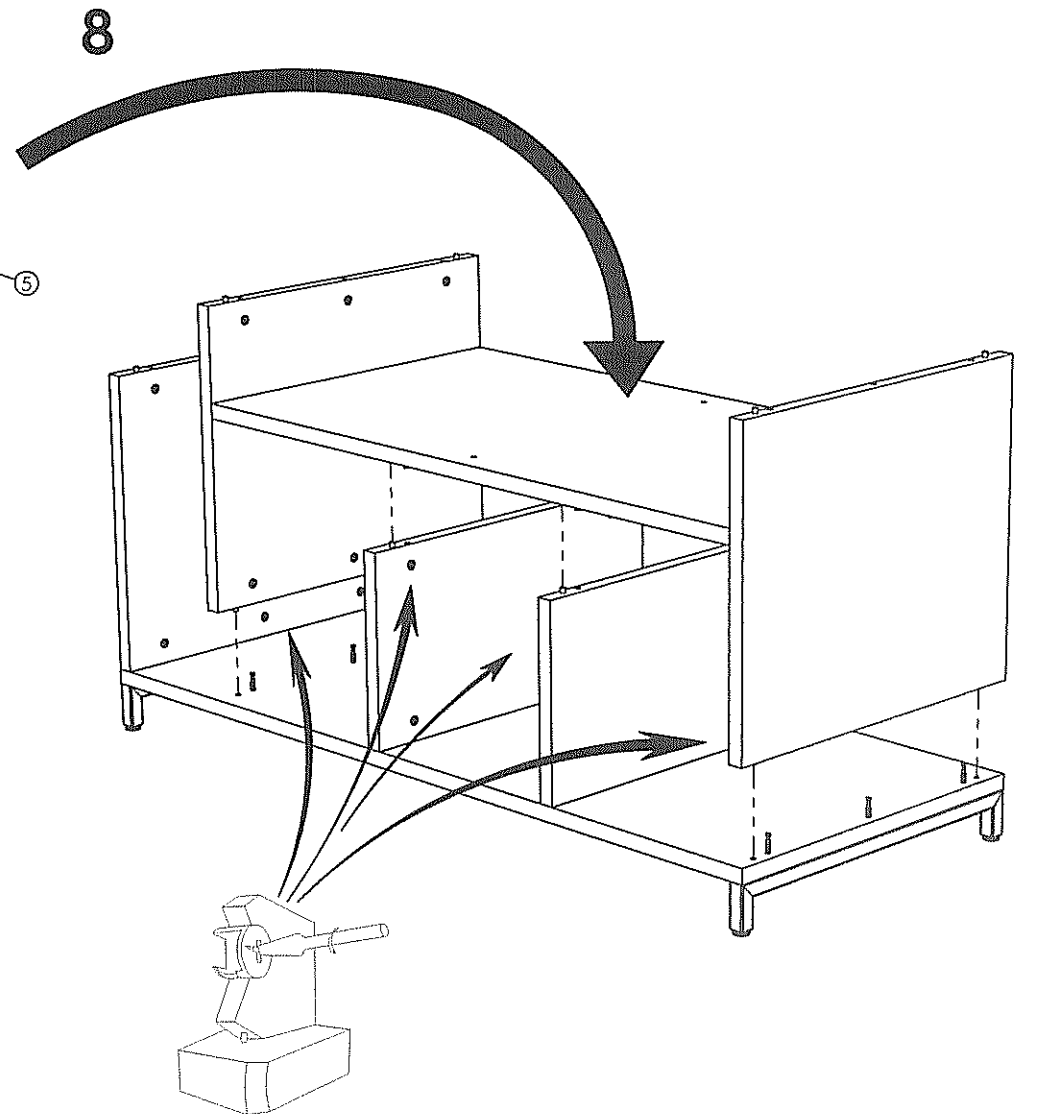
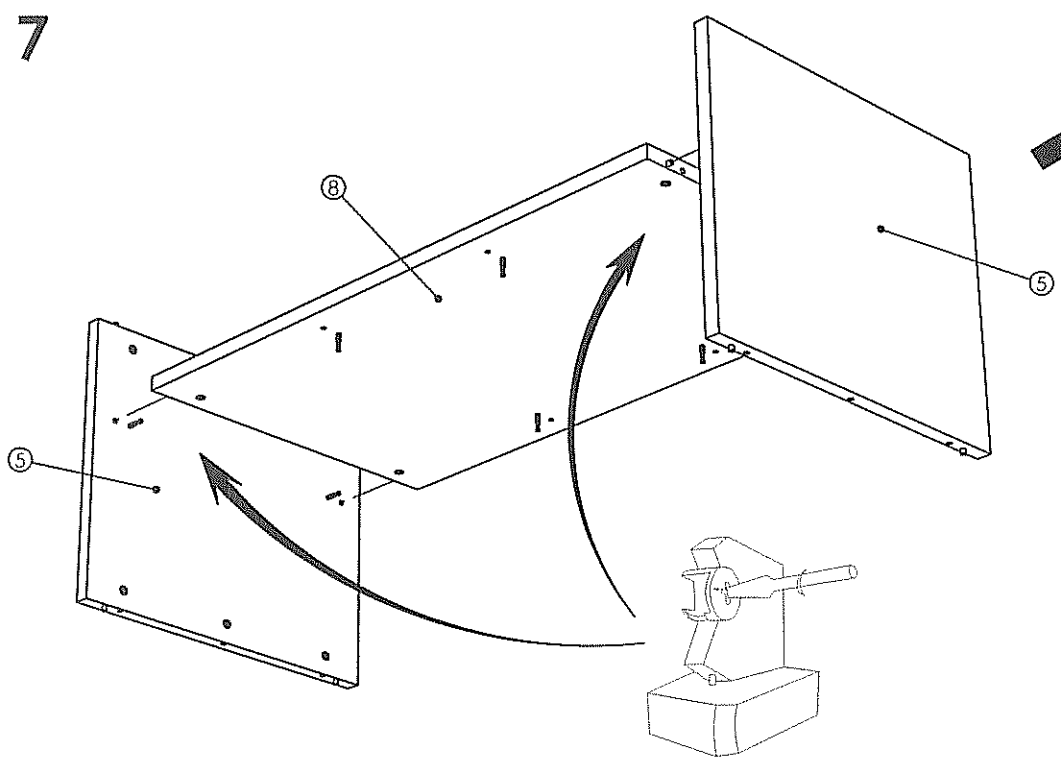
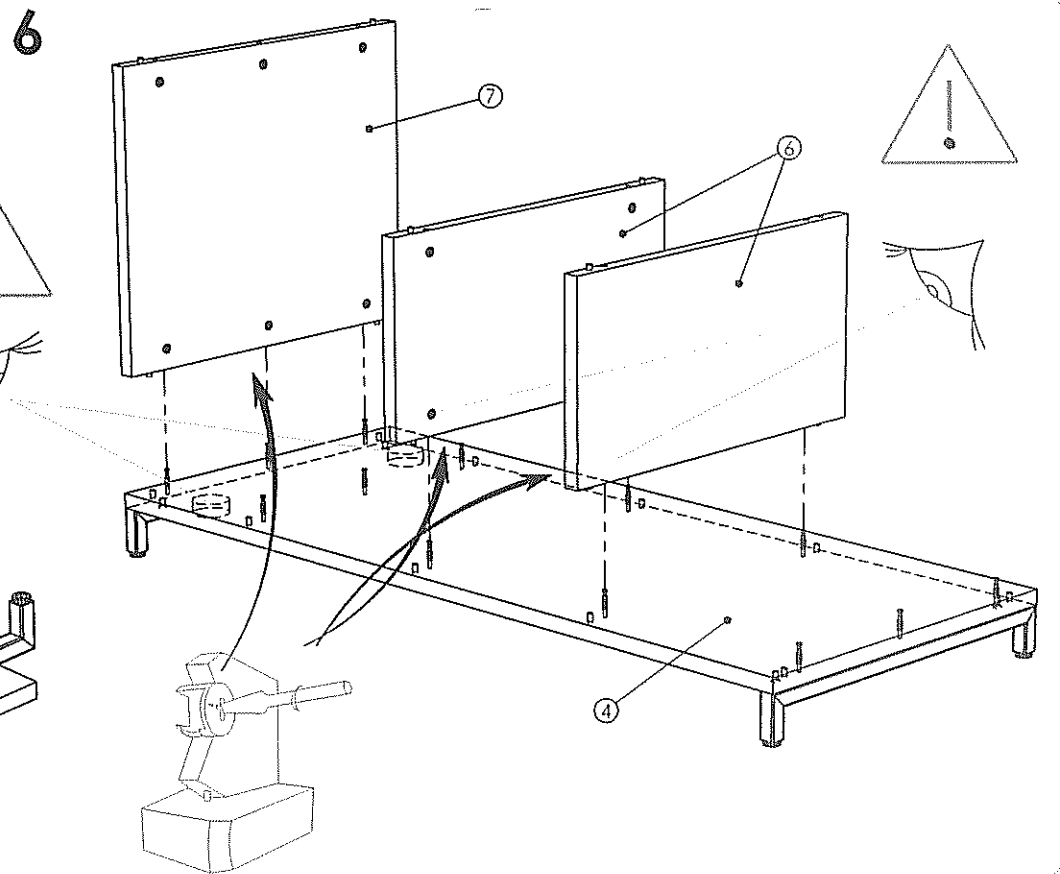
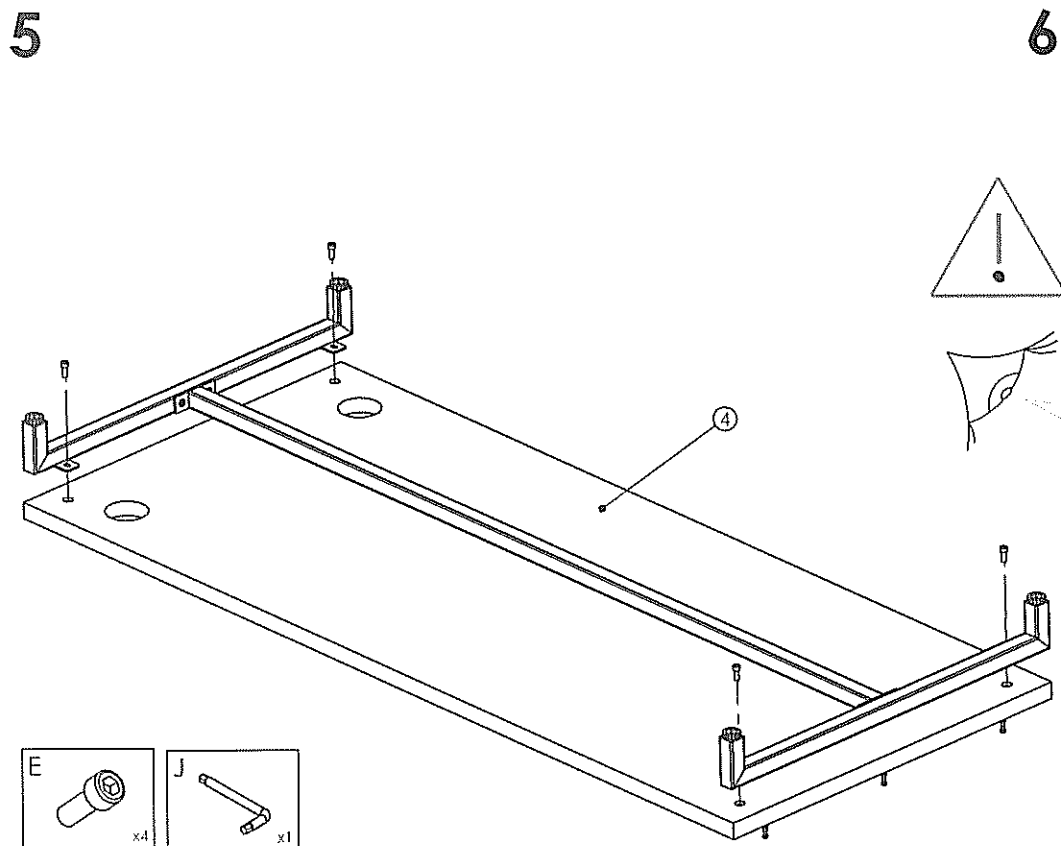

NOTICE DE MONTAGE
INSTRUCTIONS FOR ASSEMBLY
MONTAGEANLEITUNG
GEBRUIKSAANWIJZING
ISTRUZIONI DI MONTAGGIO
INSTRUCCIONES DE MONTAJE
INSTRUCOES DE MONTAGEM

buronomic

N° DV40720

CONCEPTION ET REALISATION BUREAU D'ETUDES BURONOMIC

GARANTIE (vises cachés)
_ Réference produit à nous communiquer impérativement en cas de litige :
Voir étiquette apposée au dos du produit

GARANTEE (vises cachés)
_ In the event of complaint, it is essential to mention the product reference :
See label affixed to the back of the product.

GARANTIE (vises cachés)
_ Im s'reitfall sit uns die produktreferenz mitzuteilen :
Siehe etikett auf produkttrucksseite.

WAARBORG (vises cachés)
_ Vermeld in geval van klachten altijd het productnummer :
Zie label op de achterzijde van het product

GARANZIA (vises cachés)
_ Specificare obbligatoriamente il riferimento prodotto in caso di contestazioni :
Si veda l'etichetta applicata dietro il prodotto

GARANTIA (vises cachés)
_ Referencia de producto citese obligatoriamente en caso de reclamacion :
Ver etiqueta en la parte posterior del producto.

GARANTIA (vises cachés)
_ Em caso de reclamacao indiqu-nos imperativamente a referencia do produto :
Ver etiqueta fixada na parte posterior do produto

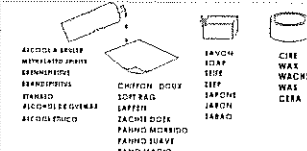
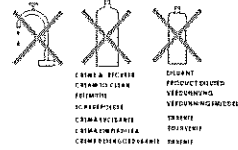
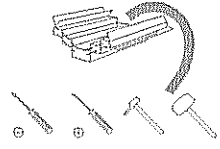
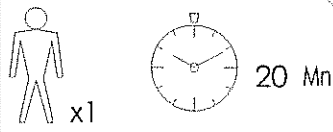
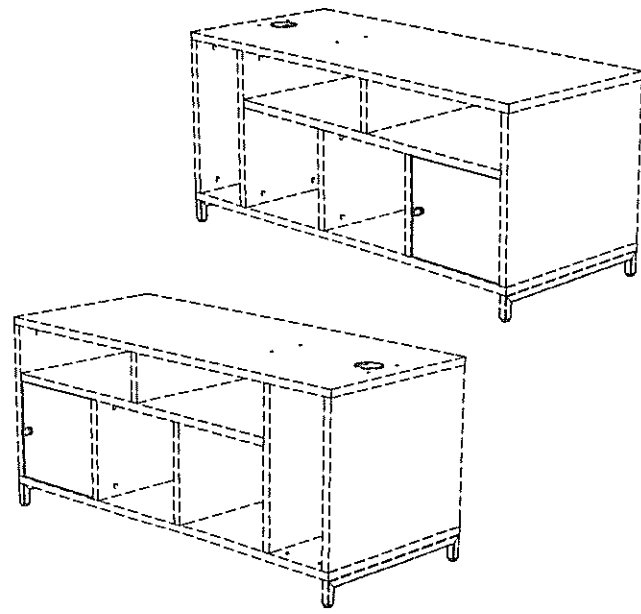
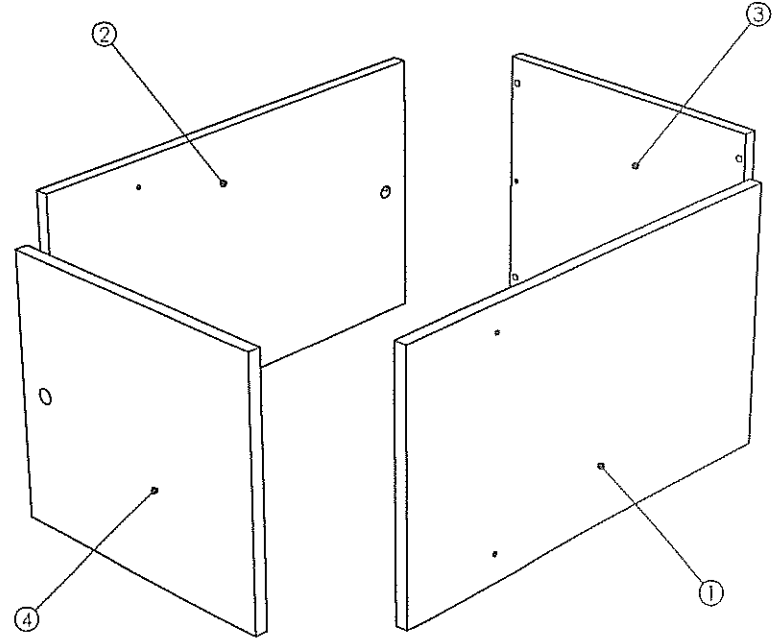

NOMENCLATURE
(Parts list)
(Stückliste)
(Onderdelenlijst)
(Nomenclatura)
(Lista de peças)

Rep.	Pièce	Qté
1	COTE CHARNIERES	1
2	COTE GACHE	1
3	PAR	1
4	PORTE	1

QUINCAILLERIE
(Hardware)
(Beschläge)
(Ijzerwaren)
(Ferramenta)
(Herrajes)
(Quinquilharia)

Rep.	Pièce	Qté
A	Charniere	2
B	Serrure	1
C	Vis TF 3x20	2
D	Cale charnière	2
E	GACHE Tôle	1
F	VIS EURO Std	2
G	Vis TR 3x13	1
H	Excentrique Ø15	2
I	Goujon bois	2
J	Vis 4x30	4
K	Cache exent.	2

AIDE

HELP
HILFE
HULP
AYUDA
AJUDA
AIUTO

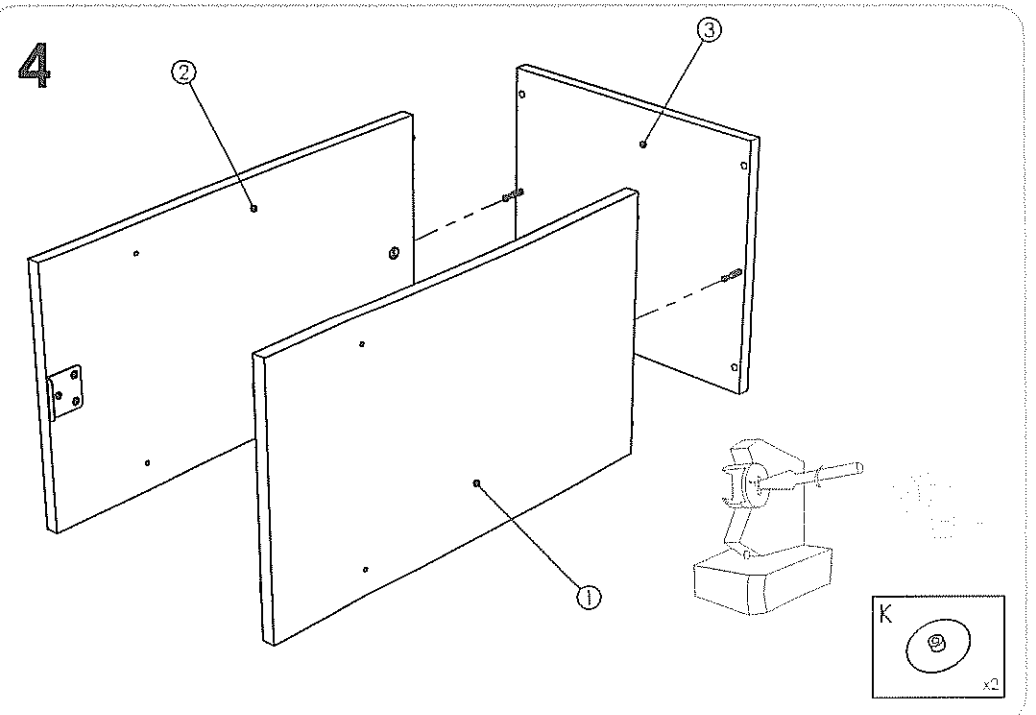
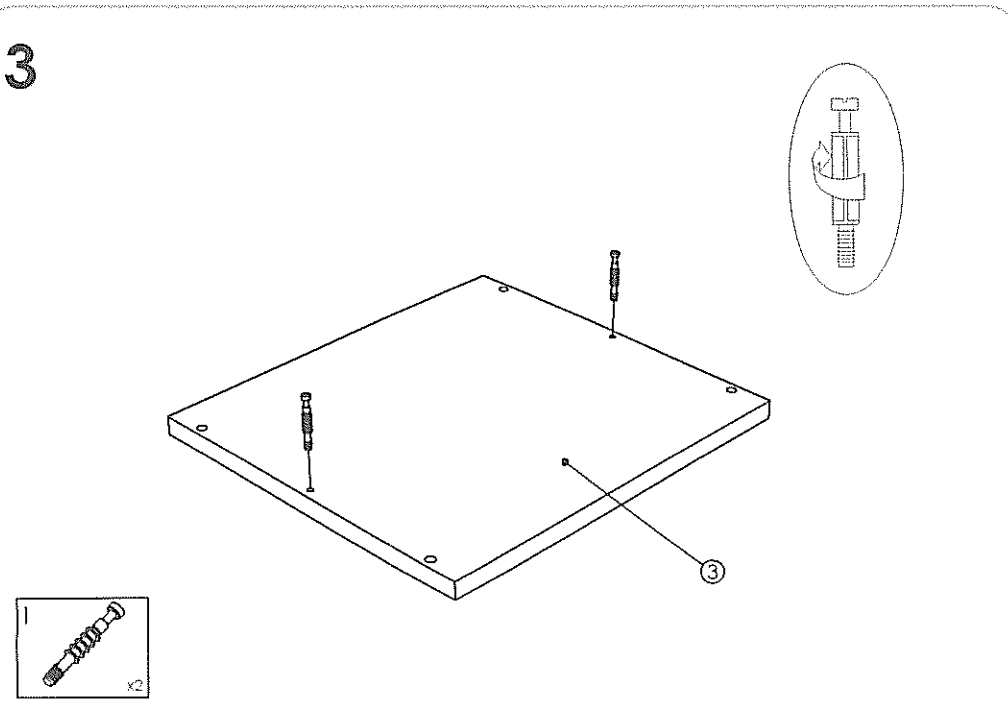
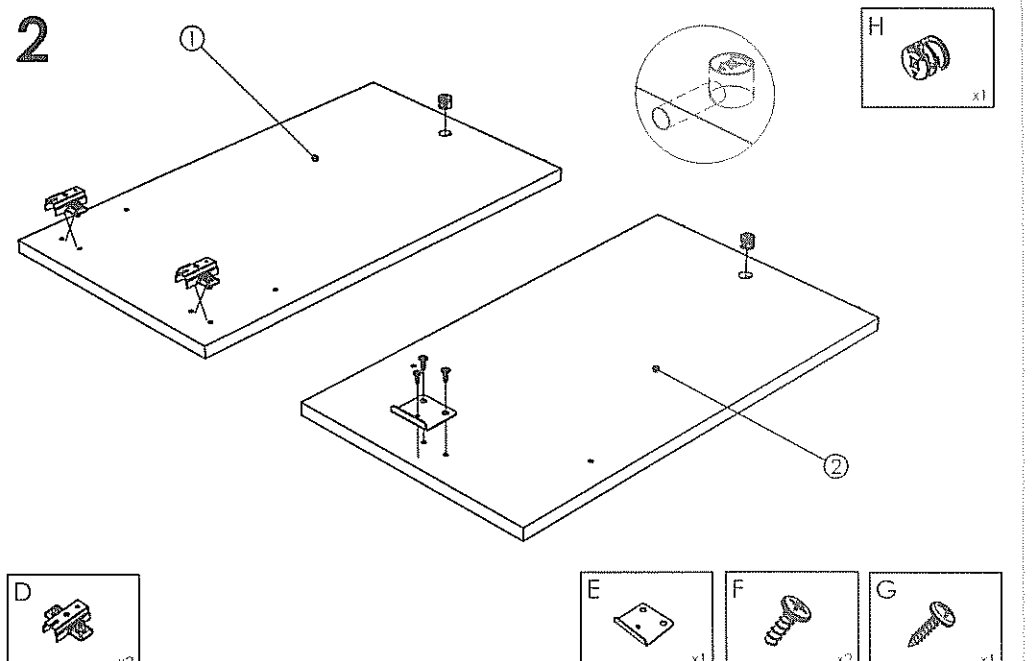
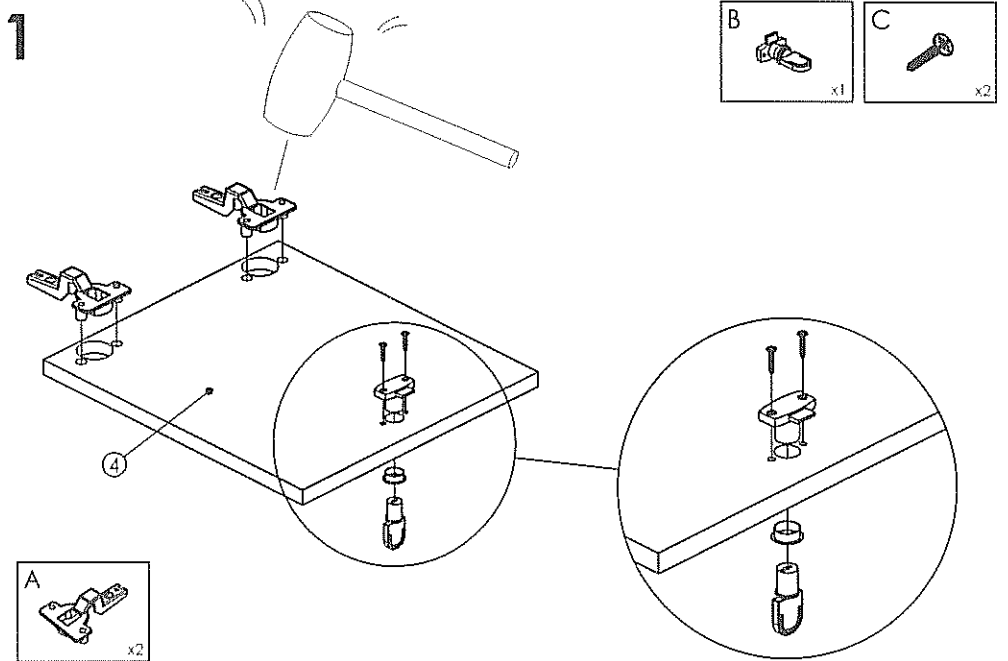
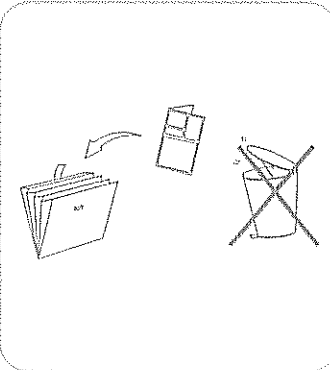
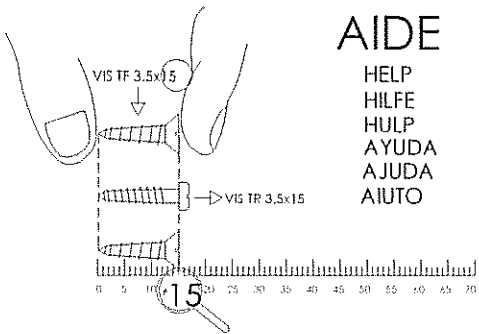

5

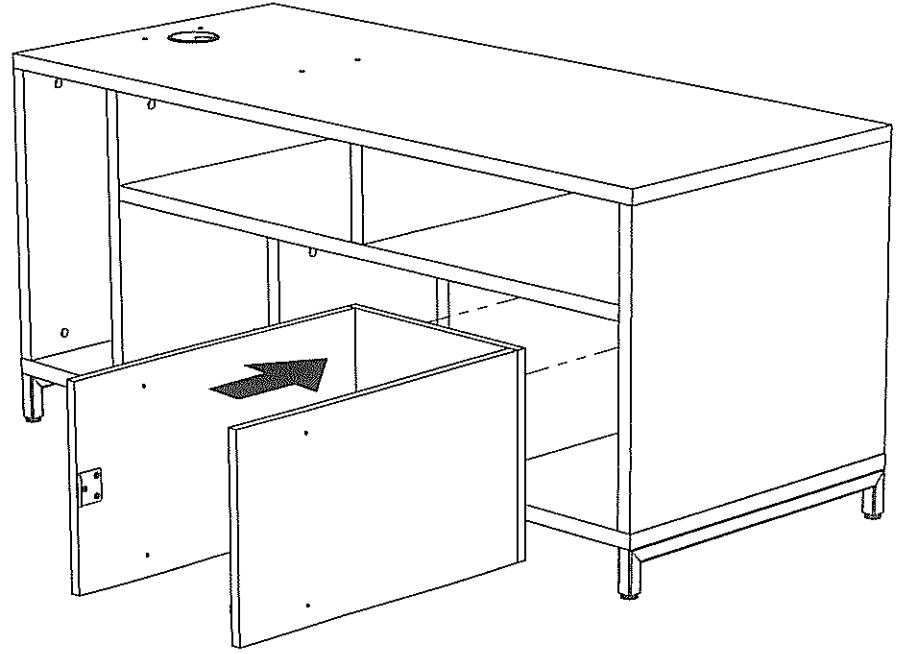
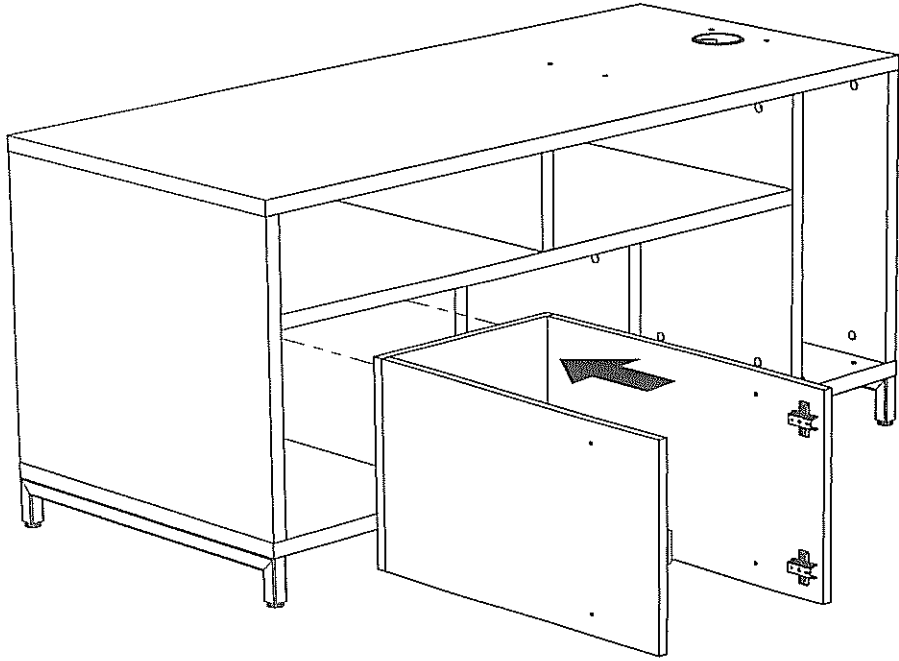

6

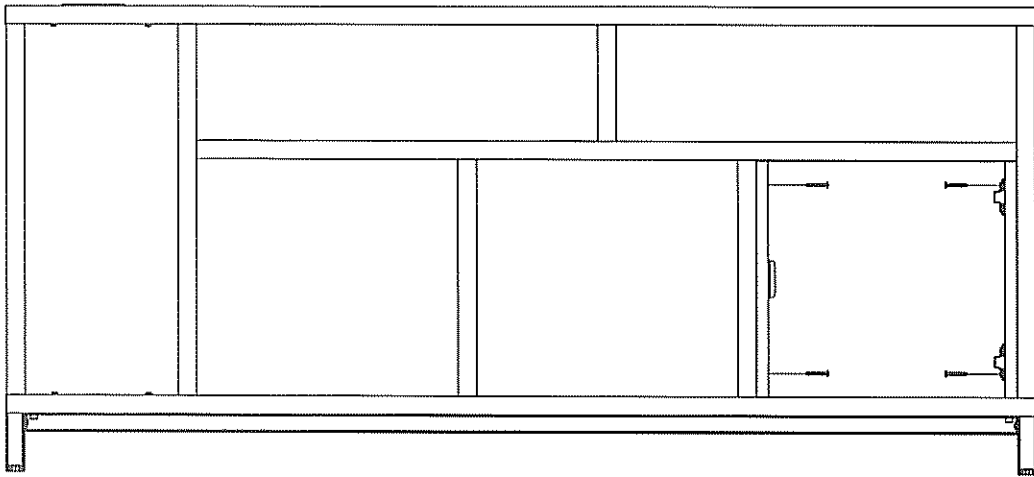
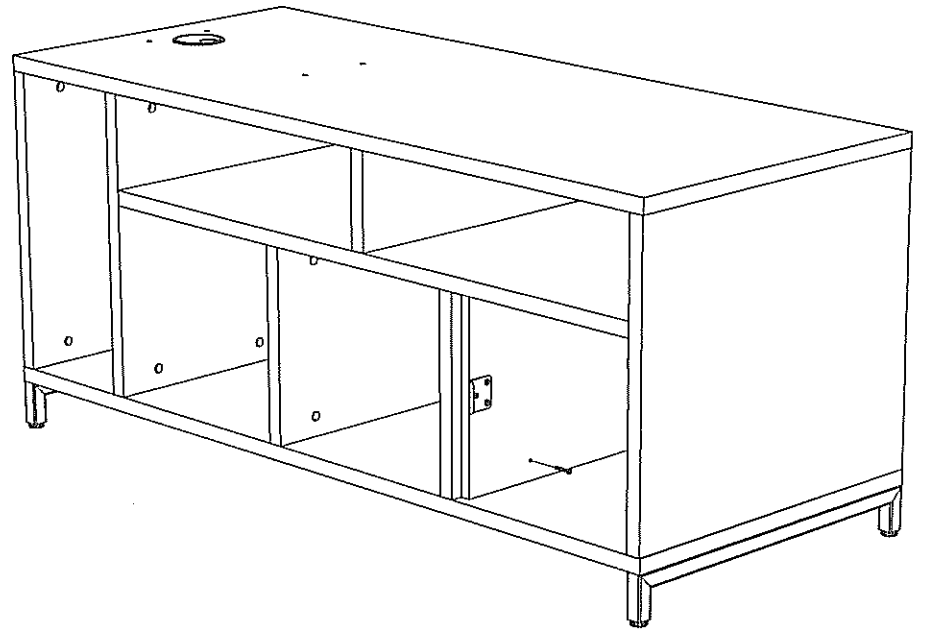
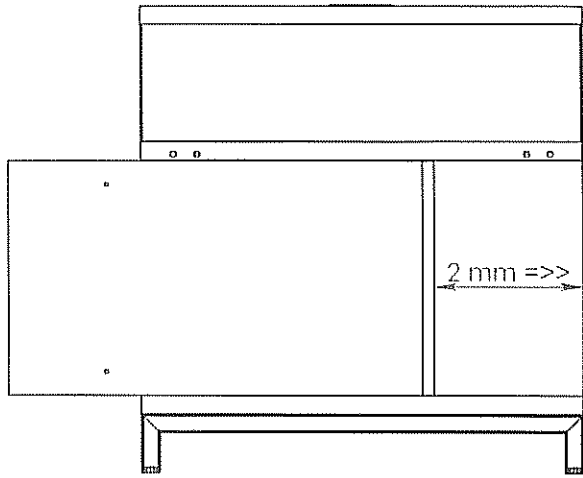

7

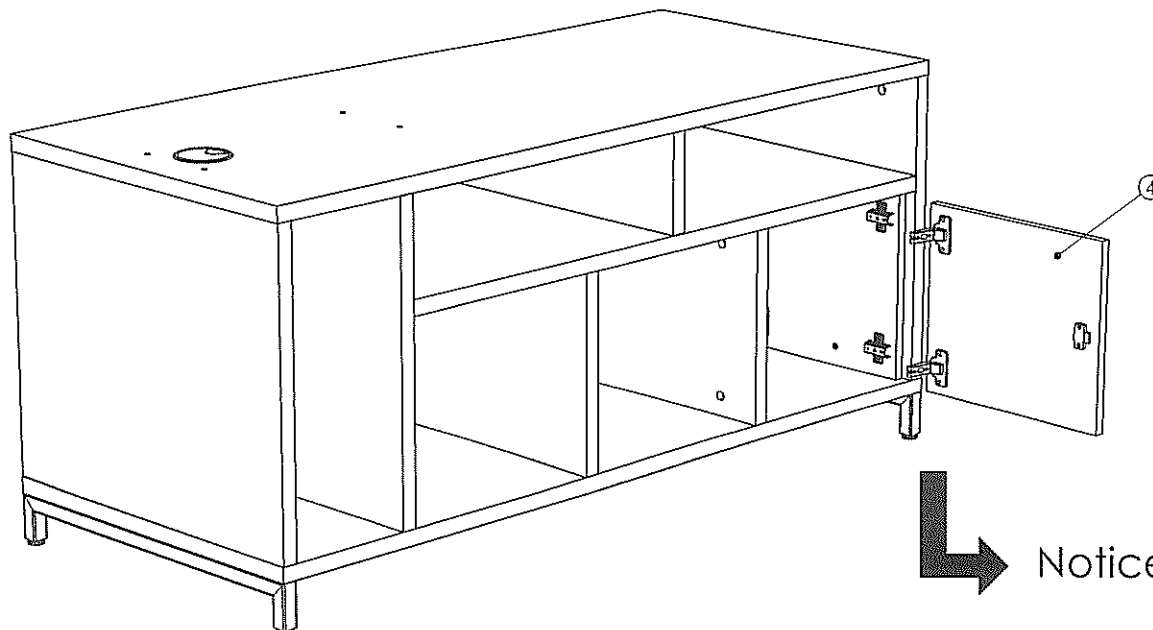

Notice DV40554

NOTICE DE MONTAGE
INSTRUCTIONS FOR ASSEMBLY
MONTAGEANLEITUNG
GEBRUIKSAANWIJZING
ISTRUZIONI DI MONTAGGIO
INSTRUCCIONES DE MONTAJE
INSTRUCCOES DE MONTAGEM

buronomic

N° DV40721

CONCEPTION ET REALISATION BUREAU DESIGN BURONOMIC

- GARANTIE** (voornachem)
_ Référence produit à nous communiquer impérativement en cas de litige :
Voir étiquette apposée au dos du produit
- GARANTEE** (dekkat)
_ In the event of complaint, it is essential to mention the product reference :
See label affixed to the back of the product.
- GARANTIE** (fabrikgarantien)
_ Im streitfall sit uns die produktreferenz mitzuteilen :
Siehe etikett auf produktdruckseite.
- WAARBORG** (de wettiggen gadekens)
_ Vermeld in geval van klachten altijd het productnummer :
Zie label op de achterzijde van het product
- GARANZIA** (vizi oculto)
_ Specificare obbligatoriamente il riferimento prodotto in caso di contestazioni :
Si veda l'etichetta applicata dietro il prodotto
- GARANTIA** (fabrieksgarantie)
_ Referencia de producto citese obligatoriamente en caso de reclamacion :
Ver etiqueta en la parte posterior del producto.
- GARANTIA** (vizio oculto)
_ Em caso de reclamação indiqu-nos imperativamente a referência do produto :
Ver etiqueta fixada na parte posterior do produto

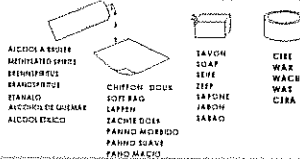
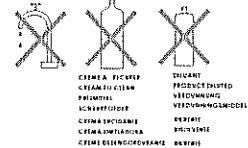
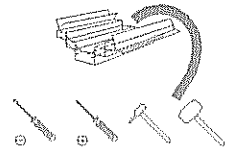
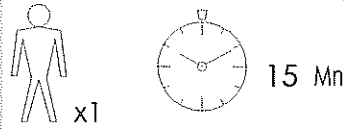
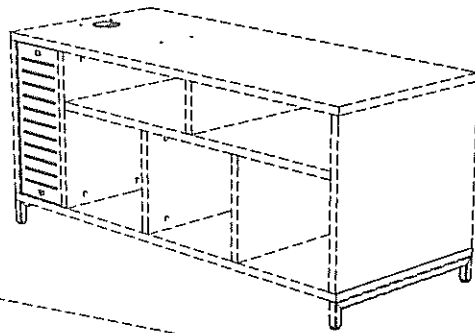
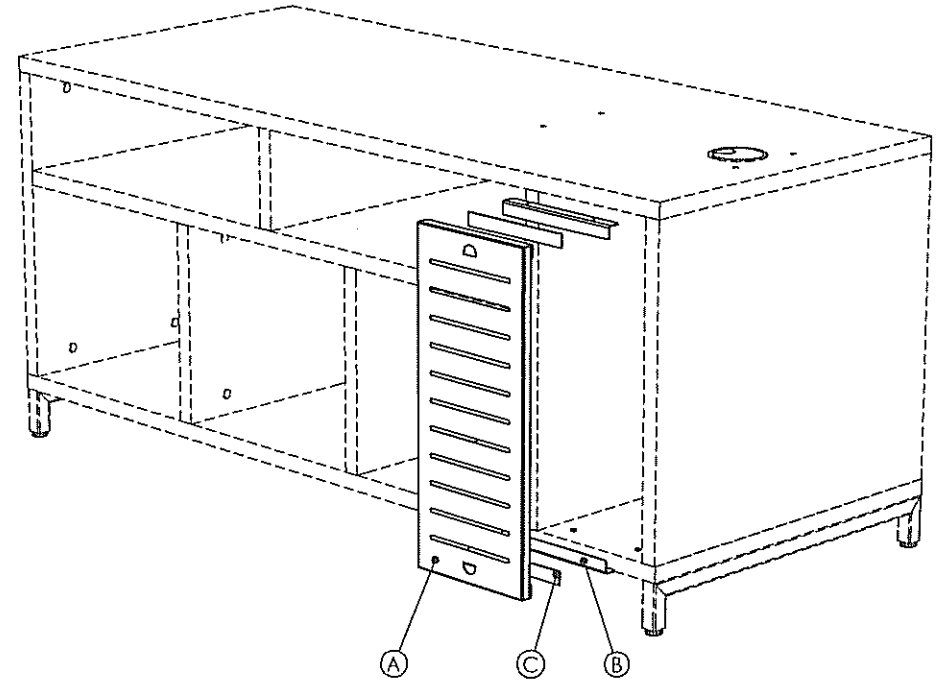

AIGUILLON A VISSES
SCHROEFDRIJVER
BREMENSCHROEF
BRANDSCHROEF
STAVNAG
ALICATOR DE CUSUMAR
ALICATOR DE CUSUMAR

CHIFFON DOUX
SOFT RAG
LAPPEN
ZACNETE DOEK
PANIÑO MOYERDOO
PANIÑO SAKAR
FANS MACEIO

TAVON
SCAP
SEIFE
ZEPF
TAFONE
JABON
SABAO

CIRE
WAX
WACHS
WAS
CERA

NOMENCLATURE

(Parts list)
(Stückliste)
(Onderdelenlijst)
(Nomenclatura)
(Lista de peças)

QUINCAILLERIE

(Hardware)
(Beschläge)
(Izervaren)
(Ferramentas)
(Herrajes)
(Quinquilharia)

Rep.	Pièce	Qté
A	GRILLE AERATION	1
B	EQUERRE MAGNETIQUE	2
C	Magnétique	2
D	Vis TR 3,5x15	4

A	B	C
D	E	F
G	H	I
J	K	L
M	N	O
P	Q	R

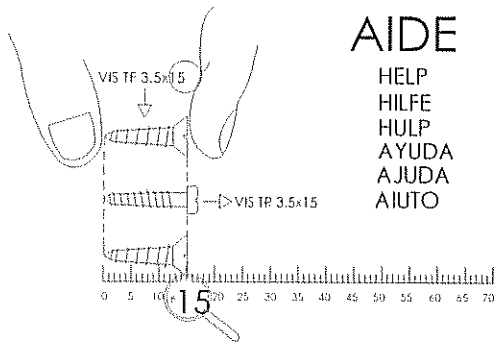

AIDE

HELP
HILFE
HULP
AYUDA
AJUDA
AIUTO

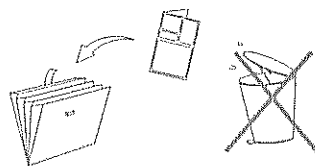

1

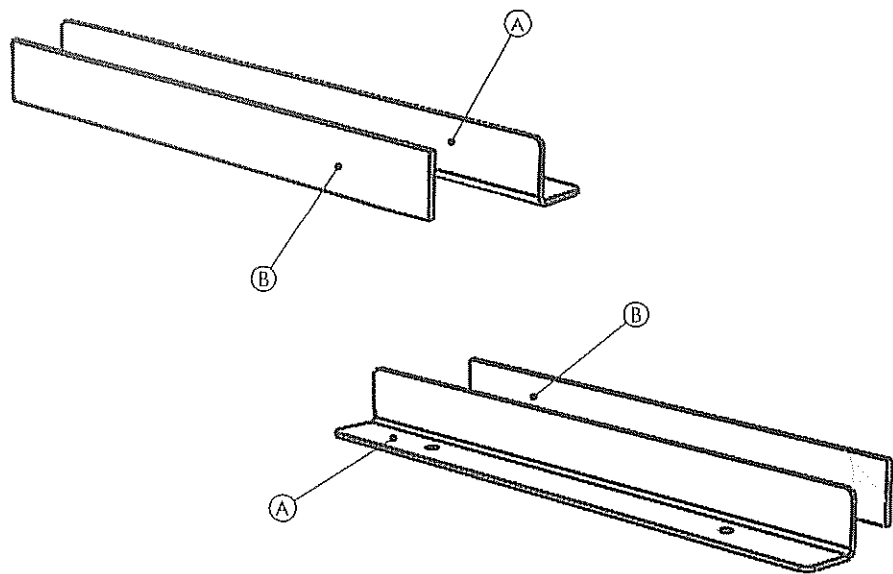

2

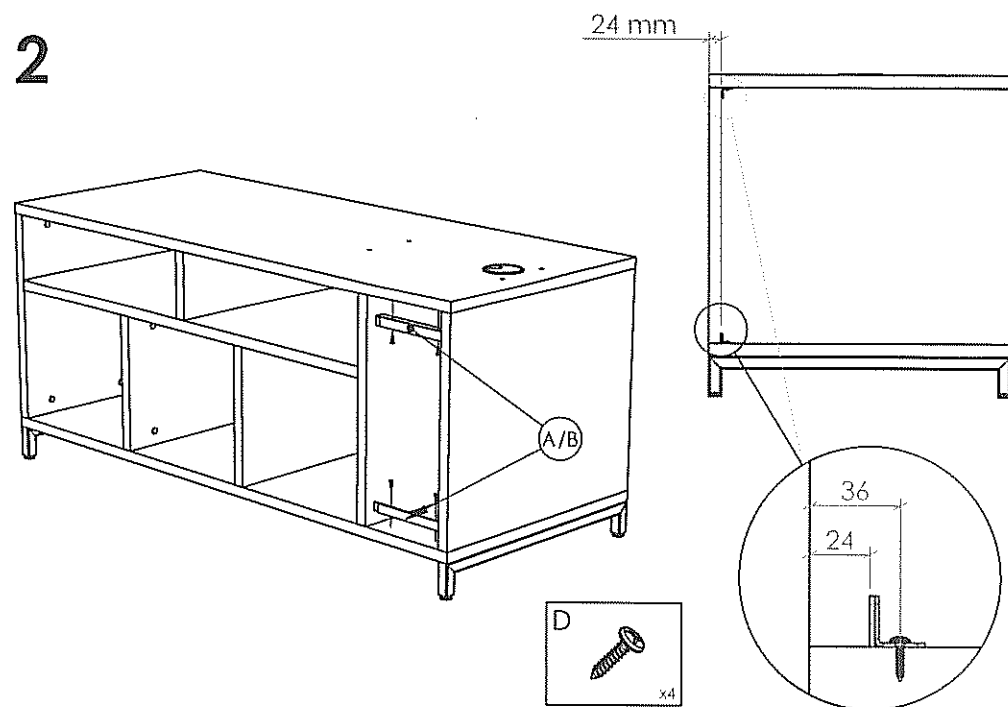

3

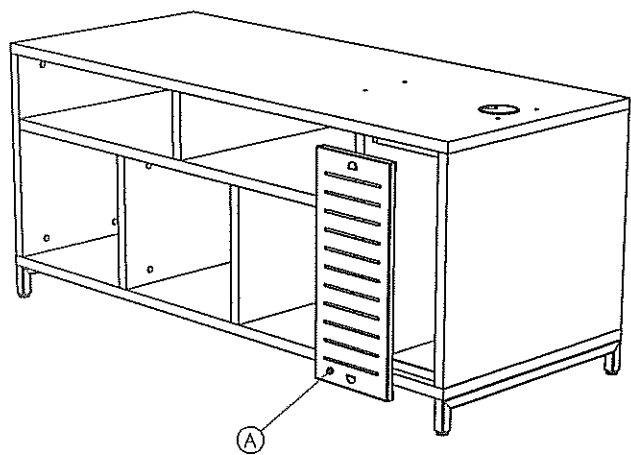

4

