

NOTICE DE MONTAGE  
INSTRUCTIONS FOR ASSEMBLY  
MONTAGEANLEITUNG  
GEBRUIKSAANWIJZING  
ISTRUZIONI DI MONTAGGIO  
INSTRUCCIONES DE MONTAJE  
INSTRUCCOES DE MONTAGEM

**buromomic**  
FABRICANT FRANÇAIS

N° DV40876

CONCEPTION ET REALISATION BUREAU D'ETUDES BUROMOMIC

**GARANTIE** (vices cachés)  
\_ Référence produit à nous communiquer impérativement en cas de litige :  
Voir étiquette apposée au dos du produit

**GARANTEE** (defekt)  
\_ In the event of complaint, it is essential to mention the product reference :  
See label affixed to the back of the product.

**GARANTIE** (fabrikationfelher)  
\_ Im streitfall sit uns die produktreferenz mitzuteilen :  
Siehe etikett auf produktruckseite.

**WAARBORG** (de verborgen gebreken)  
\_ Vermeld in geval van klachten altijd het productnummer :  
Zie label op de achterzijde van het product

**GARANZIA** (vizi occulti)  
\_ Specificare obbligatoriamente il riferimento prodotto in caso di contestazioni :  
Si veda l'etichetta applicata dietro il prodotto

**GARANTIA** (defectos oculitos)  
\_ Referencia de producto citese obligatoriamente en caso de reclamacion :  
Ver etiqueta en la parte posterior del producto.

**GARANTIA** (vicios ocultos)  
\_ Em caso de reclamacao indiqu-nos imperativamente a referencia do produto :  
Ver etiqueta fixada na parte posterior do produto

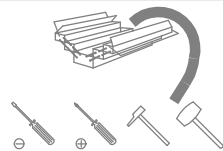
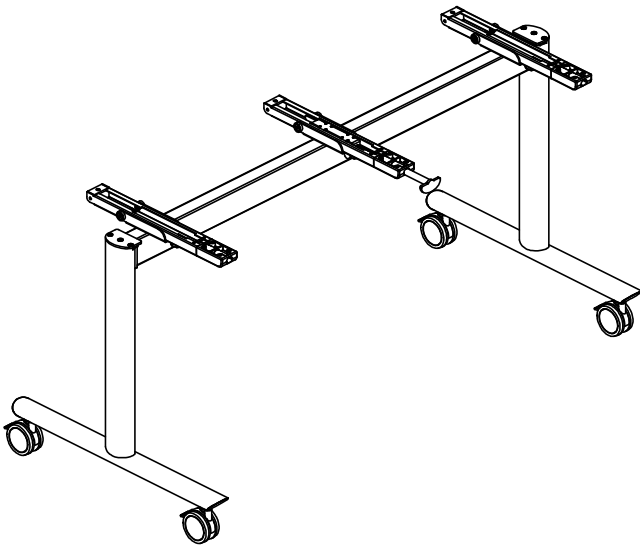

## AIDE

HELP  
HILFE  
HULP  
AYUDA  
AJUDA  
AIUTO

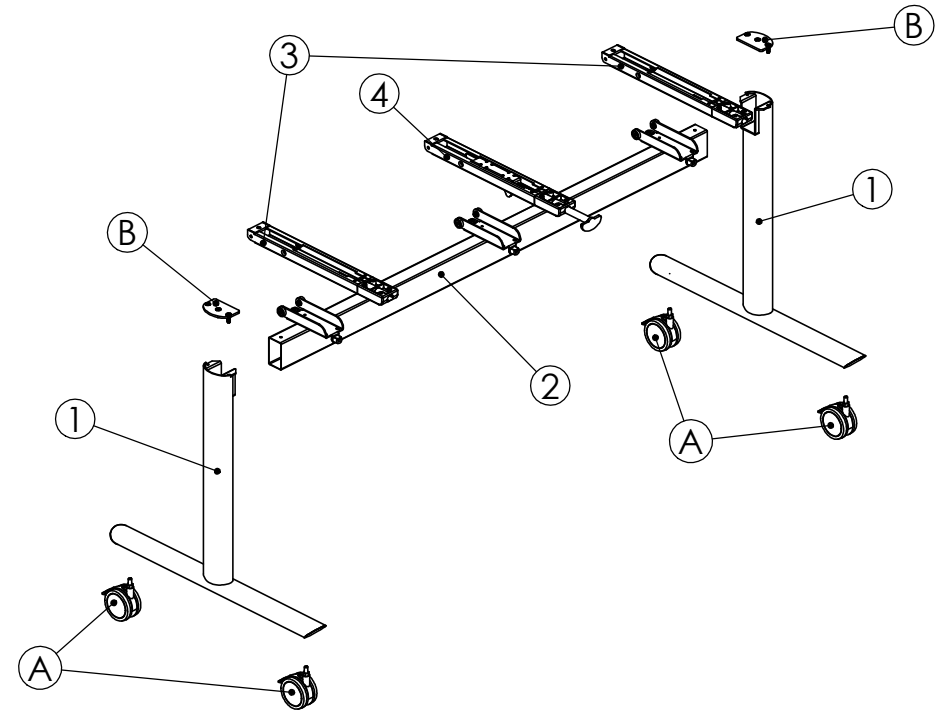
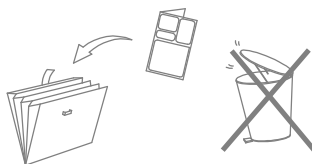
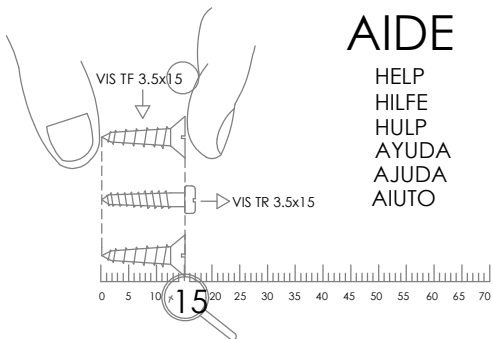

## NOMENCLATURE

(Parts list)  
(Stüçkliste)  
(Onderdelenlijst)  
(Nomenclatura)  
(Lista de peças)

Rep.	Pièce	Qté
1	PIETEMENT	2
2	POUTRE	1

Rep.	Pièce	Qté
3	ABATTANT	2
4	ABATTANT / POIGNEE	1

## QUINCAILLERIE

(Hardware)  
(Beschlüge)  
(Ijzerwaren)  
(Herrajes)  
(Quinilharia)

Rep.	Pièce	Qté	A	B	C
A	ROULETTE	4			
B	PLATINE de FIXATION	2			
C	VIS TFHC M6X20	6			
H	Clé 6 pans 5mm	1			
I	Clé 6 pans 4mm	1			
J	Clé PLATE 14	1			
Rep.	Pièce	Qté	J	K	L
D	ENTRETOISE	6			
E	VIS TFHC M8x16	6			
F	PLOT BUTEE	3			
G	VIS TB M4x10	3			
Rep.	Pièce	Qté	M	N	O
D	ENTRETOISE	6			
E	VIS TFHC M8x16	6			
F	PLOT BUTEE	3			
G	VIS TB M4x10	3			
Rep.	Pièce	Qté	P	Q	R
D	ENTRETOISE	6			
E	VIS TFHC M8x16	6			
F	PLOT BUTEE	3			
G	VIS TB M4x10	3			

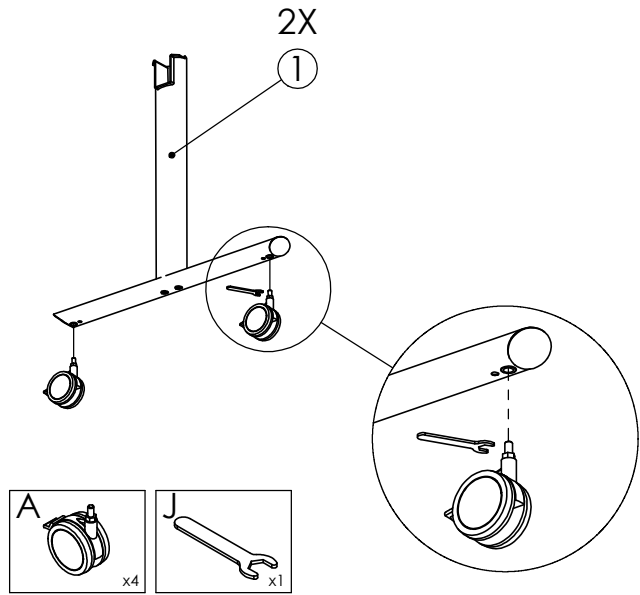
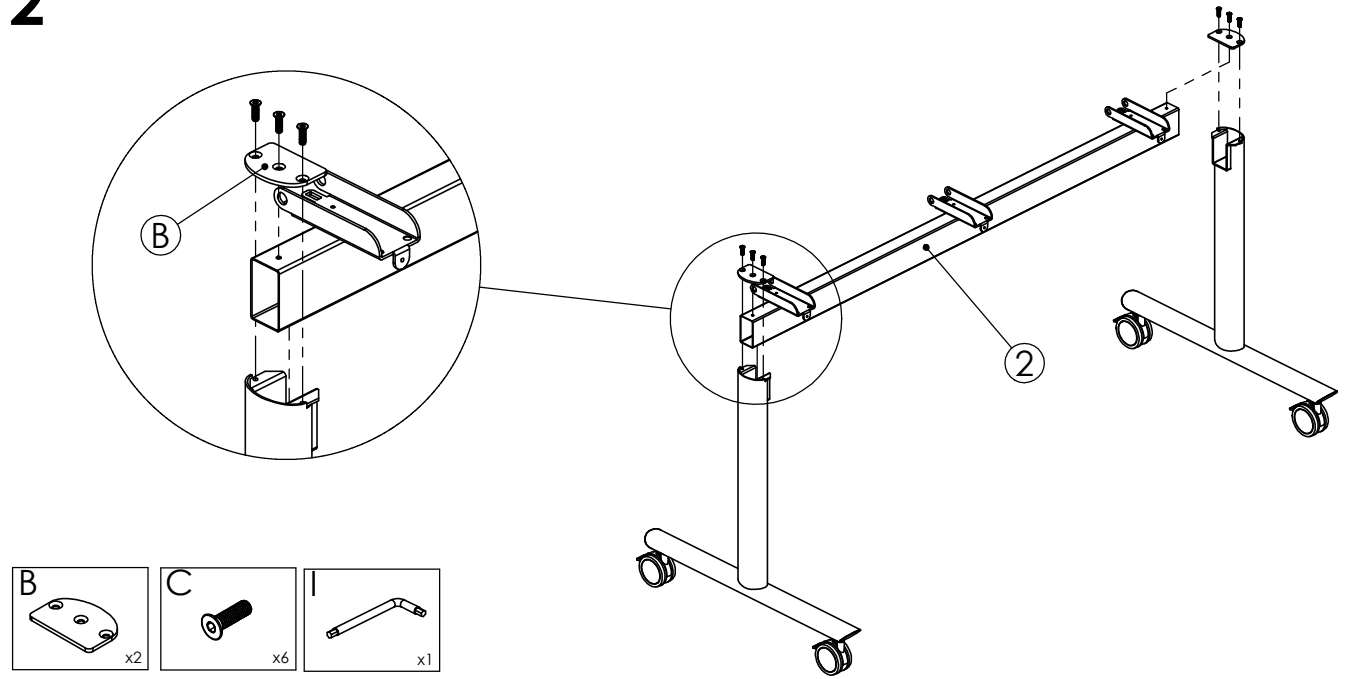
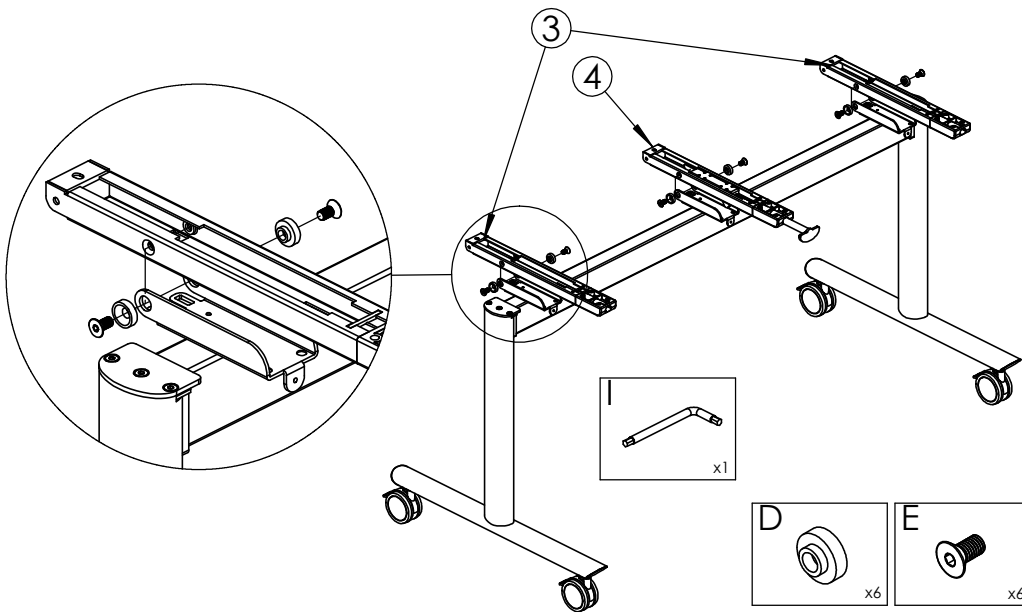
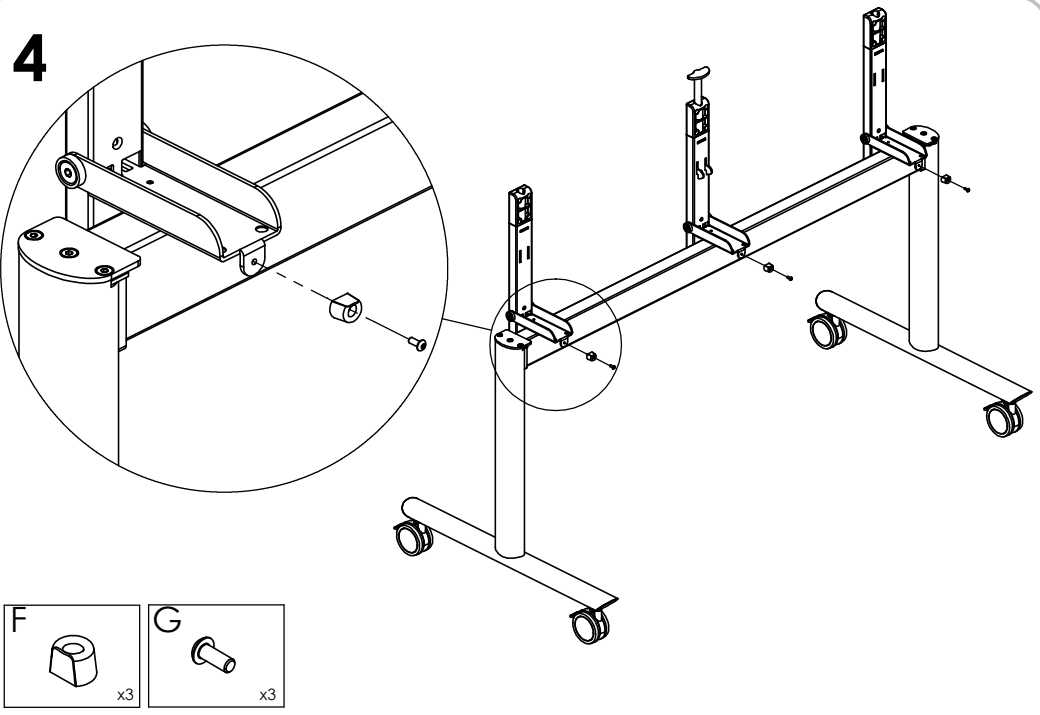
**1****2****3****4**

NOTICE DE MONTAGE  
INSTRUCTIONS FOR ASSEMBLY  
MONTAGEANLEITUNG  
GEBRUIKSAANWIJZING  
ISTRUZIONI DI MONTAGGIO  
INSTRUCCIONES DE MONTAJE  
INSTRUCCOES DE MONTAGEM

**buromomic**  
FABRICANT FRANÇAIS

N° DV40871

CONCEPTION ET REALISATION BUREAU D'ETUDES BUROMOMIC

**GARANTIE** (vices cachés)  
\_ Référence produit à nous communiquer impérativement en cas de litige :  
Voir étiquette apposée au dos du produit

**GARANTEE** (defekt)  
\_ In the event of complaint, it is essential to mention the product reference :  
See label affixed to the back of the product.

**GARANTIE** (fabrikationfelher)  
\_ Im streitfall sit uns die produktreferenz mitzuteilen :  
Siehe etikett auf produktruckseite.

**WAARBORG** (de verborgen gebreken)  
\_ Vermeld in geval van klachten altijd het productnummer :  
Zie label op de achterzijde van het product

**GARANZIA** (vizi occulti)  
\_ Specificare obbligatoriamente il riferimento prodotto in caso di contestazioni :  
Si veda l'etichetta applicata dietro il prodotto

**GARANTIA** (defectos oculitos)  
\_ Referencia de producto citese obligatoriamente en caso de reclamacion :  
Ver etiqueta en la parte posterior del producto.

**GARANTIA** (vicios ocultos)  
\_ Em caso de reclamacao indigu-nos imperativamente a referencia do produto :  
Ver etiqueta fixada na parte posterior do produto

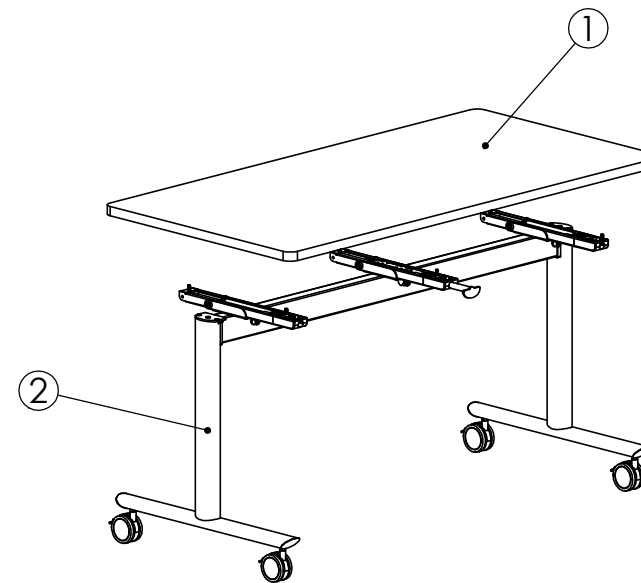
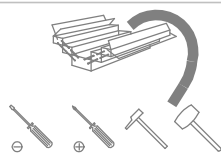
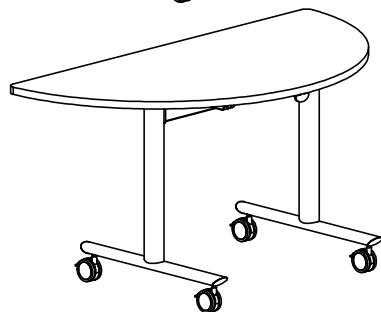
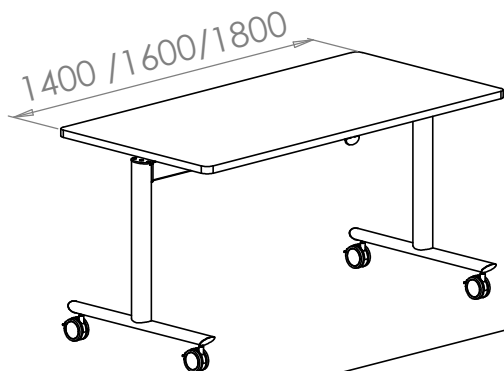

**NOMENCLATURE** (Parts list)  
(Stückliste)  
(Onderdelenlijst)  
(Nomenclatura)  
(Lista de peças)

Rep.	Pièce	Qté
1	PLATEAU	1
2	Structure Table	1

**QUINCAILLERIE** (Hardware)  
(Beschlüge)  
(Ijzerwaren)  
(Ferramentas)  
(Herrajes)  
(Quinquilharia)

Rep.	Pièce	Qté	A	B	C
A	VIS TBHc M6x16	3			
B	VIS TBHc M6x30	6	D	E	F
C	Clé 6 pans 4mm	1			

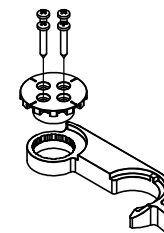

**AIDE**

HELP  
HILFE  
HULP  
AYUDA  
AJUDA  
AIUTO

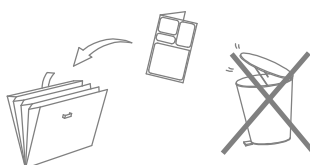
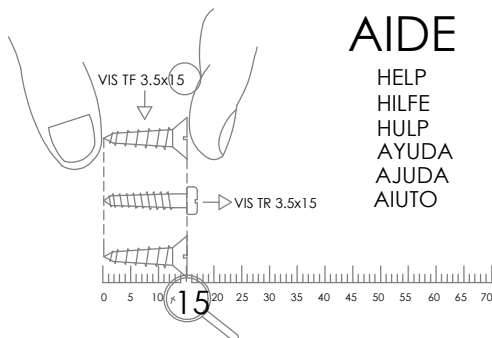

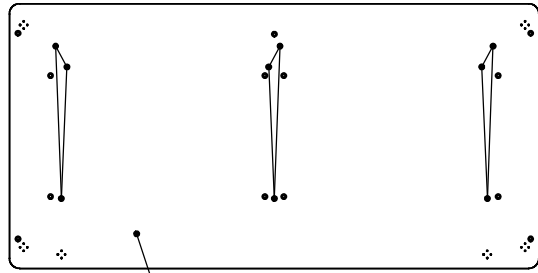
**1**

①

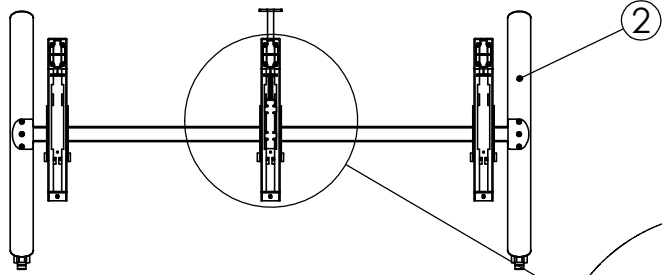

②

B

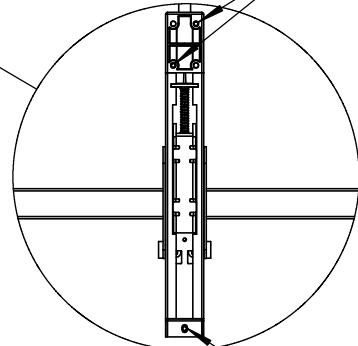

A

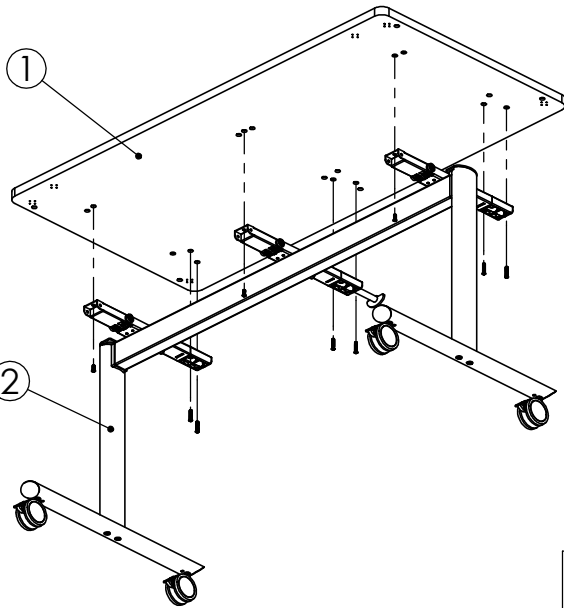

①

②

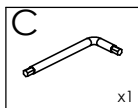
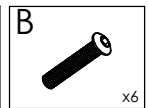
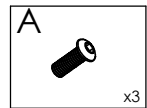
**2**