

NOTICE DE MONTAGE
INSTRUCTIONS FOR ASSEMBLY
MONTAGEANLEITUNG
GEBRUIKSAANWIJZING
ISTRUZIONI DI MONTAGGIO
INSTRUCCIONES DE MONTAJE
INSTRUÇÕES DE MONTAGEM

buronomic
FABRICANT FRANÇAIS

N° DV40826/03

CONCEPTION ET REALISATION BUREAU D'ETUDES BURONOMIC

GARANTIE (vices cachés)
Référence produit à nous communiquer impérativement en cas de litige :
Voir étiquette apposée au dos du produit

GARANTEE (defekt)
In the event of complaint, it is essential to mention the product reference :
See label affixed to the back of the product.

GARANTIE (fabrikationsfeil)
Im streifall sit uns die produktreferenz mitzuteilen :
Siehe etikett auf produckruckseite.

WAARBORG (de verborgen gebreken)
Vermeld in geval van klachten altijd het productnummer :
Zie label op de achterzijde van het product

GARANZIA (vizi occulti)
Specificare obbligatoriamente il riferimento prodotto in caso di contestazioni :
Si veda l'etichetta applicata dietro il prodotto

GARANTIA (defectos ocultos)
Referencia de producto citese obligatoriamente en caso de reclamacion :
Ver etiqueta en la parte posterior del producto.

GARANTIA (vices ocultos)
Em caso de reclamacao indiqu-nos imperativamente a referencia do produto :
Ver etiqueta fixada na parte posterior do produto

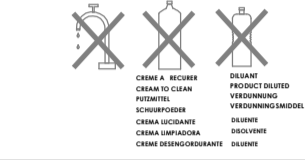
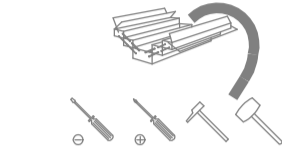

A

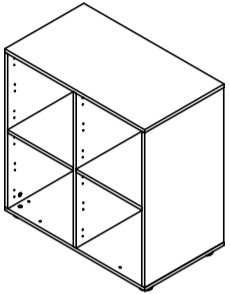

B

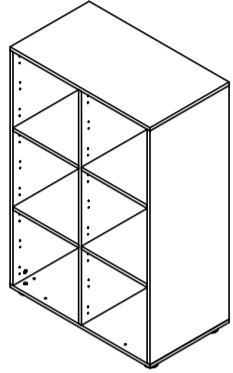

NOMENCLATURE

(Parts list)
(Stückliste)
(Onderdelenlijst)
(Nomenclatura)
(Lista de peças)

Rep.	Pièce	Qté
1	FOND	1
2	DESSUS	1
3	COTE	2
4	SEPARATION	1
5	PAR	2
6	TABLETTE FIXE	2/4

Rep.	Pièce	Qté
7	SOCLE FRONTAL	2
8	SOCLE LATERAL	2

QUINCAILLERIE

A B

(Hardware)
(Beschläge)
(Izzerwaren)
(Ferramenta)
(Herrajes)
(Quinquilharia)

Rep.	Pièce	Qté	Qté
A	Patin Ht 23	5	5
B	Vis TF 3.5x13	10	10
C	Excentrique Ø15	16	20
D	Goujon bois	14	16
E	Goujon bois 7.5 mm	2	4
F	Cache excent.	16	20
G	Cache Ø8	8	8
H	Cache Ø15	4	4
I	Clé 6 pans 4mm	1	1
Rep.	Pièce	Qté	
J	Vis 7x70	8	
K	Vis 7x50	8	
L	Cache vis	16	
M	Vérin Standard	4	

AIDE

HELP
HILFE
HULP
AYUDA
AJUDA
AIUTO

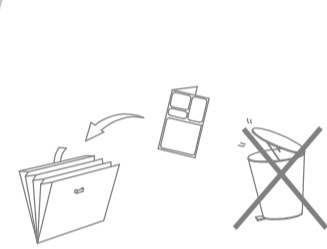
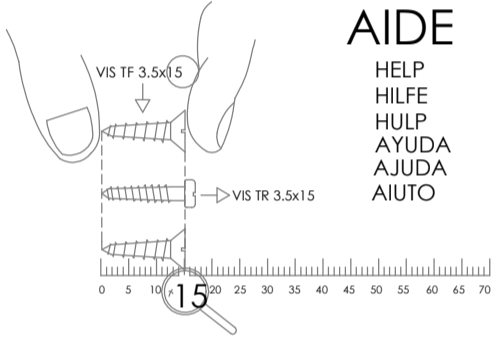

Option
Optioneel
Opzione
Opcional
Opção

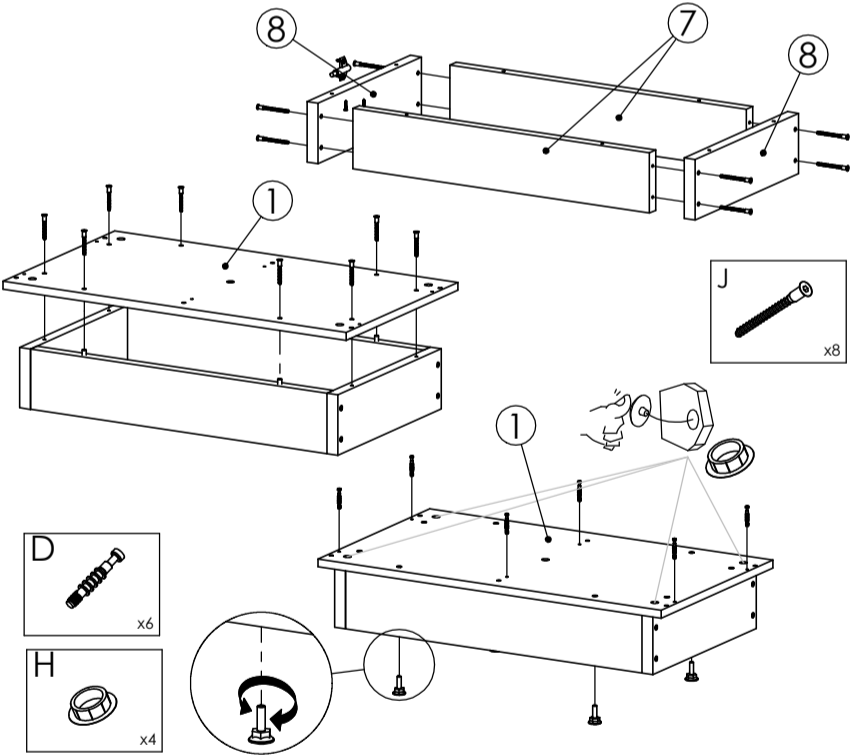

1

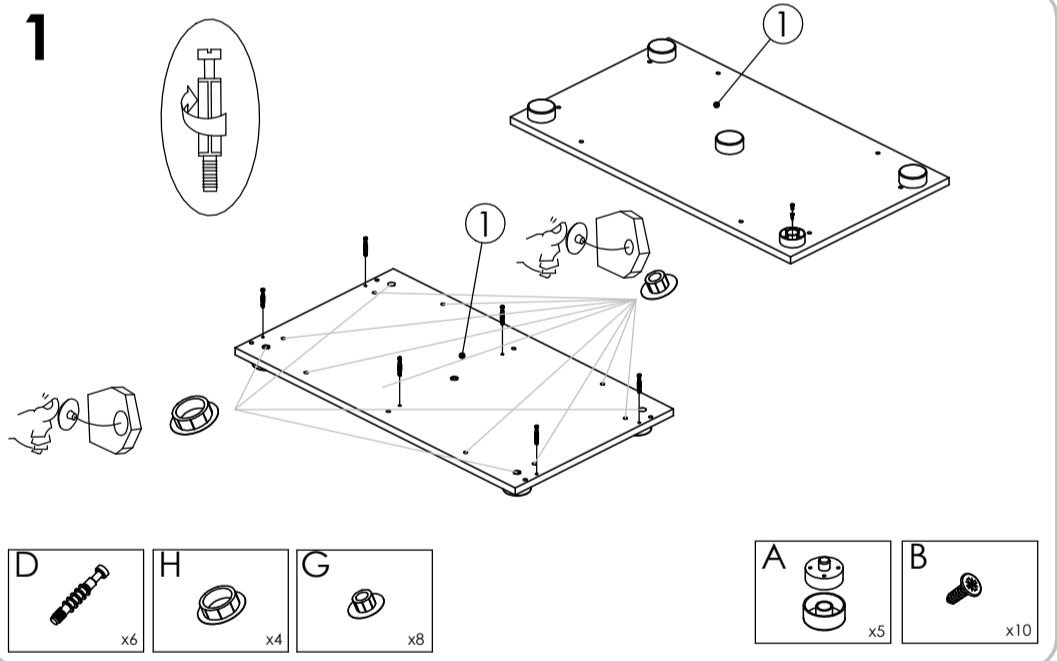

2

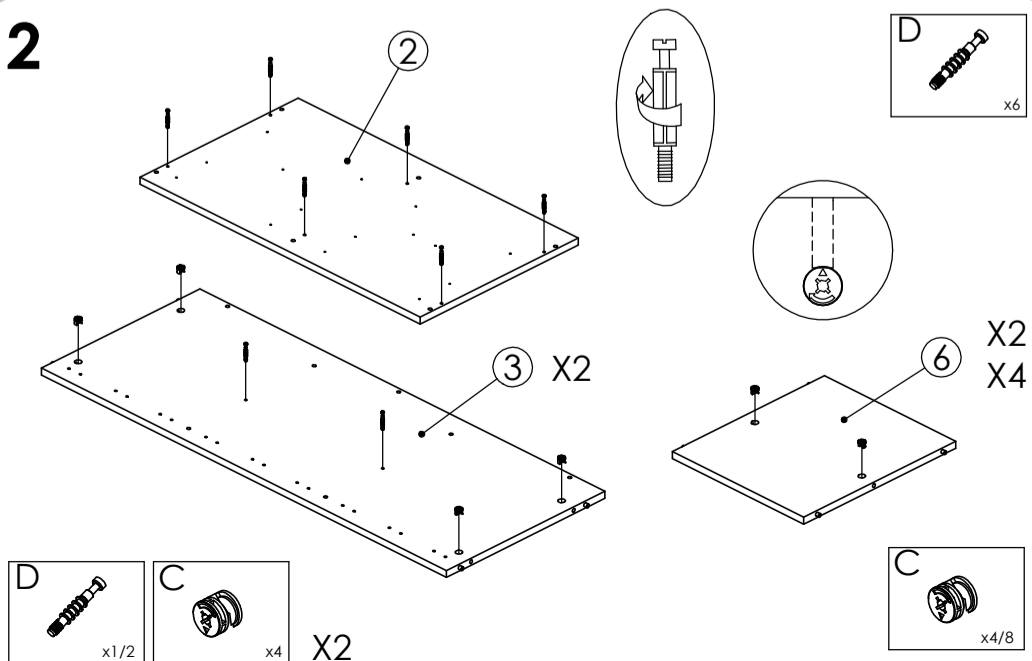

3

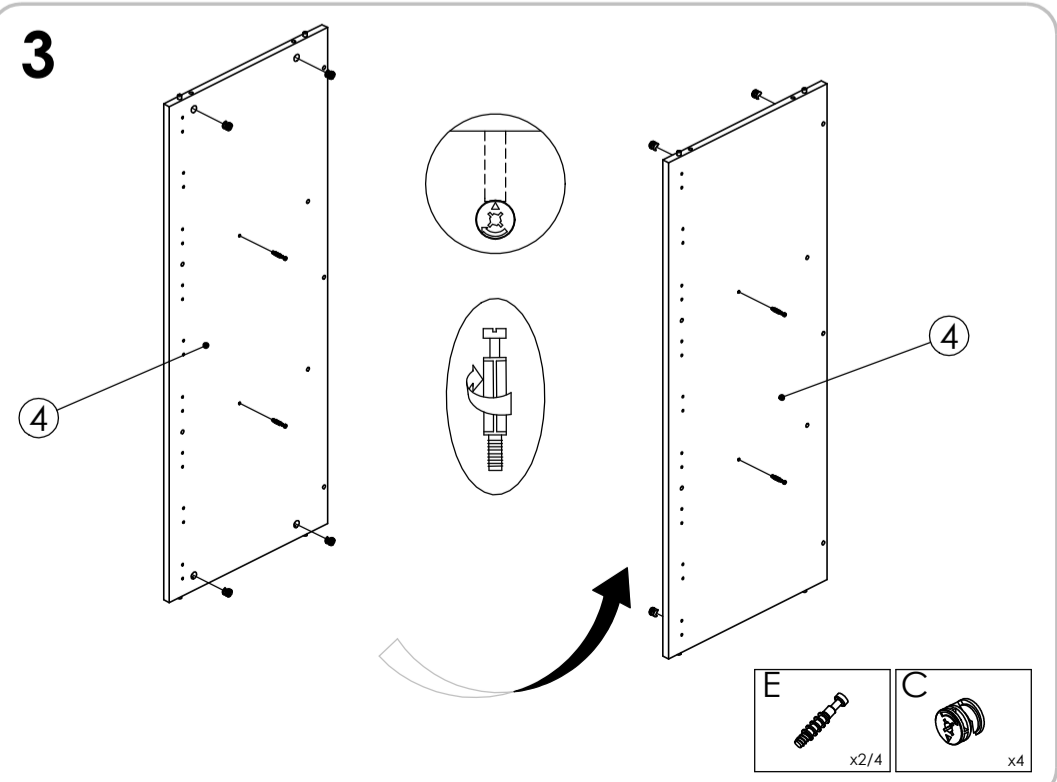

4

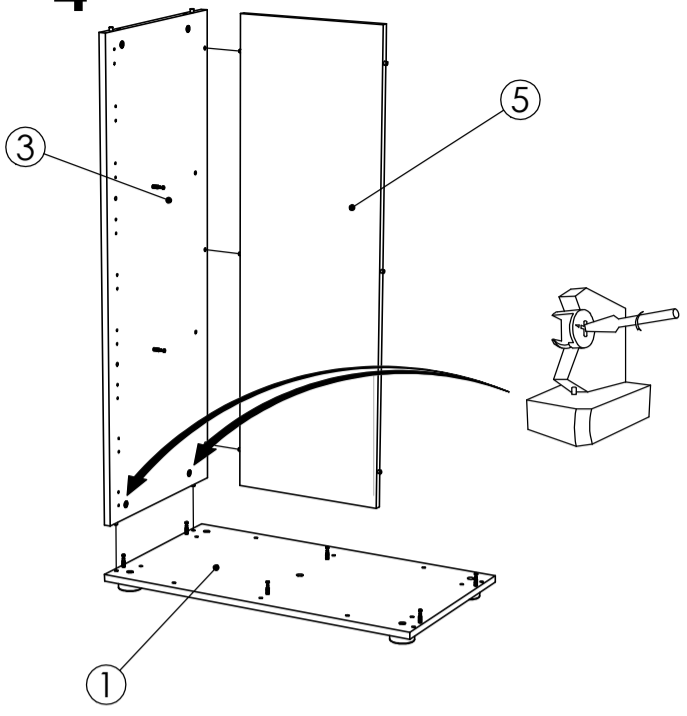

5

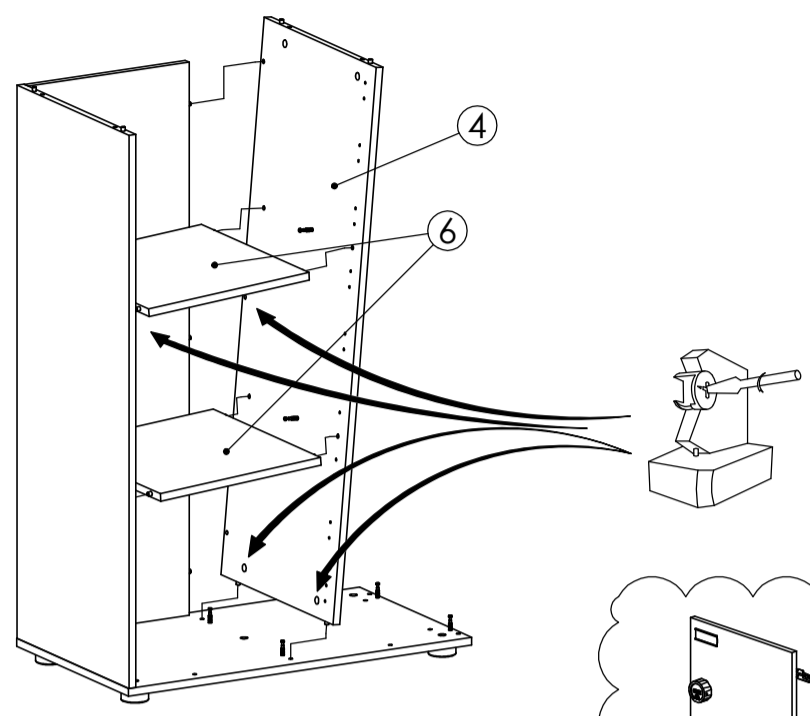

!
Tablette 6
Voir DV40827/ B =>

6

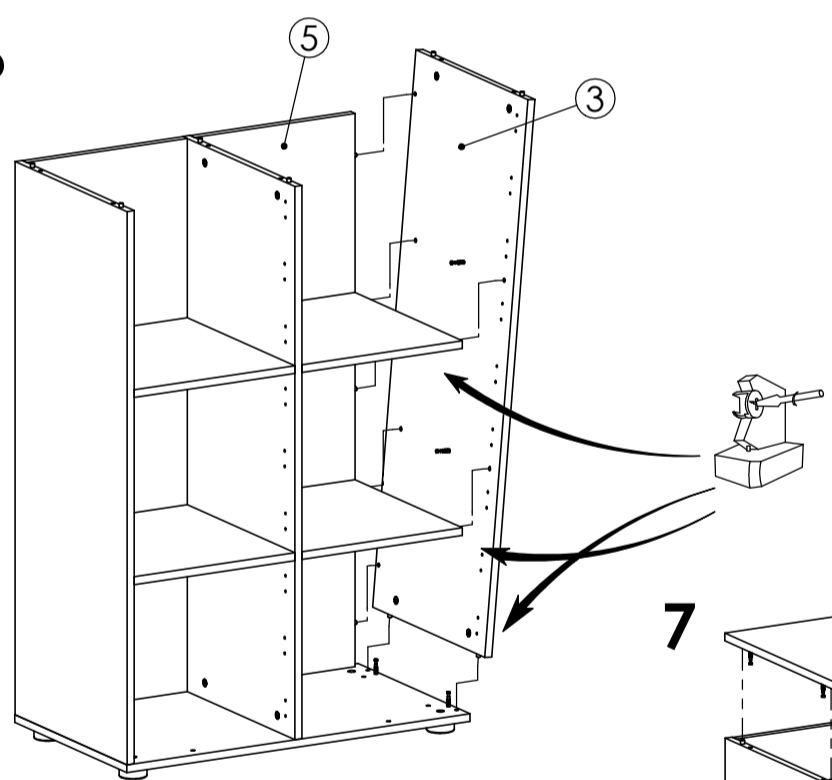

7

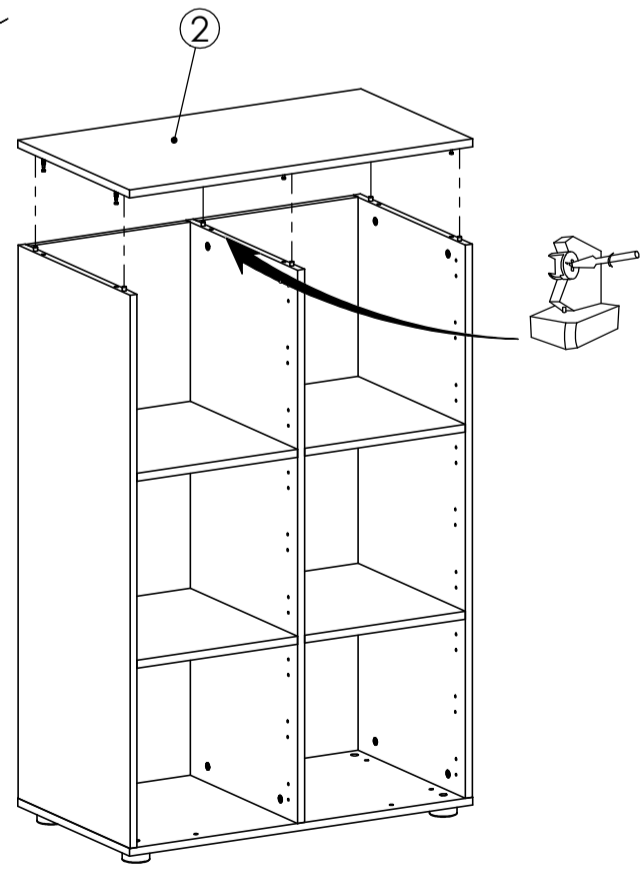

8

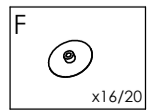
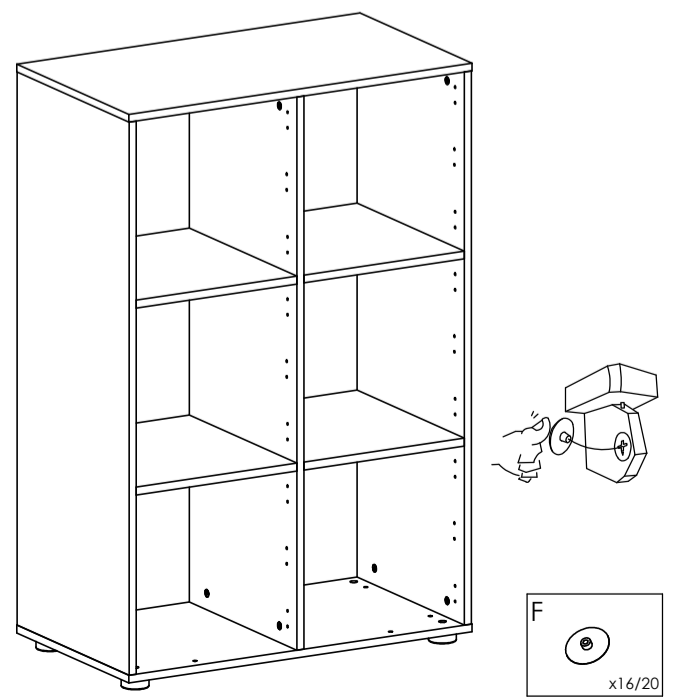

NOTICE DE MONTAGE
INSTRUCTIONS FOR ASSEMBLY
MONTAGEANLEITUNG
GEBRUIKSAANWIJZING
ISTRUZIONI DI MONTAGGIO
INSTRUCCIONES DE MONTAJE
INSTRUÇÕES DE MONTAGEM

buronomic
FABRICANT FRANÇAIS

N° DV40792/04

CONCEPTION ET REALISATION BUREAU D'ETUDES BURONOMIC

GARANTIE (vices cachés)
Référence produit à nous communiquer impérativement en cas de litige :
Voir étiquette apposée au dos du produit

GARANTEE (defekt)
In the event of complaint, it is essential to mention the product reference :
See label affixed to the back of the product.

GARANTIE (fabrikationsfeil)
Im streifall sit uns die produktreferenz mitzuteilen :
Siehe etikett auf produktseite.

WAARBORG (de verborgen gebreken)
Vermeld in geval van klachten altijd het productnummer :
Zie label op de achterzijde van het product

GARANZIA (vizi occulti)
Specificare obbligatoriamente il riferimento prodotto in caso di contestazioni :
Si veda l'etichetta applicata dietro il prodotto

GARANTIA (defectos ocultos)
Referencia de producto citese obligatoriamente en caso de reclamacion :
Ver etiqueta en la parte posterior del producto.

GARANTIA (vices ocultas)
Em caso de reclamacao indiqu-nos imperativamente a referencia do produto :
Ver etiqueta fixada na parte posterior do produto

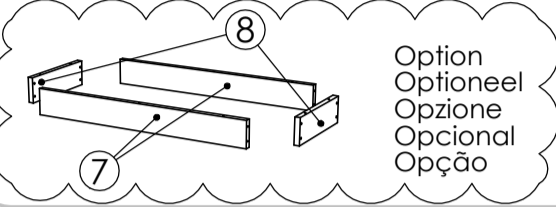
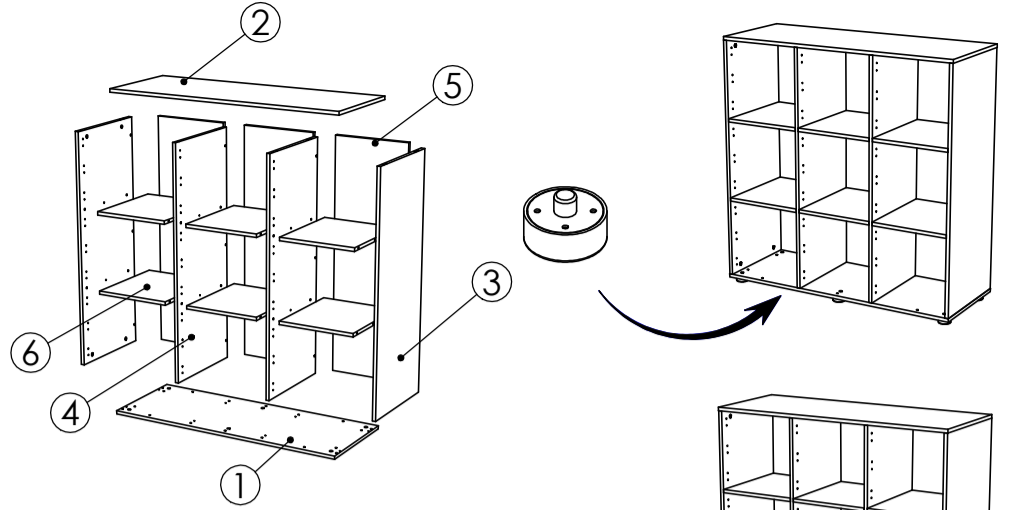
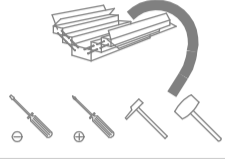
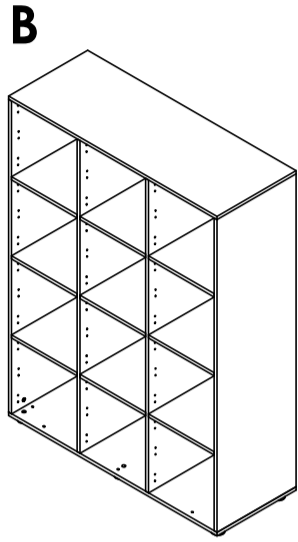
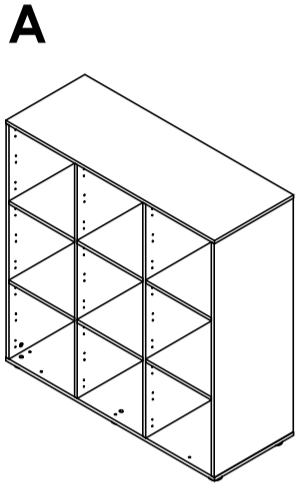

Option
Optioneel
Opzione
Opcional
Opção

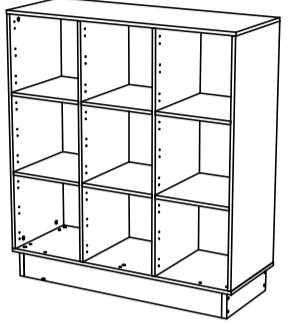

NOMENCLATURE

(Parts list)
(Stückliste)
(Onderdelenlijst)
(Nomenclatura)
(Lista de peças)

Rep.	Pièce	Qté
1	FOND	1
2	DESSUS	1
3	COTE	2
4	SEPARATION	2
5	PAR	3
6	TABLETTE FIXE	6/9

Rep.	Pièce	Qté
7	SOCLE FRONTAL	2
8	SOCLE LATERAL	2

QUINCAILLERIE

A B

(Hardware)
(Beschläge)
(Izzerwaren)
(Ferramentas)
(Herrajes)
(Quinquilharia)

Rep.	Pièce	Qté	Qté
A	Patin Ht 23	6	6
B	Vis TF 3.5x13	12	12
C	Excentrique Ø15	28	34
D	Goujon bois	20	22
E	Goujon bois 7.5 mm	8	12
F	Cache excent.	28	34
G	Cache Ø8	10	10
H	Cache Ø15	6	6
I	Clé 6 pans 4mm	1	1
Rep.	Pièce	Qté	
J	Vis 7x70	8	
K	Vis 7x50	10	
L	Cache vis	18	
M	Vérin Standard	4	

AIDE

HELP
HILFE
HULP
AYUDA
AJUDA
AIUTO

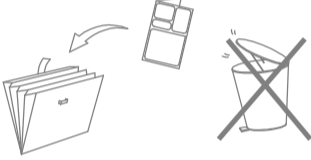
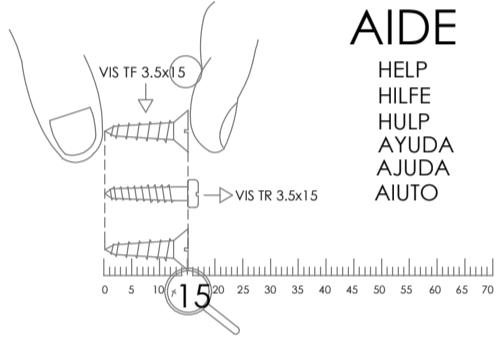

Option
Optioneel
Opzione
Opcional
Opção

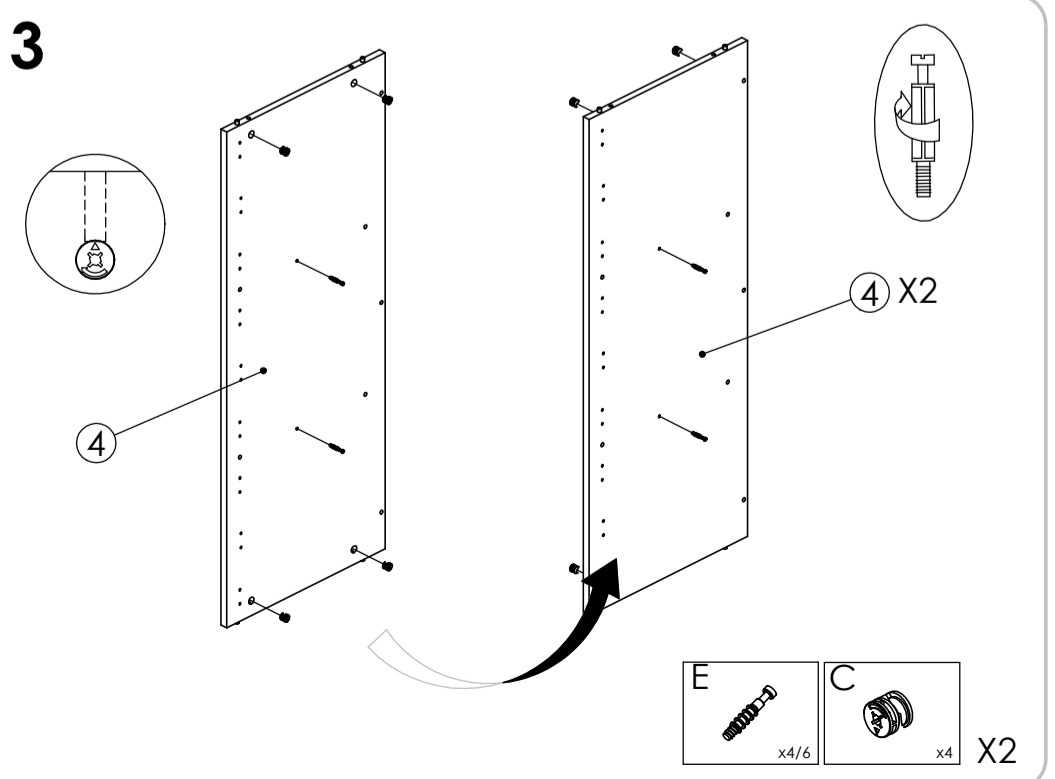
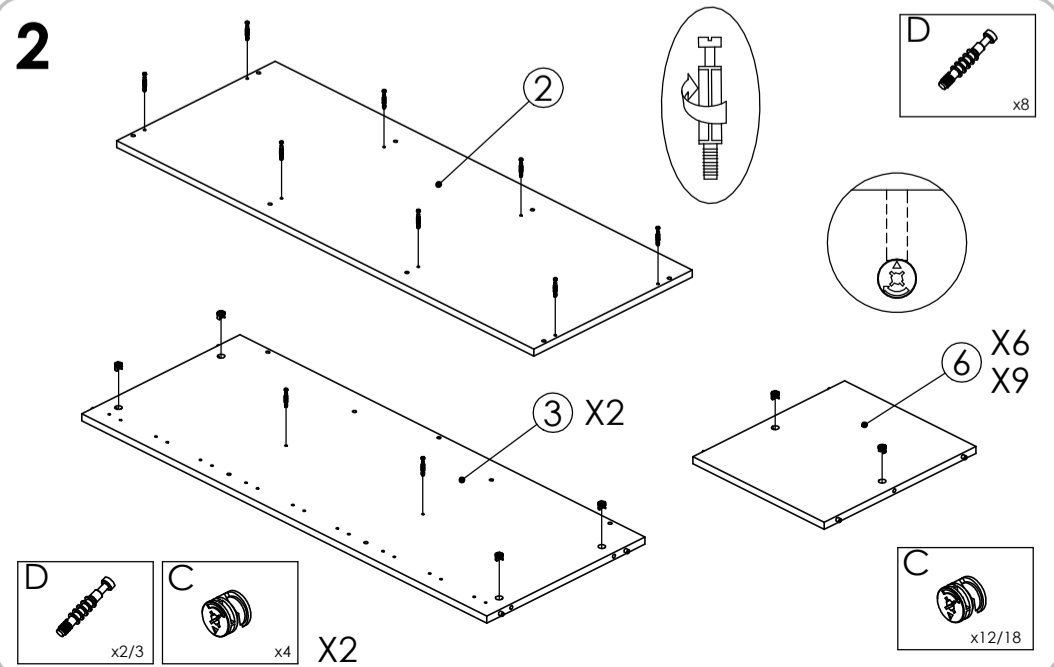
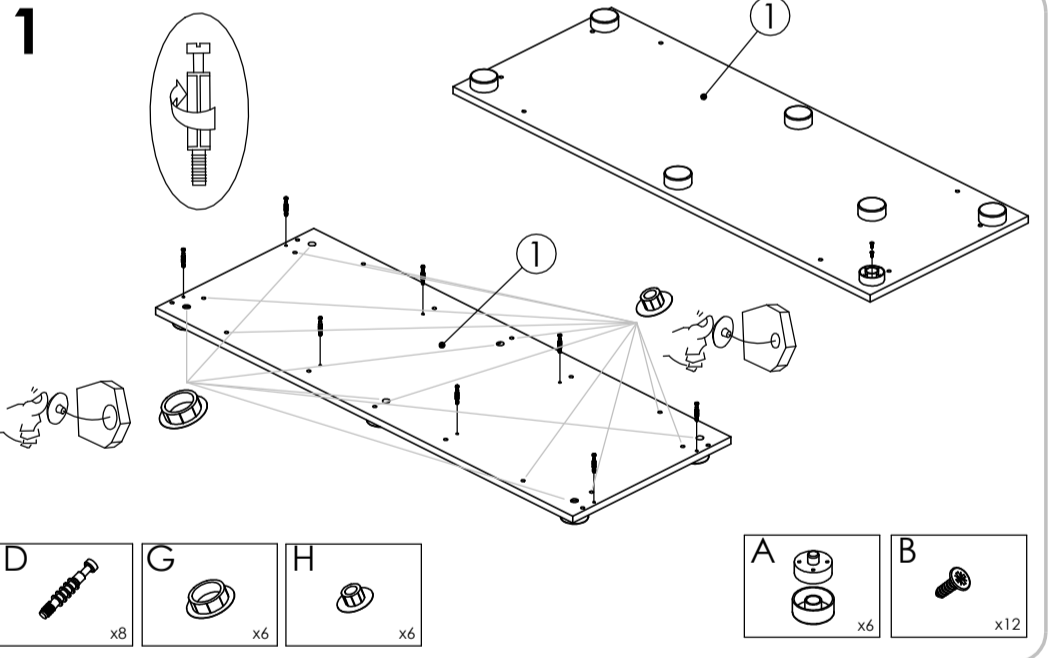
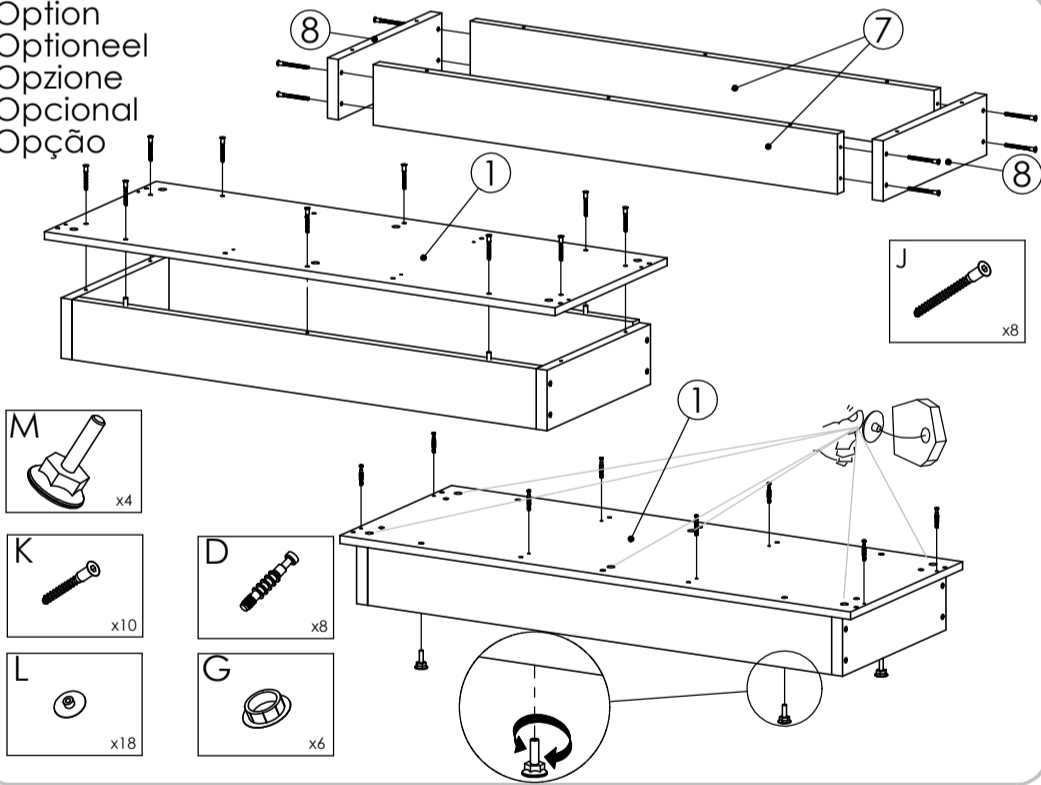

4

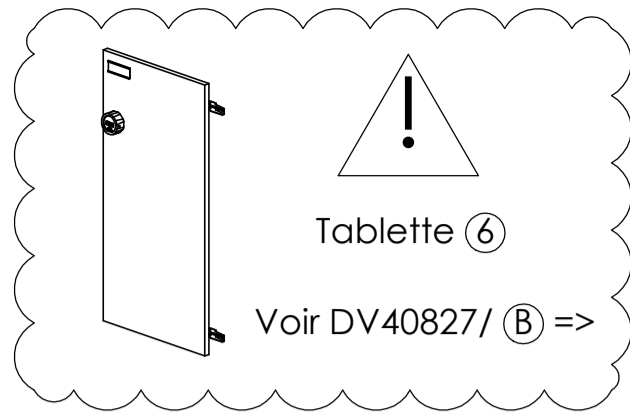
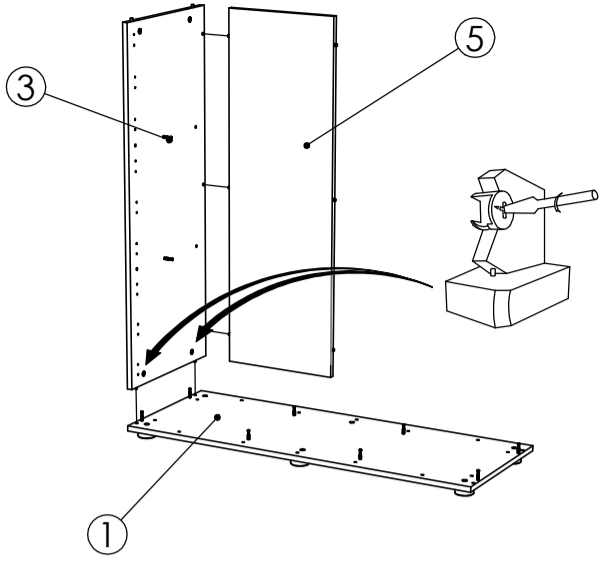

5

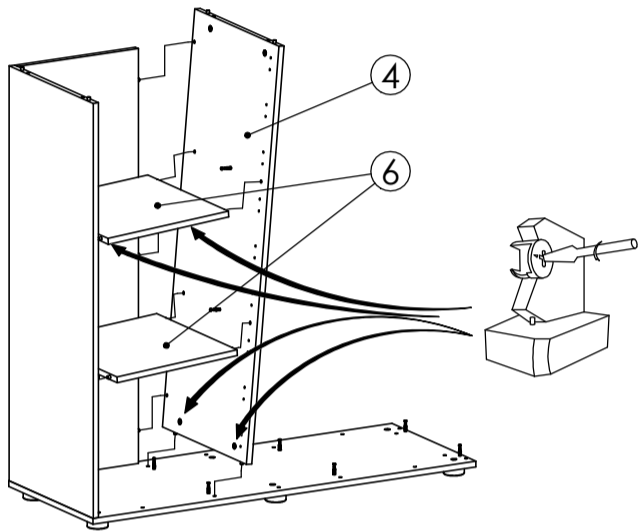

6

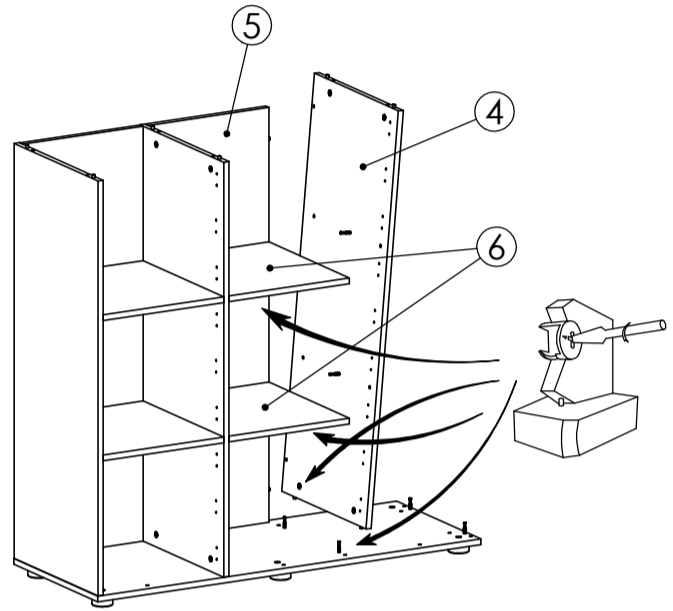

7

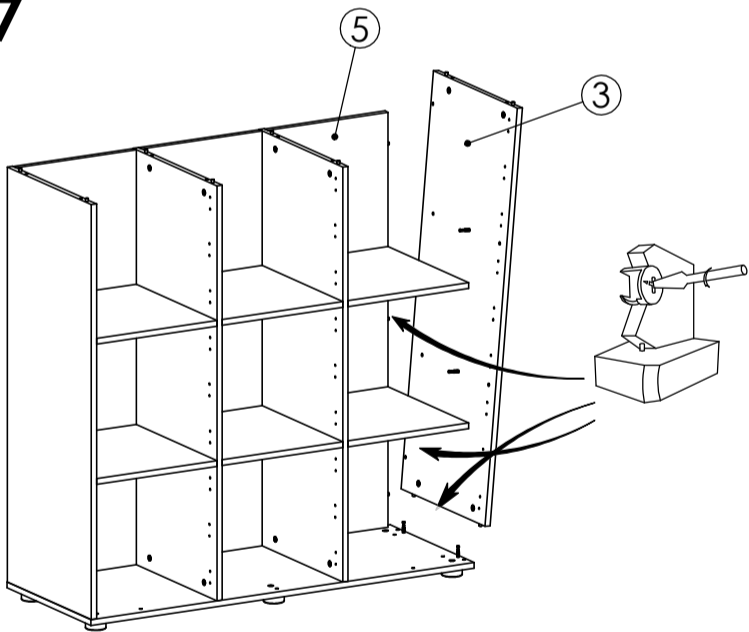

8

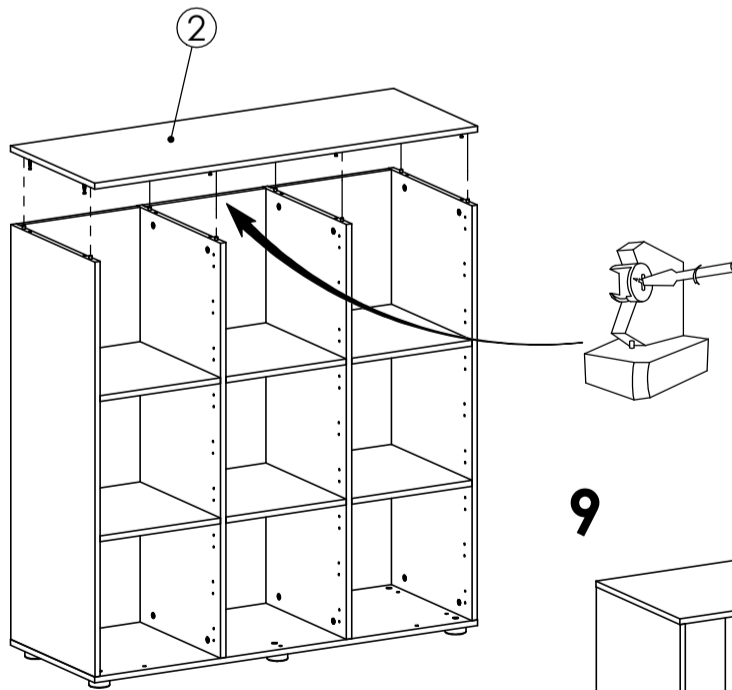

9

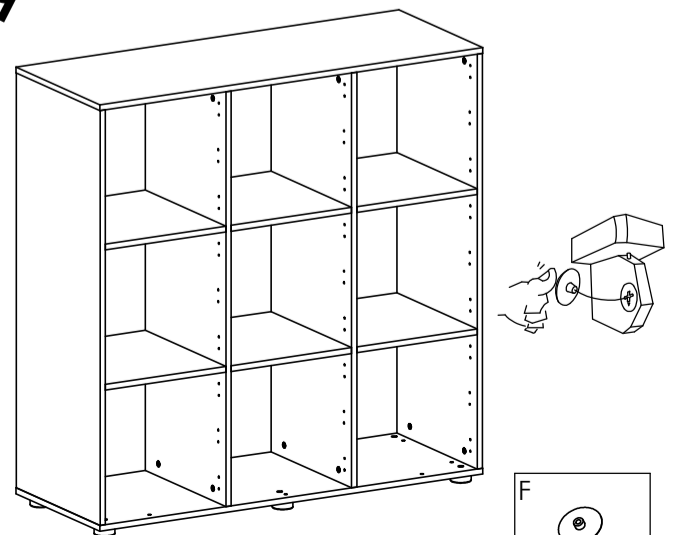

NOTICE DE MONTAGE
INSTRUCTIONS FOR ASSEMBLY
MONTAGEANLEITUNG
GEBRUIKSAANWIJZING
ISTRUZIONI DI MONTAGGIO
INSTRUCCIONES DE MONTAJE
INSTRUCOES DE MONTAGEM

buronomic
FABRICANT FRANÇAIS

N° DV40827/01

CONCEPTION ET REALISATION BUREAU D'ETUDES BURONOMIC

GARANTIE (vices cachés)
_ Référence produit à nous communiquer impérativement en cas de litige :
Voir étiquette apposée au dos du produit

GARANTIE (defekt)
_ In the event of complaint, it is essential to mention the product reference :
See label affixed to the back of the product.

GARANTIE (fabrikationsfeil)
_ Im streifall sit uns die produktreferenz mitzuteilen :
Siehe etikett auf produktseite.

WAARBORG (de verborgen gebreken)
_ Vermeld in geval van klachten altijd het productnummer :
Zie label op de achterzijde van het product

GARANZIA (vizi occulti)
_ Specificare obbligatoriamente il riferimento prodotto in caso di contestazioni :
Si veda l'etichetta applicata dietro il prodotto

GARANTIA (defectos ocultos)
_ Referencia de producto cite obligatoriamente en caso de reclamacion :
Ver etiqueta en la parte posterior del producto.

GARANTIA (vices ocultos)
_ Em caso de reclamacao indiq-nos imperativamente a referencia do produto :
Ver etiqueta fixada na parte posterior do produto

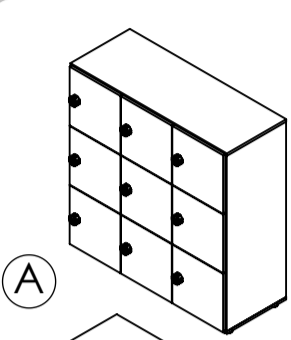

A

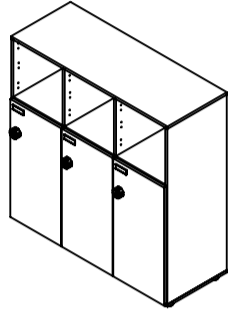
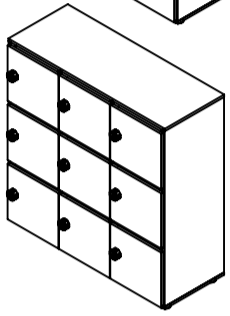

B

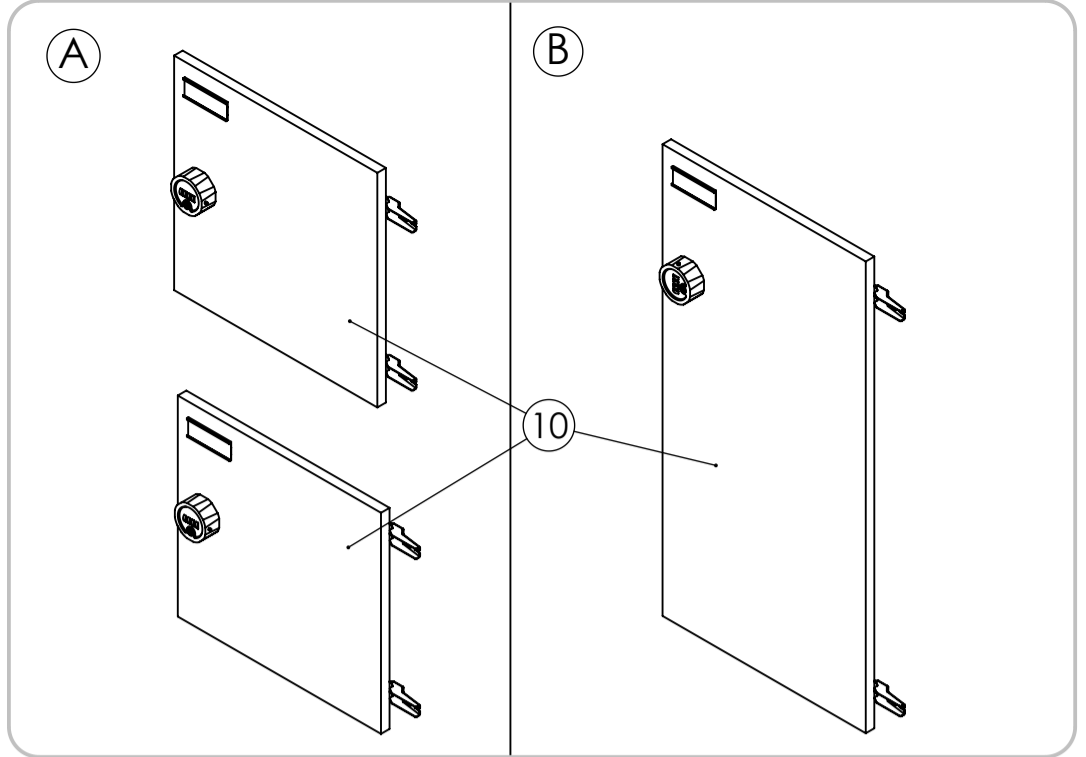
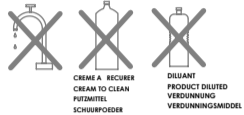
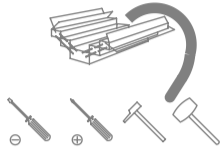

NOMENCLATURE

(Parts list)
(Stückliste)
(Onderdelenlijst)
(Nomenclatura)
(Lista de peças)

Rep.	Pièce	Qté
10	PORTE serrure à code	1

QUINCAILLERIE

(Hardware)
(Beschläge)
(Izerwaren)
(Ferramentas)
(Herrajes)
(Quinilharia)

M	Serrure code	3	M	N	O
N	GACHE Tôle	3	P	Q	R
O	Vis Euro Std Lg 13mm	6	S	T	U
P	Vis TCB 3x13	3	V	W	X
Q	CHARN.AGGLO.1 63310/2 Coudé (sans ressort)	6	Y	Z	
R	Cale charnière	6			
S	Amortisseur	3			
T	Porte étiquette	3			

AIDE

HELP
HILFE
HULP
AYUDA
AJUDA
AIUTO

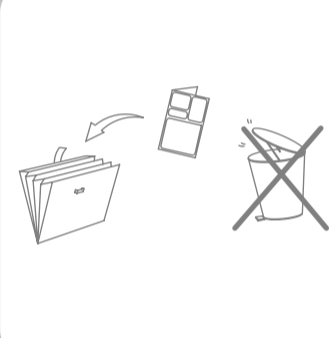
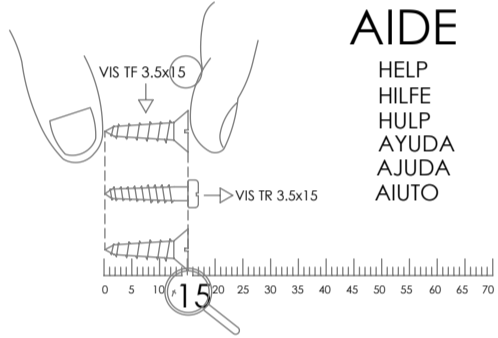

1A

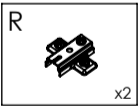
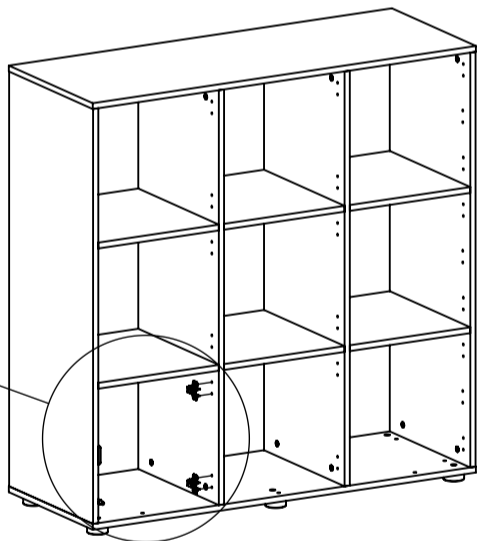
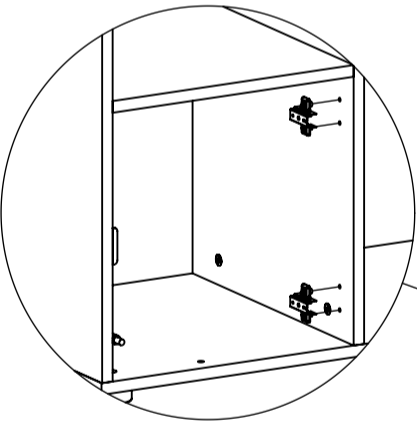

1B

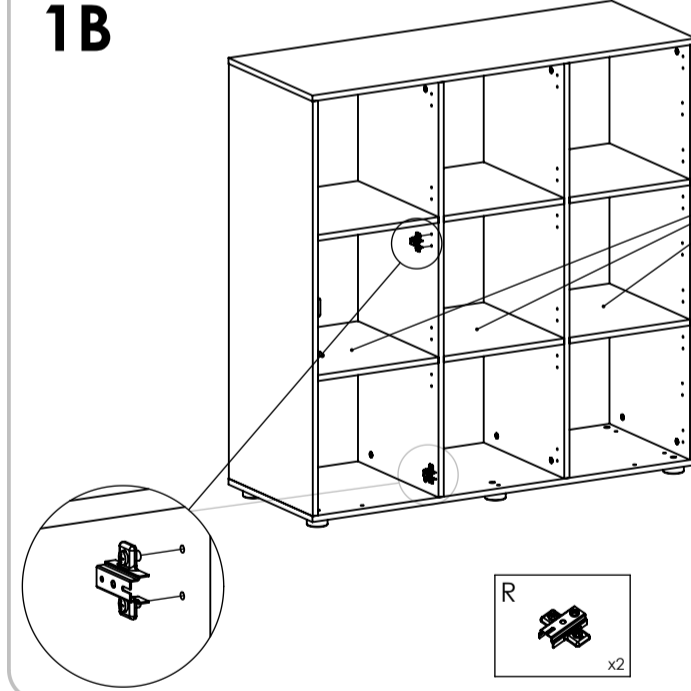

Option
Optioneel
Opzione
Opcional
Opção

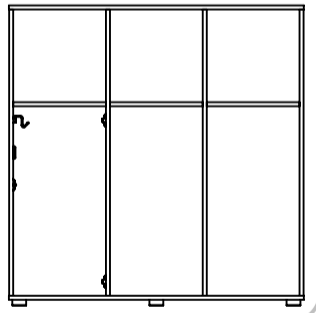
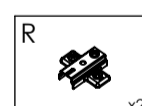

2A

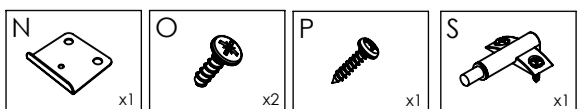
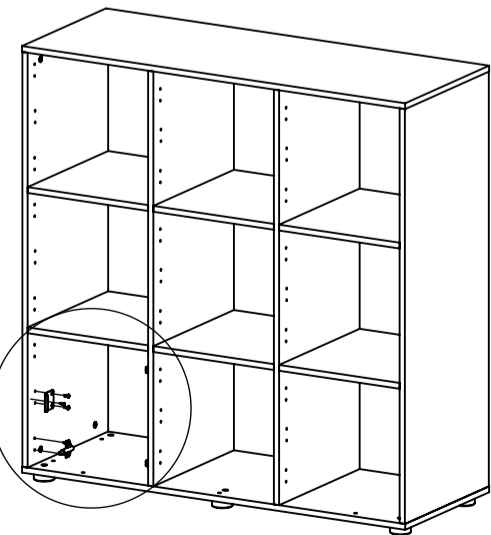
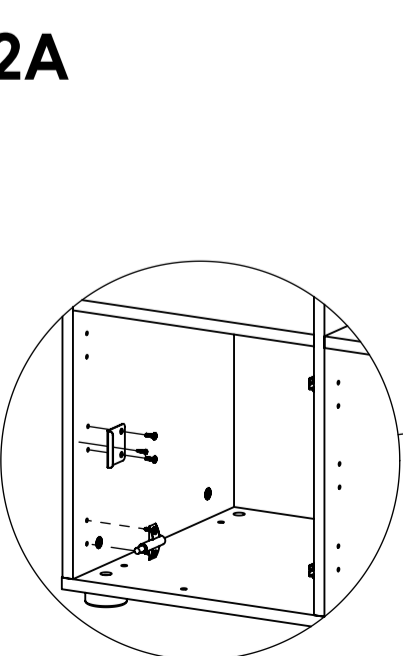

2B

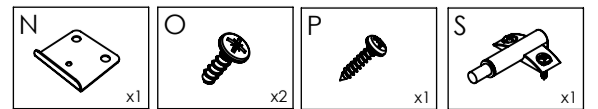
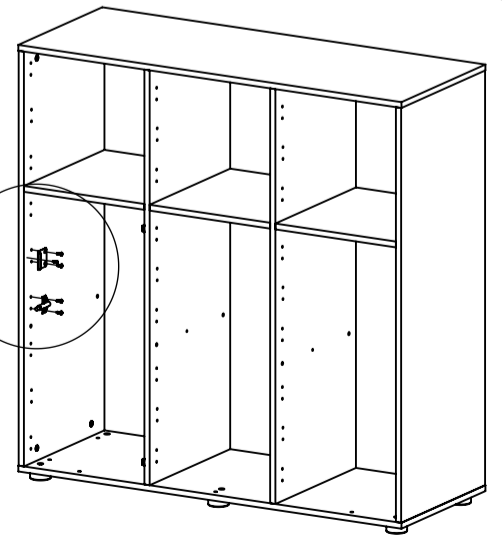
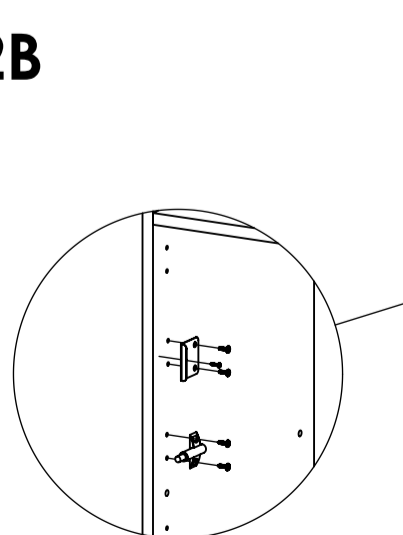

3A

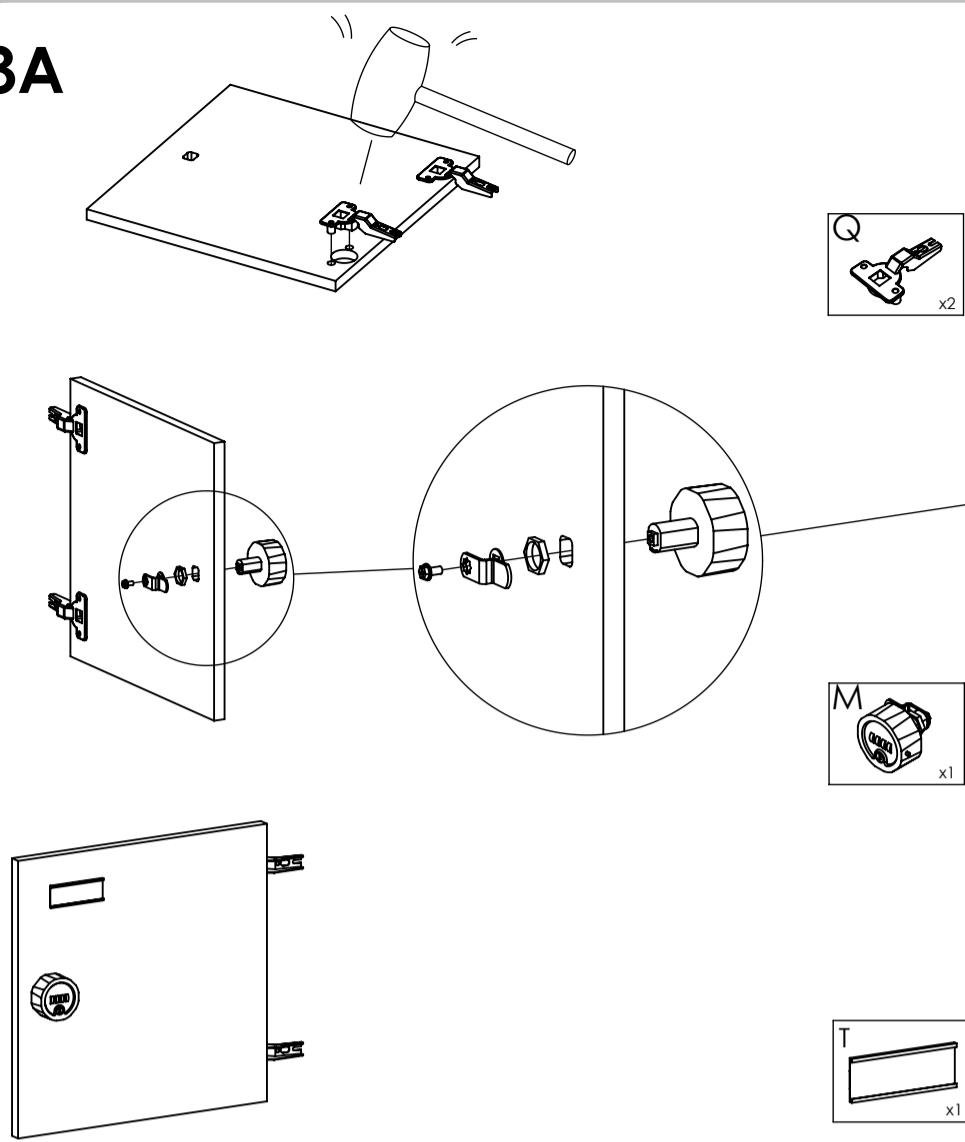

3B

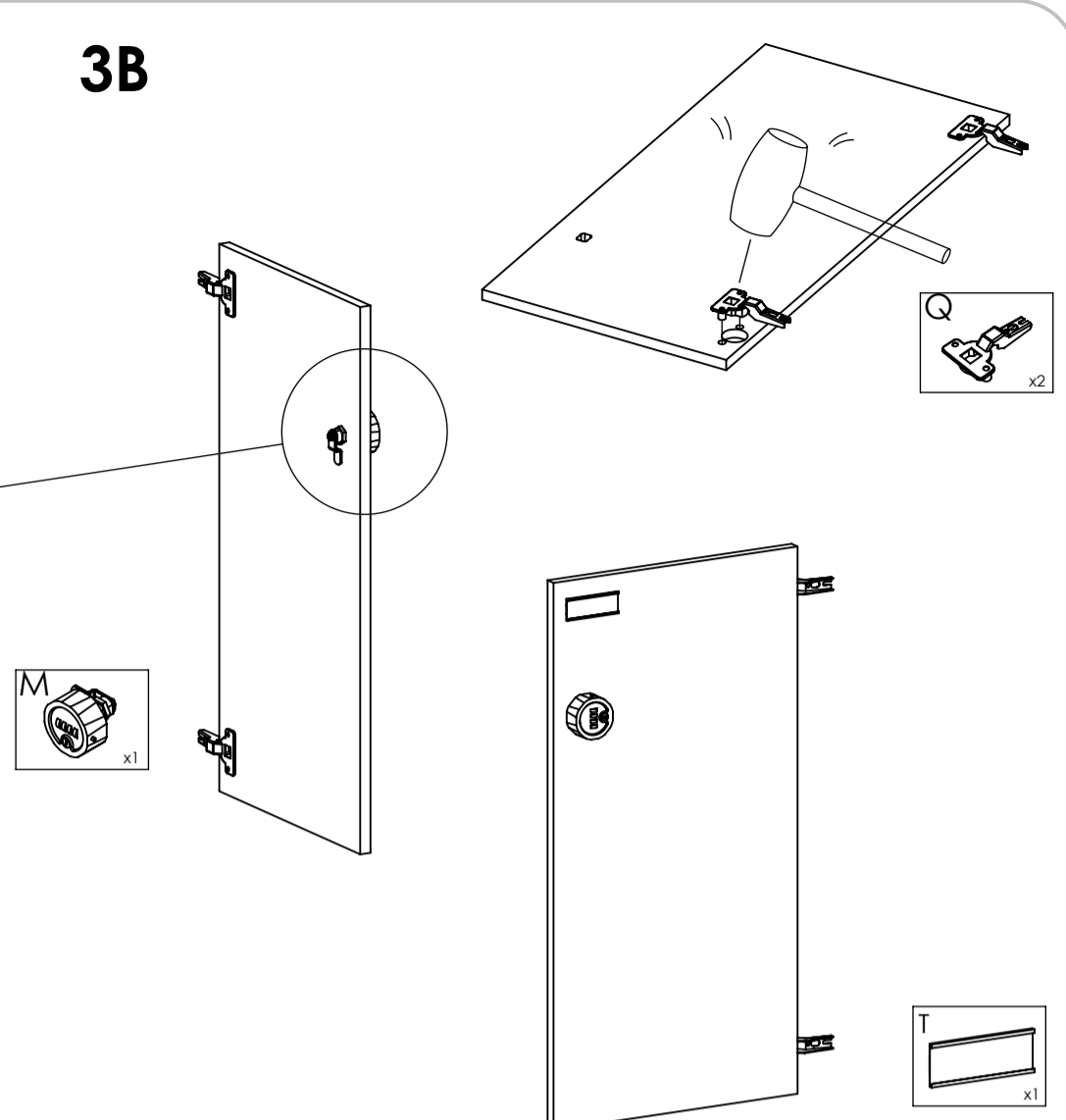

4B

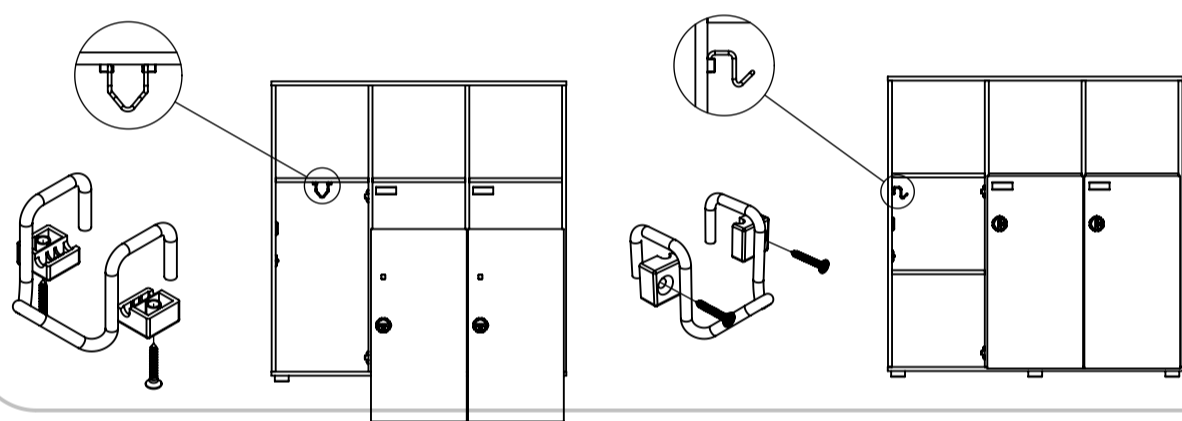

Rep.	Pièce	Qté
U	PATERE/Composant FIL INOX Ø5/ Brossage satiné	1
V	Support fil	2
W	Vis TF 3x20	2

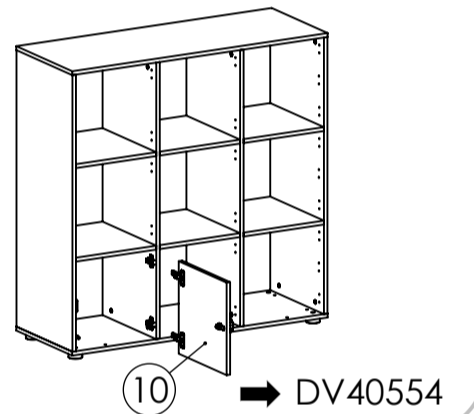
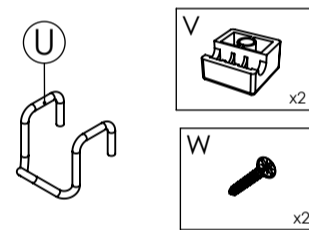

Operating instructions

PRESS & HOLD

SET CODE

RELEASE

SCRAMBLE CODE



Lost code retrieval

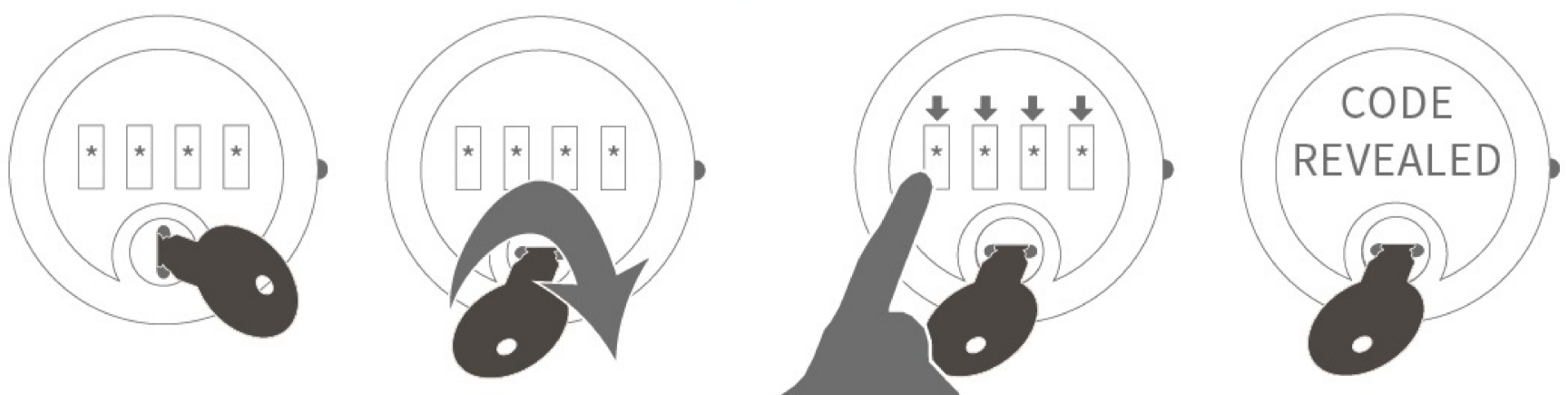

buronomic

FABRICANT FRANÇAIS

N° DV40856

CONCEPTION ET REALISATION BUREAU D'ETUDES BURONOMIC

