

NOTICE DE MONTAGE
INSTRUCTIONS FOR ASSEMBLY
MONTAGEANLEITUNG
GEBRUIKSAANWIJZING
ISTRUZIONI DI MONTAGGIO
INSTRUCCIONES DE MONTAJE
INSTRUCCOES DE MONTAGEM

buromomic

FABRICANT FRANÇAIS

N° DV40821_1

CONCEPTION ET REALISATION BUREAU D'ETUDES BUROMOMIC

GARANTIE (vices caches)
_ Référence produit à nous communiquer impérativement en cas de litige :
Voir étiquette apposée au dos du produit

GARANTEE (defekt)
_ In the event of complaint, it is essential to mention the product reference :
See label affixed to the back of the product.

GARANTIE (fabrikationfelher)
_ Im streifall sit uns die produktreferenz mitzuteilen :
Siehe etikett auf produktruckseite.

WAARBORG (de verborgen gebreken)
_ Vermeld in geval van klachten altijd het productnummer :
Zie label op de achterzijde van het product

GARANZIA (vizi occulti)
_ Specificare obbligatoriamente il riferimento prodotto in caso di contestazioni :
Si veda l'etichetta applicata dietro il prodotto

GARANTIA (defectos ocultos)
_ Referencia de producto citese obligatoriamente en caso de reclamacion :
Ver etiqueta en la parte posterior del producto.

GARANTIA (vícios ocultos)
_ Em caso de reclamacao indiqu-nos imperativamente a referência do produto :
Ver etiqueta fixada na parte posterior do produto

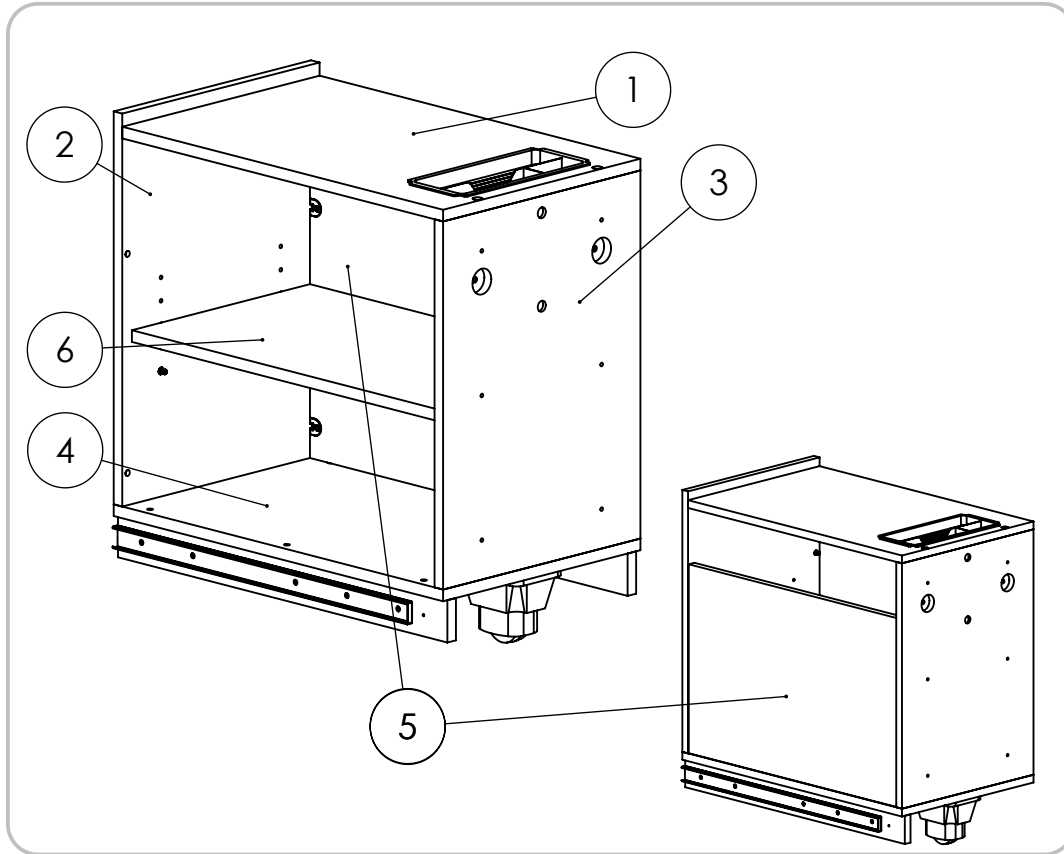
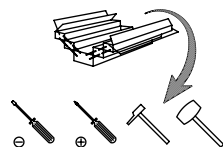
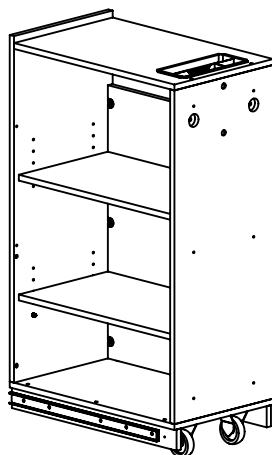
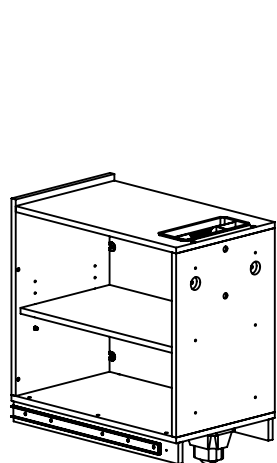

NOMENCLATURE (Parts list)
(Stückliste)
(Onderdelenlijst)
(Nomenclatura)
(Lista de peças)

REP.	PIECE	QTÉ
1	DESSUS	1
2	FACE ARRIÈRE	1
3	FACE AVANT TIROIR	1
4	FOND	1
5	COTÉ TIROIR	1
6	TABLETTE	1-2

QUINCAILLERIE

Rep.	Pièce	Qté	A	B	C	D	E	F	G	H	I	J
A	Vis 7x50	8										
B	ROULETTE REGLABLE	1										
C	VIS EURO	4-8										
D	Cache Ø5	4										
E	Cache vis	2										
F	Vis exp.	8										
G	Clé 6 pans 4mm	1										
H	ROULETTE	2										
J	Plumier	1										

(Hardware)
(Beschläge)
(Izerwaren)
(Ferramenta)
(Herrajes)
(Quinquilharia)

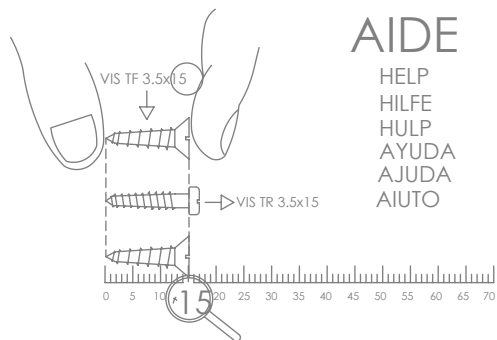

AIDE

HELP
HILFE
HULP
AYUDA
AJUDA
AIUTO

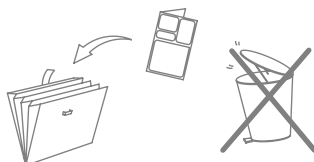

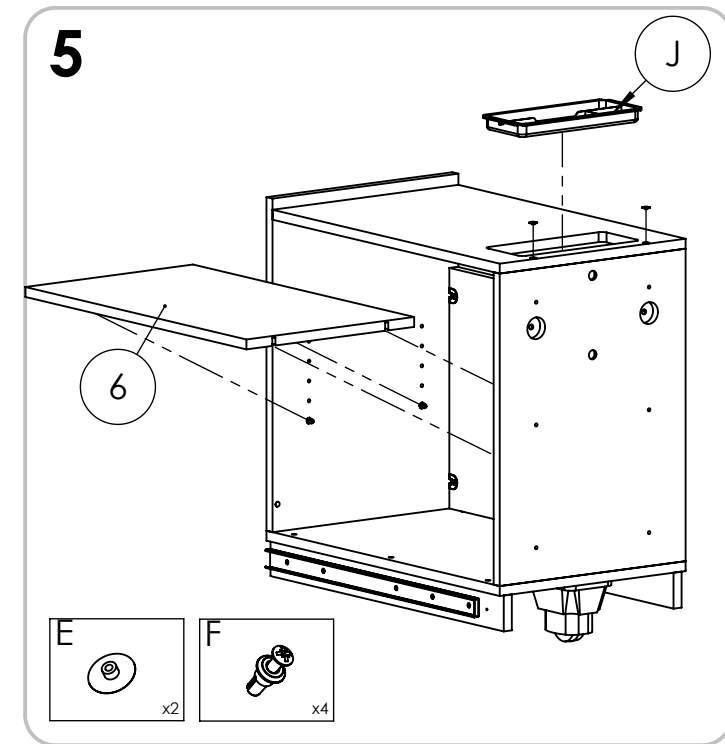
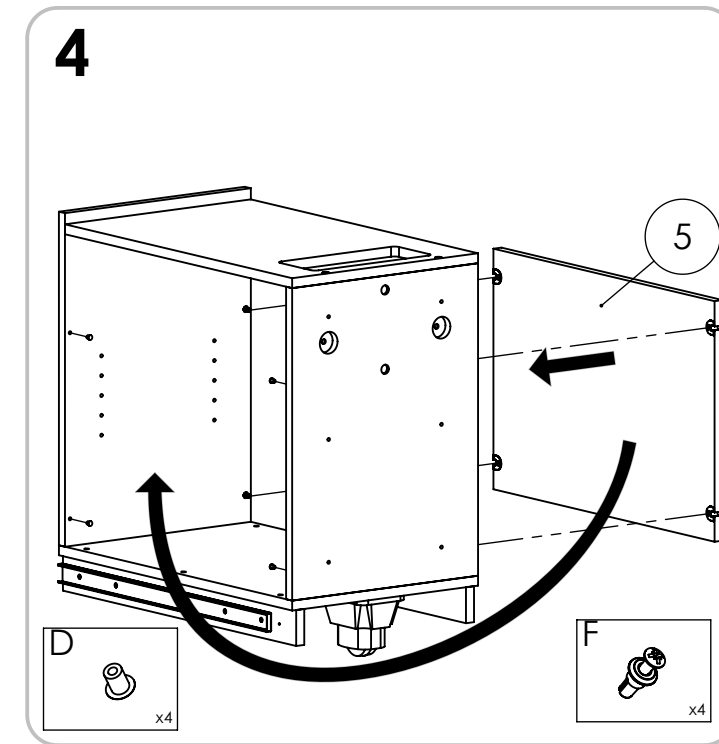
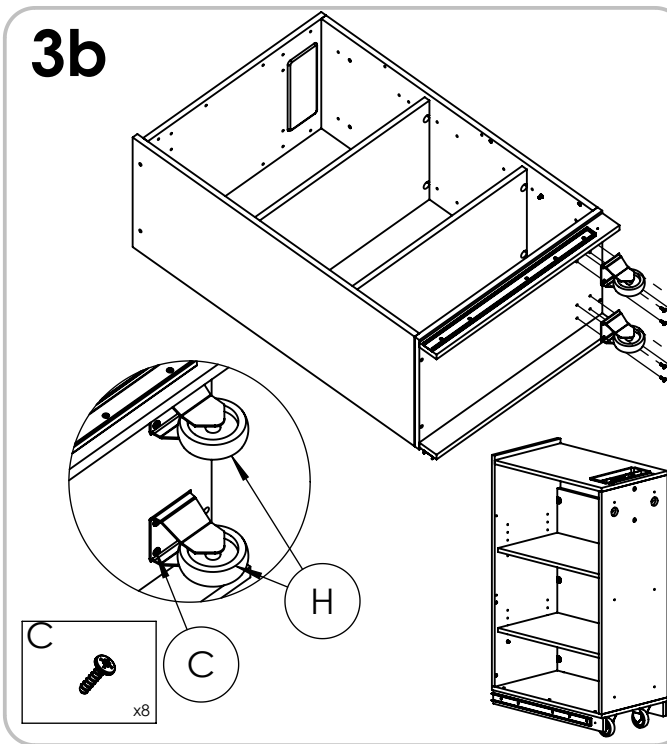
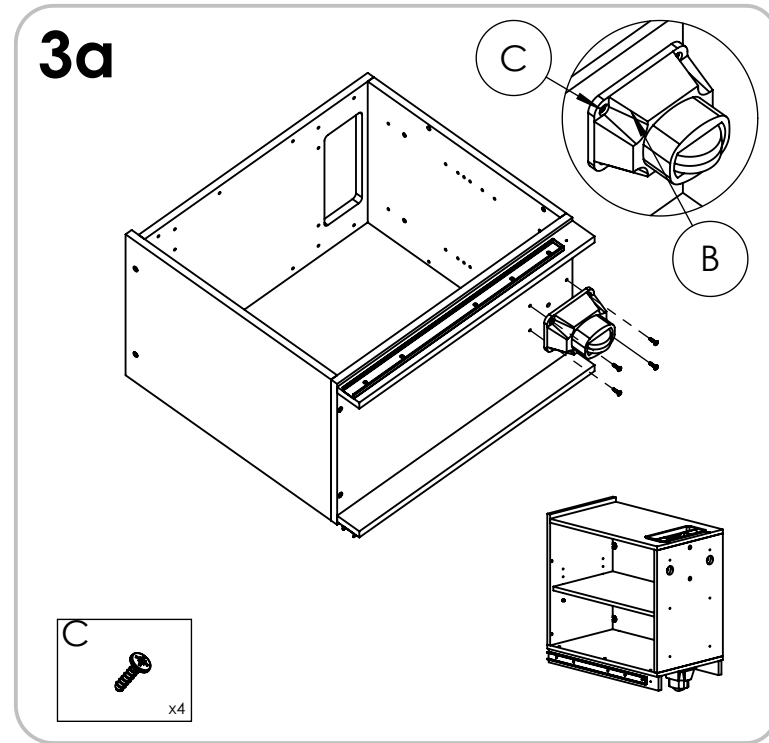
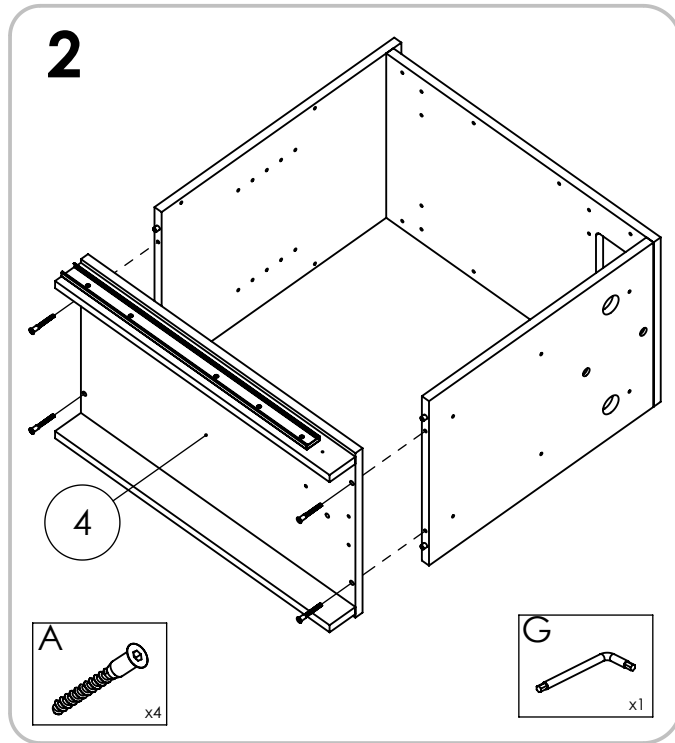
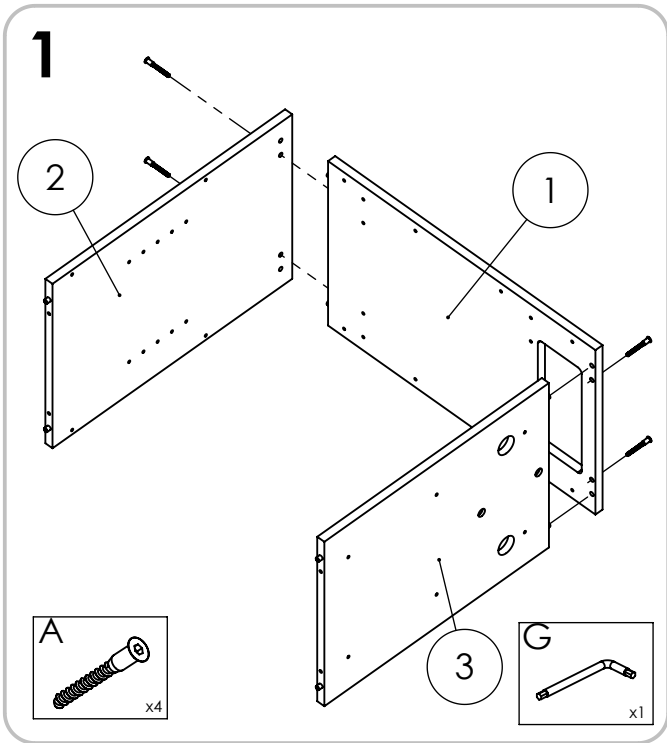

NOTICE DE MONTAGE
INSTRUCTIONS FOR ASSEMBLY
MONTAGEANLEITUNG
GEBRUIKSAANWIJZING
ISTRUZIONI DI MONTAGGIO
INSTRUCCIONES DE MONTAJE
INSTRUCCOES DE MONTAGEM

buronomic
FABRICANT FRANÇAIS

N° DV40813_1

CONCEPTION ET REALISATION BUREAU D'ETUDES BURONOMIC

GARANTIE (voies cachées)
_ Référence produit à nous communiquer impérativement en cas de litige :
Voir étiquette apposée au dos du produit

GARANTIE (defekt)
_ In the event of complaint, it is essential to mention the product reference :
See label affixed to the back of the product.

GARANTIE (fabrikationsfeilten)
_ Im streifall sit uns die produktreferenz mitzuteilen :
Siehe etikett auf produkruckseite.

WAARBORG (de verborgen gebreken)
_ Vermeld in geval van klachten altijd het productnummer :
Zie label op de achterzijde van het product

GARANZIA (vizi occulte)
_ Specificare obbligatoriamente il riferimento prodotto in caso di contestazioni :
Si veda l'etichetta applicata dietro il prodotto

GARANTIA (defectos ocultos)
_ Referencia de producto citese obligatoriamente en caso de reclamacion :
Ver etiqueta en la parte posterior del producto.

GARANTIA (vizi oculte)
_ Em caso de reclamação indiqu-nos imperativamente a referência do produto :
Ver etiqueta fixada na parte posterior do produto

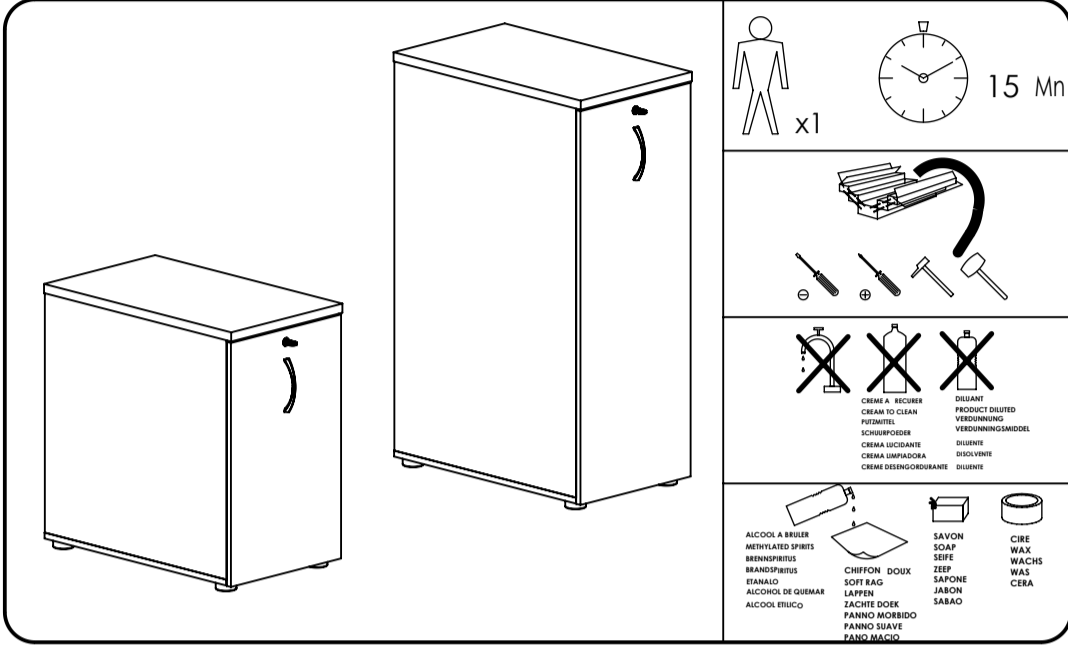
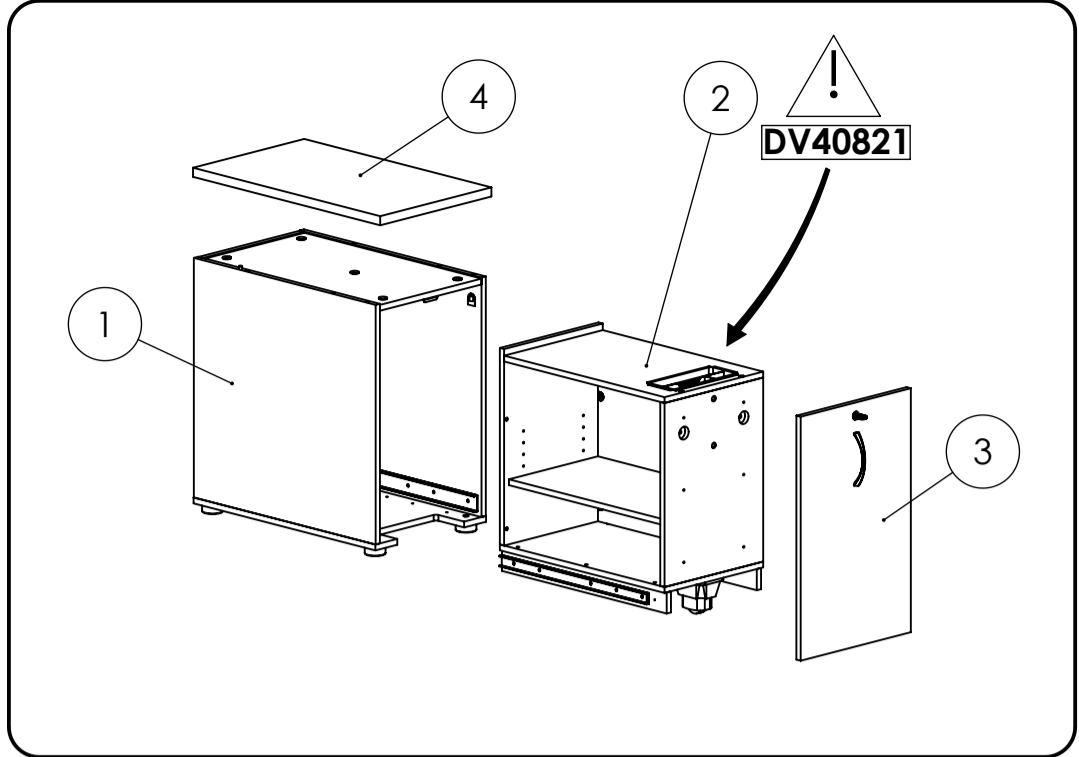

NOMENCLATURE (Parts list)
(Stückliste)
(Onderdelenlijst)
(Nomenclatura)
(Lista de peças)

REP.	PIÈCE	QTÉ
1	CAISSE	1
2	TIROIR	1
3	FAÇADE TIROIR	1
4	TOP	1

QUINCAILLERIE (Hardware)
(Beschläge)
(Ijzerwaren)
(Ferramentas)
(Herrajes)
(Quinquilharia)

Rep.	Pièce	Qté	A	B	C
A	Tourillon 7,8x35	6			
B	Poignée	1			
C	Vis TRL 4x22	2			
D	Serrure	1			
E	Rosette Ø16	1			
F	Vis TF 3x20	2			
G	Vis Euro Lg 13mm	2			
H	Vis 4x25	6			
I	Velcro Ø22 crochet	5			
J	Velcro Ø22 boucle	5			
K	Clé 6 pans	1			

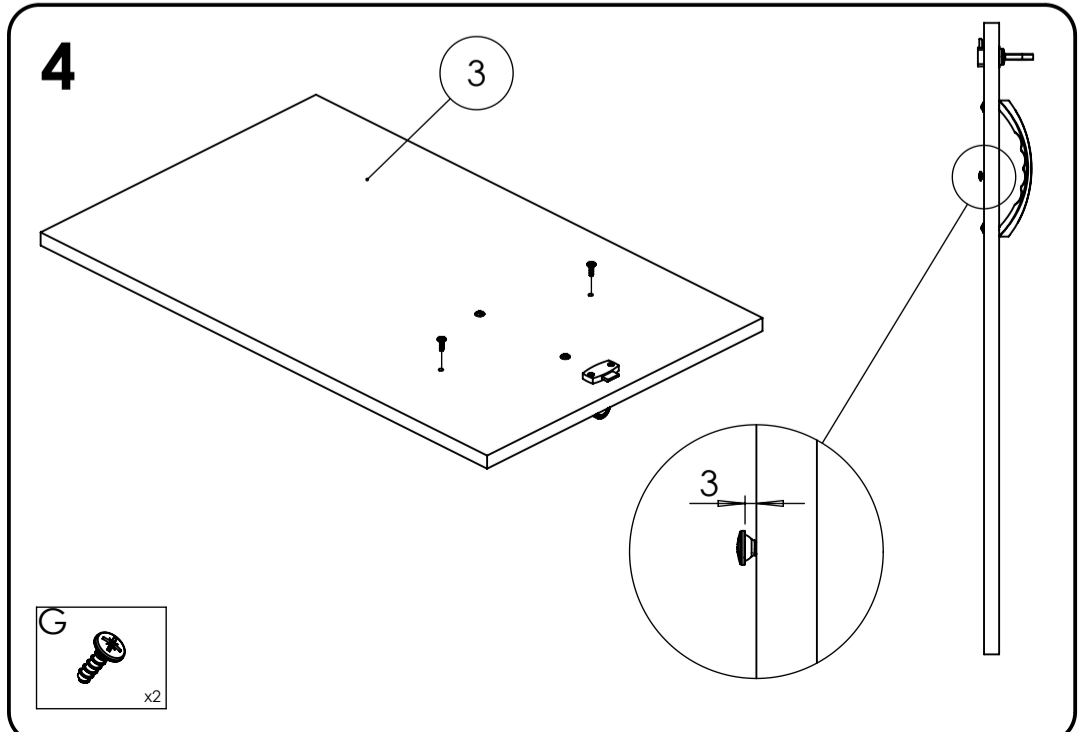
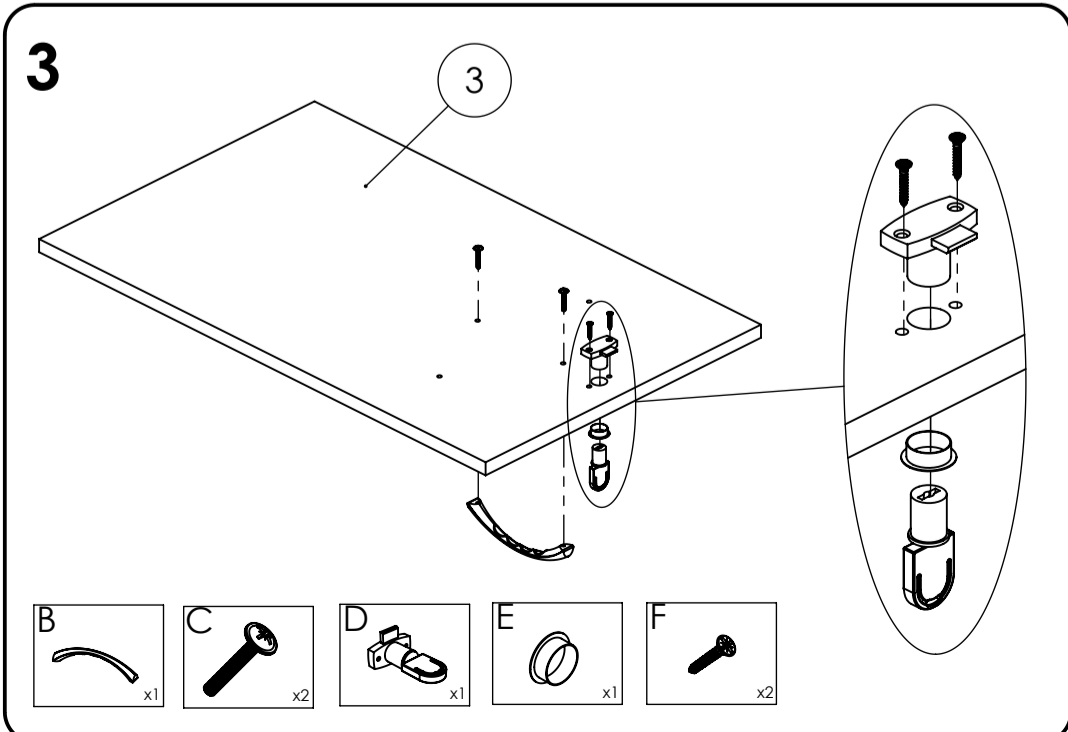
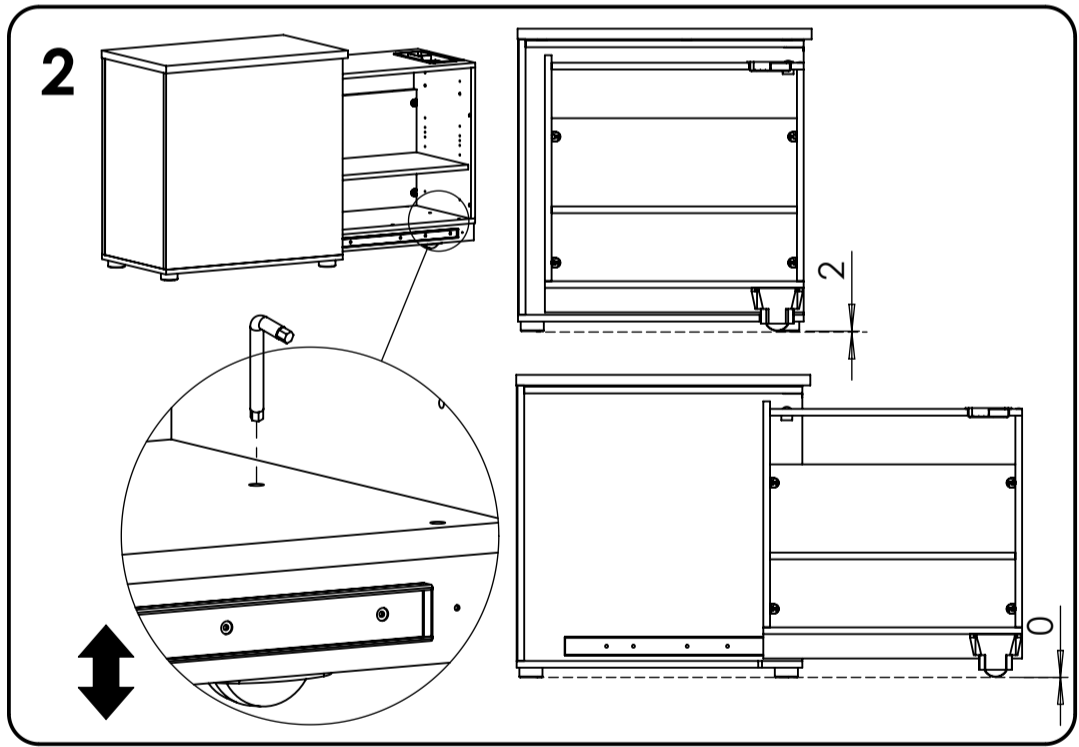
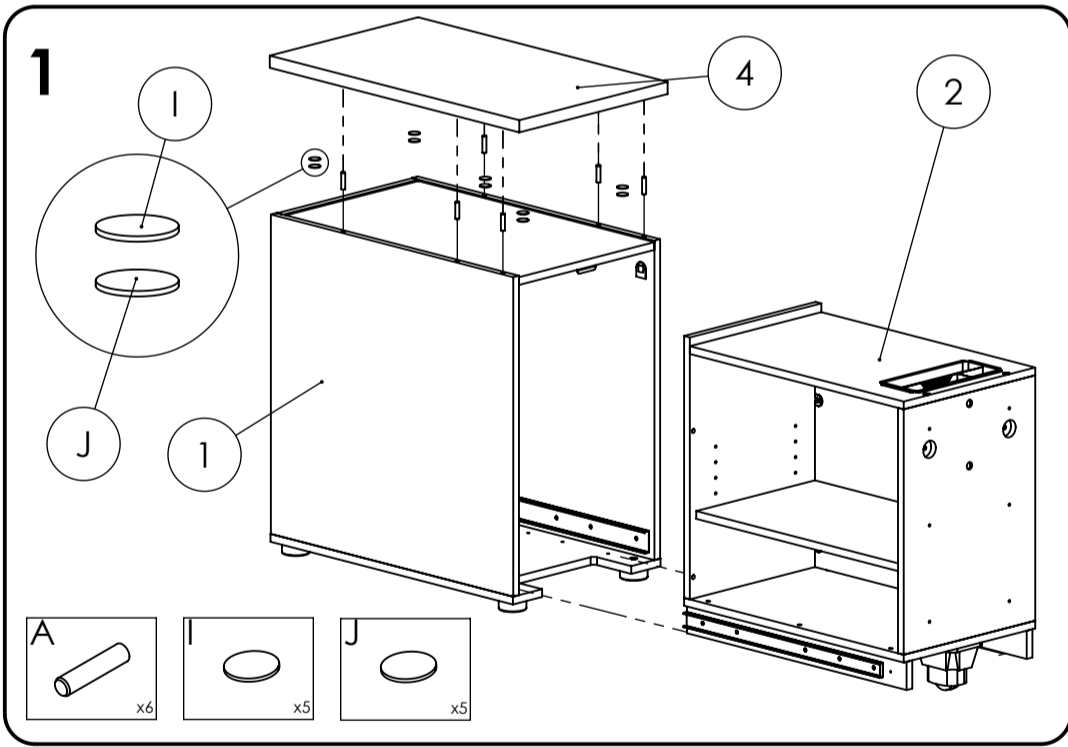
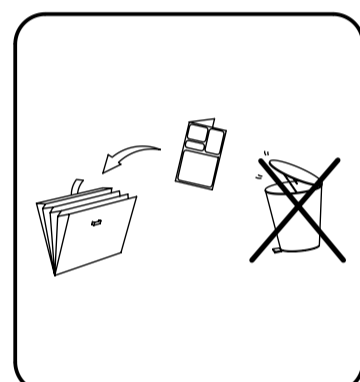
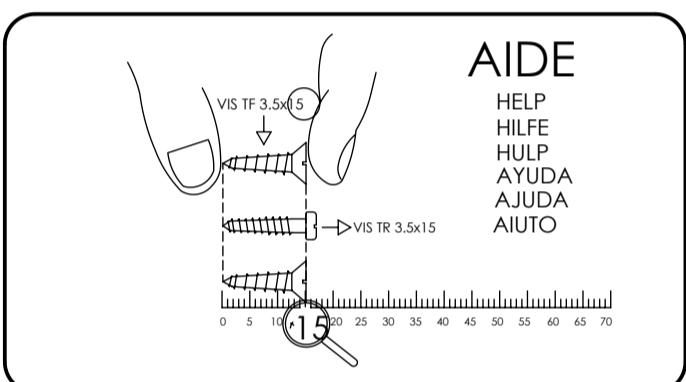

5

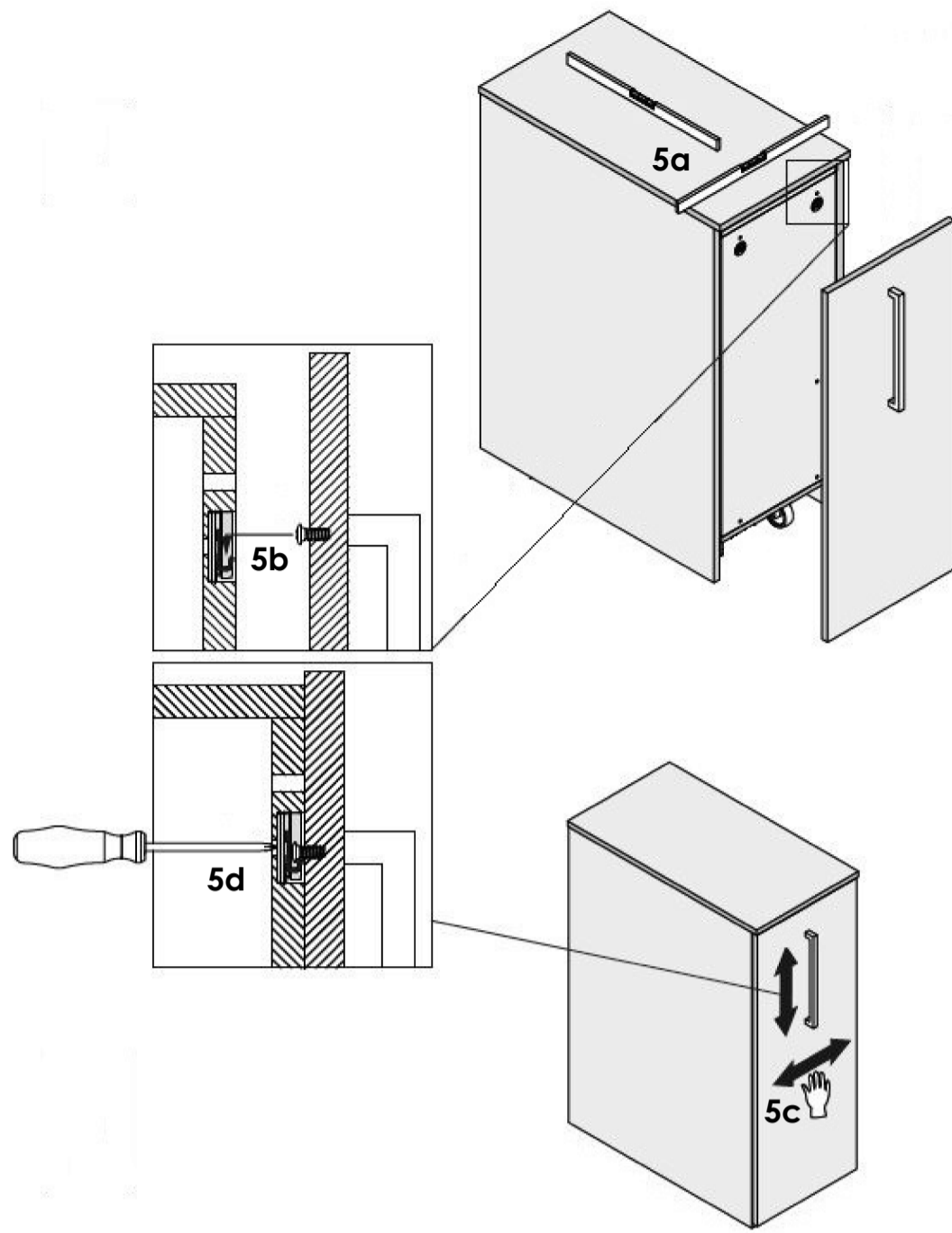

6

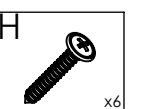
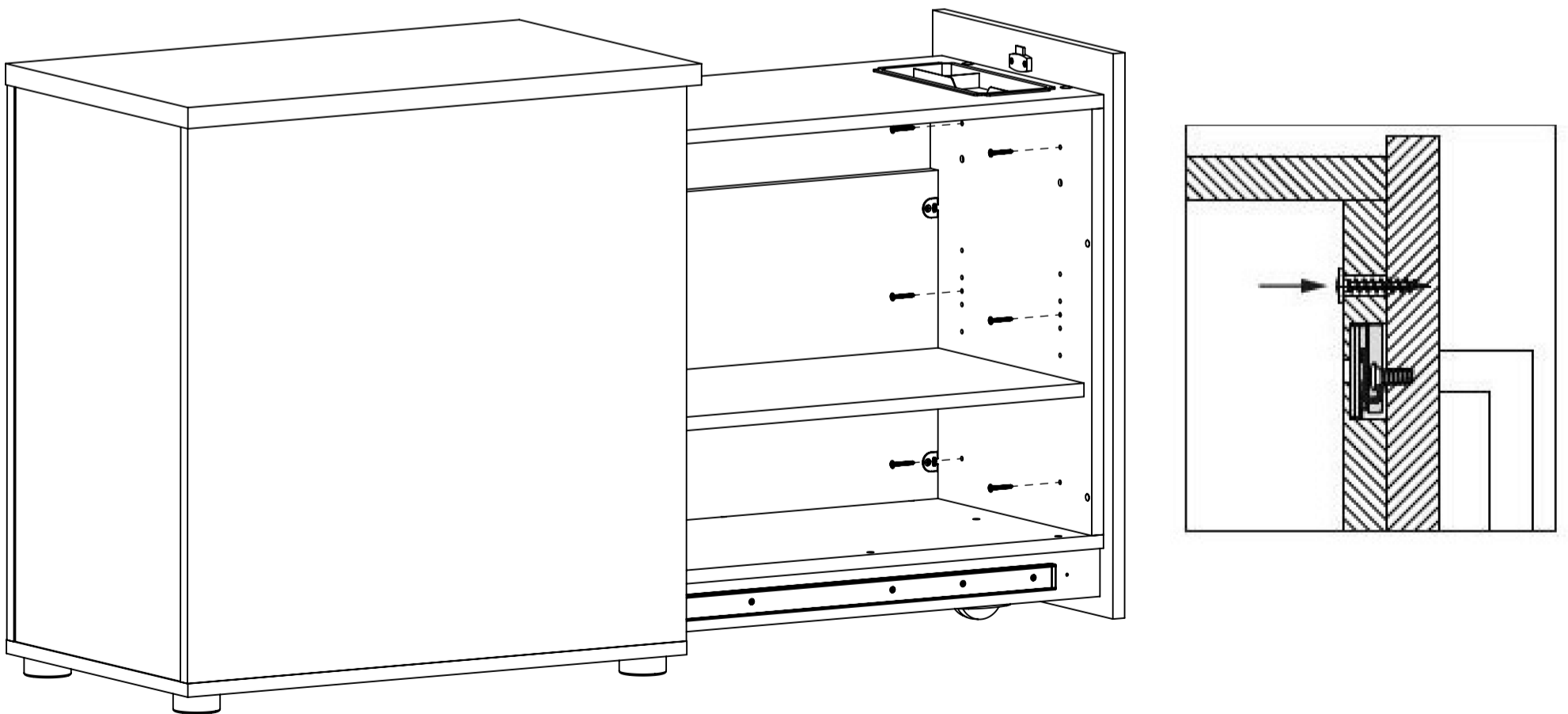

NOTICE DE MONTAGE
INSTRUCTIONS FOR ASSEMBLY
MONTAGEANLEITUNG
GEBRUIKSAANWIJZING
ISTRUZIONI DI MONTAGGIO
INSTRUCCIONES DE MONTAJE
INSTRUCOES DE MONTAGEM

buronomic
FABRICANT FRANÇAIS
N° DV40604/01

CONCEPTION ET REALISATION BUREAU D'ETUDES BURONOMIC

GARANTIE (viciis cachés)
_ Référence produit à nous communiquer impérativement en cas de litige :
Voir étiquette apposée au dos du produit

GARANTEE (defekt)
_ In the event of complaint, it is essential to mention the product reference :
See label affixed to the back of the product.

GARANTIE (fabrikationfehler)
_ Im streitfall sit uns die produktreferenz mitzuteilen :
Siehe etikett auf produktrückseite.

WAARBORG (de verborgen gebreken)
_ Vermeld in geval van klachten altijd het productnummer :
Zie label op de achterzijde van het product

GARANZIA (vizi occulte)
_ Specificare obbligatoriamente il riferimento prodotto in caso di contestazioni :
Si veda l'etichetta applicata dietro il prodotto

GARANTIA (defectos ocultos)
_ Referencia de producto citese obligatoriamente en caso de reclamacion :
Ver etiqueta en la parte posterior del producto.

GARANTIA (viciis ocultos)
_ Em caso de reclamacao indiqu-nos imperativamente a referencia do produto :
Ver etiqueta fixada na parte posterior do produto

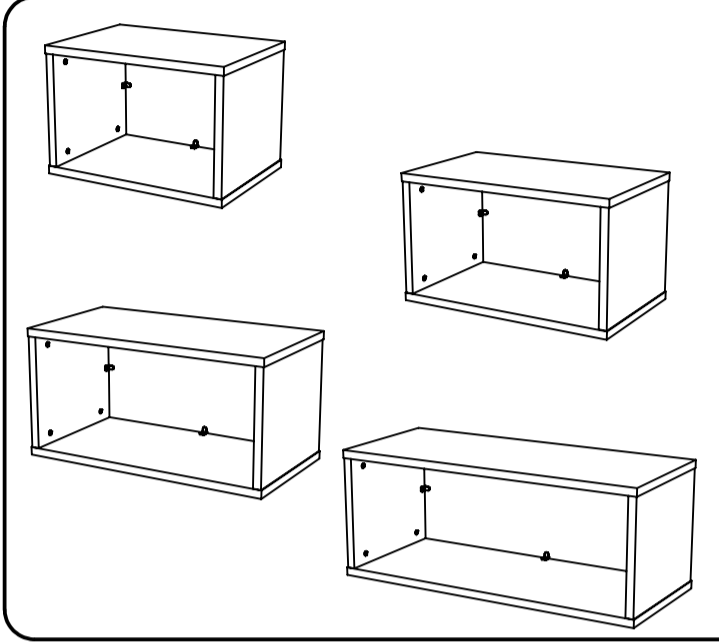
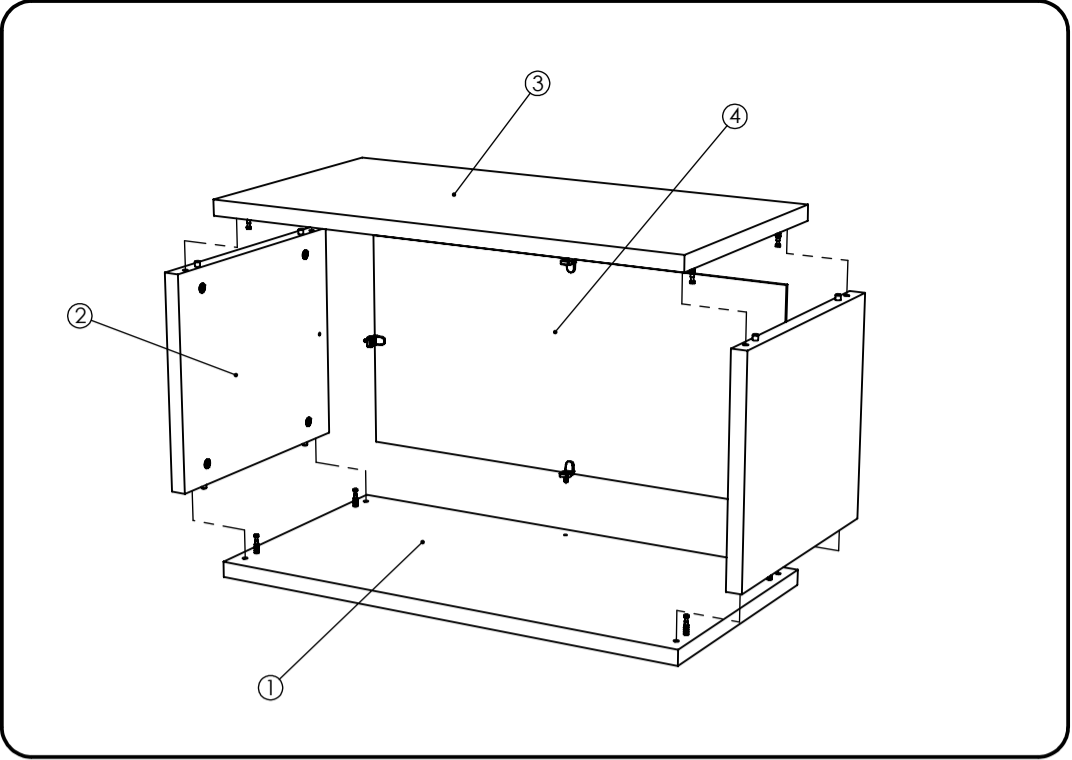

x1 25 Mn

NE PAS UTILISER :
 CRÈME À RECURER / CREAM TO CLEAN / PUTZMITTEL / SCHWÄMMER / CREMA LUCIDANTE / CREMA LAMPADORA / CREMA DESINGORBIANTE / DISOLVENTE / DISOLVENTE / DISOLVENTE

UTILISER :
 ALCOOL A BRISSE / METHYLATED SPIRITS / BRANDESPRITUS / ETANOL / ALCOHOL DE QUEMAR / ALCOOL ETUICO / CHIFFON DOUX / SOFT RAG / LAPPEN / ZACHTE DOEK / PANNINO MORBIDO / FANGO MASCIO / SAVON / SOAP / SEIFE / JABON / SABAO / CIRE / WAX / WACHS / WAS / CERA

NOMENCLATURE (Parts list)
(Stückliste)
(Onderdelenlijst)
(Nomenclatura)
(Lista de peças)

Rep.	Pièce	Qté
1	Fond	1
2	Coté	2
3	Dessus	1
4	PAR Plexiglass 4 mm dépoli blanc	1

QUINCAILLERIE (Hardware)
(Beschläge)
(Ijzerwaren)
(Ferrajes)
(Quinquilharia)

Rep.	Pièce	Qté	A	B	C
A	Goujon métal	8			
B	Excentrique Ø15	8			
C	Support PAR	4			
D	Cache excent.	8			
E	Vis Euro Std	4			
			G	H	I
			J	K	L
			M	N	O
			P	Q	R

AIDE
HELP
HILFE
HULP
AYUDA
AJUDA
AIUTO

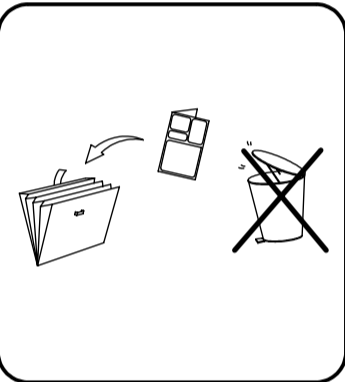

1

A x8 **B** x8

2

3

C x8

4

E x4

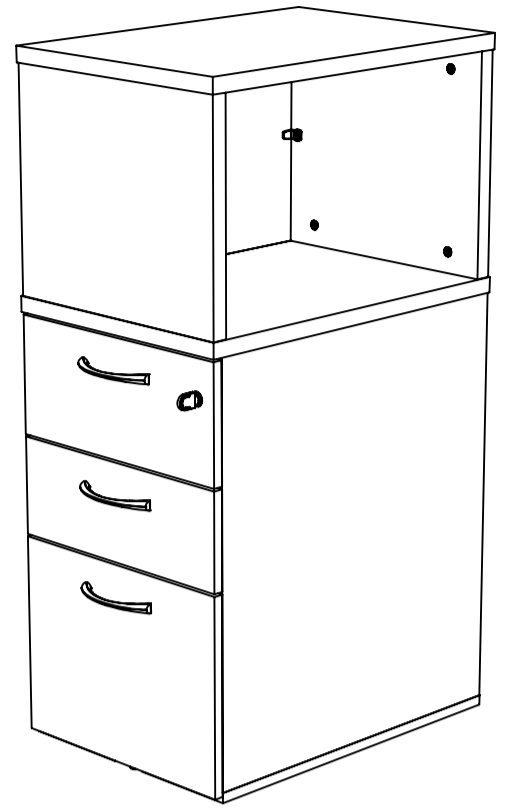
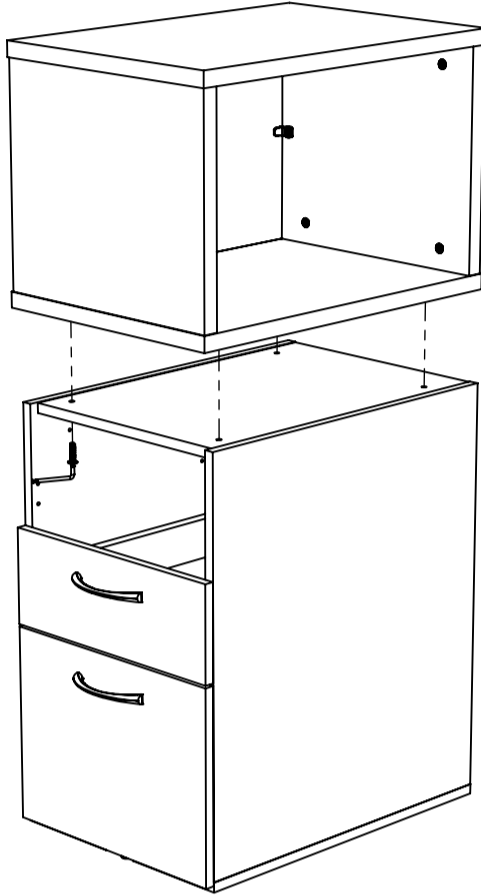

Pièce	Qté
Vis TRL M6x30	4
Clé 6 pans 4mm	1

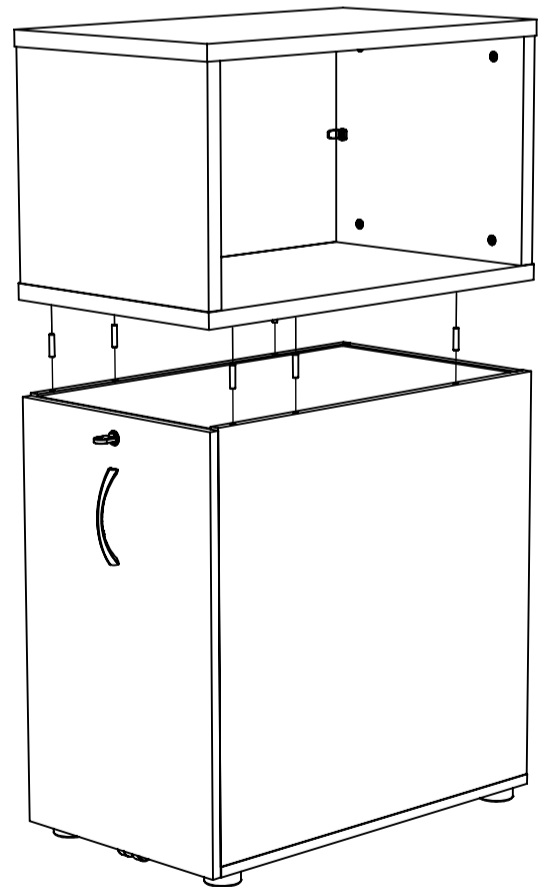
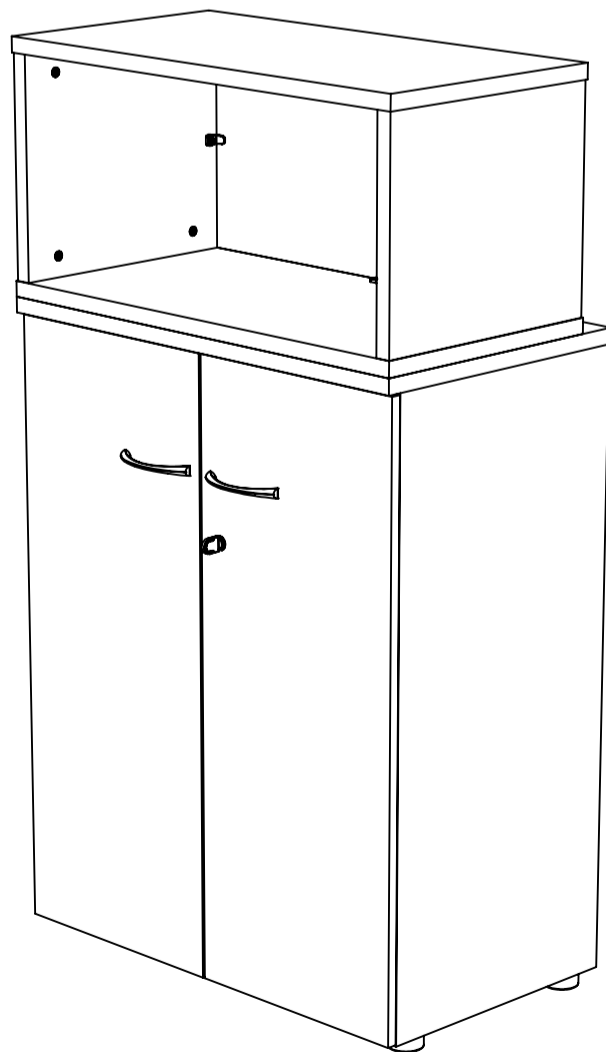
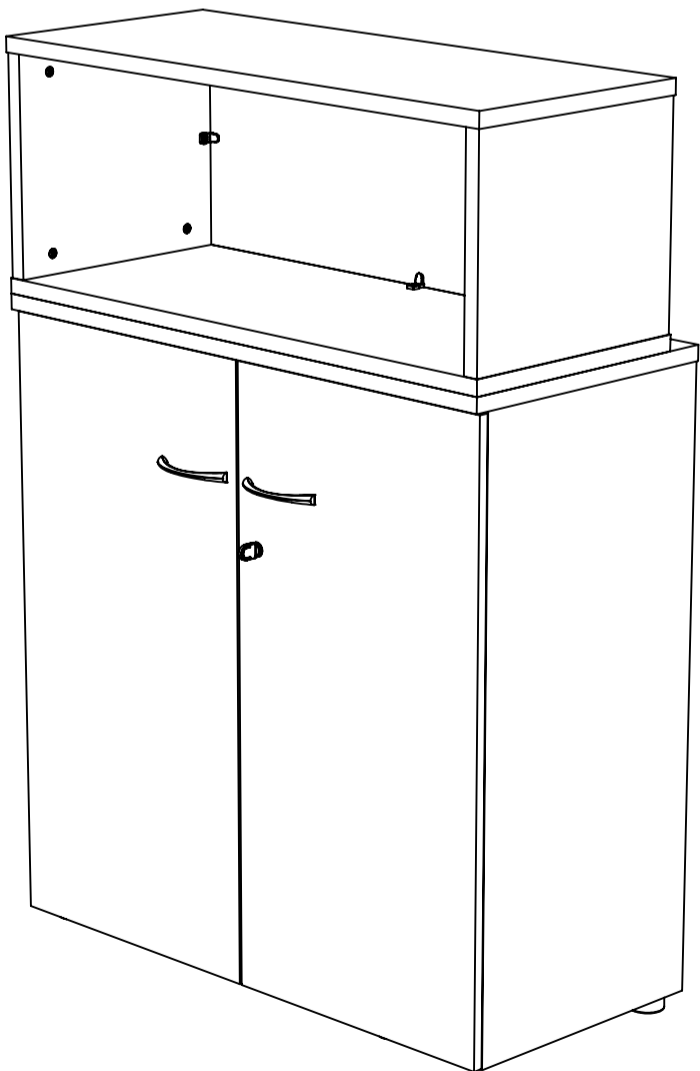
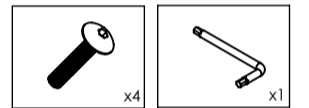

Pièce	Qté
Tourillon 7,8x35	6

