

NOTICE DE MONTAGE  
INSTRUCTIONS FOR ASSEMBLY  
MONTAGEANLEITUNG  
GEBRUIKSAANWIJZING  
ISTRUZIONI DI MONTAGGIO  
INSTRUCCIONES DE MONTAJE  
INSTRUCCOES DE MONTAGEM

**buronomic**  
FABRICANT FRANÇAIS

N° DV40816

CONCEPTION ET REALISATION BUREAU D'ETUDES BURONOMIC

**GARANTIE** (vices cachés)  
\_ Référence produit à nous communiquer impérativement en cas de litige :  
Voir étiquette apposée au dos du produit

**GARANTIE** (defekt)  
\_ In the event of complaint, it is essential to mention the product reference :  
See label affixed to the back of the product.

**GARANTIE** (fabrikationsfehler)  
\_ Im streifall sit uns die produktreferenz mitzuteilen :  
Siehe etikett auf produktseite.

**WAARBORG** (de verborgen gebreken)  
\_ Vermeld in geval van klachten altijd het productnummer :  
Zie label op de achterzijde van het product

**GARANZIA** (vizi occulti)  
\_ Specificare obbligatoriamente il riferimento prodotto in caso di contestazioni :  
Si veda l'etichetta applicata dietro il prodotto

**GARANTIA** (defectos ocultos)  
\_ Referencia de producto citese obligatoriamente en caso de reclamacion :  
Ver etiqueta en la parte posterior del producto.

**GARANTIA** (vices ocultos)  
\_ Em caso de reclamacao indiqu-nos imperativamente a referencia do produto :  
Ver etiqueta fixada na parte posterior do produto

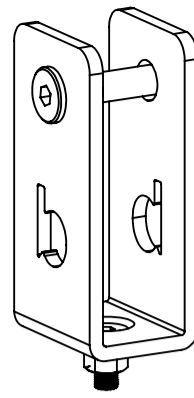

KIT A  
x2

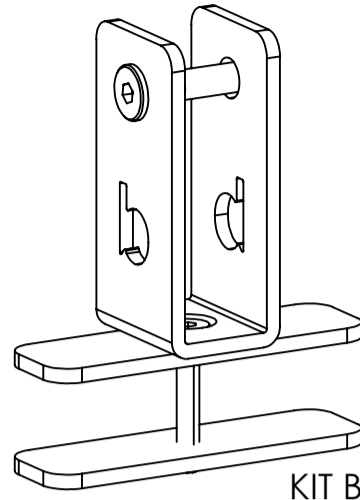

KIT B  
x2

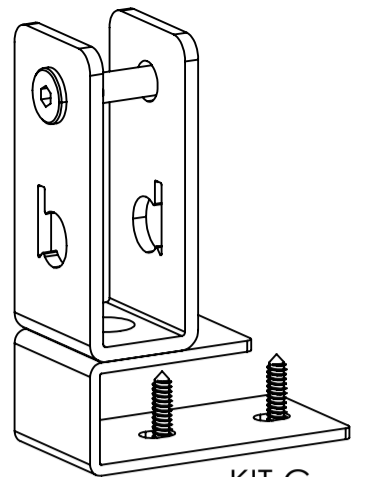

KIT C  
x2

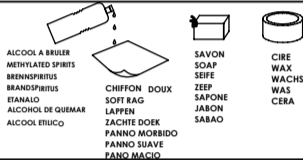
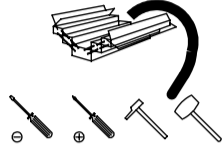
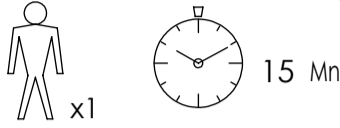
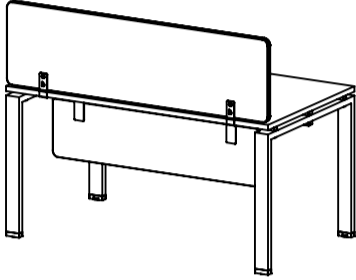
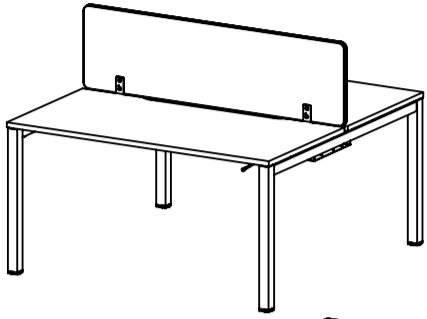

**QUINCAILLERIE**

(Hardware)  
(Beschlage)  
(Ijzerwaren)  
(Ferramentas)  
(Herrajes)  
(Quinquilharia)

	REP.	PIECE	QTÉ	A	B	C	D
<b>KIT A</b>	A	VIS M8X29	2				
	B	DOUILLE M8	2				
	C	FIXATION U	2				
	D	VIS TFHC M6X16	2				
	E	ECROU M6	2				
	REP.	PIECE	QTÉ	E	F	G	H
<b>KIT B</b>	A	VIS M8X29	2				
	B	DOUILLE M8	2				
	C	FIXATION U	2				
	F	PLATINE Ø7	2				
	G	PLATINE M6	2				
H	VIS TFHC M6X40	2					
	REP.	PIECE	QTÉ	I	J		
<b>KIT C</b>	A	DOUILLE M8	2				
	B	VIS M8X29	2				
	I	FIXATION SOLO	2				
J	VIS TCB 5 X20	4					

**AIDE**

HELP  
HILFE  
HULP  
AYUDA  
AJUDA  
AIUTO

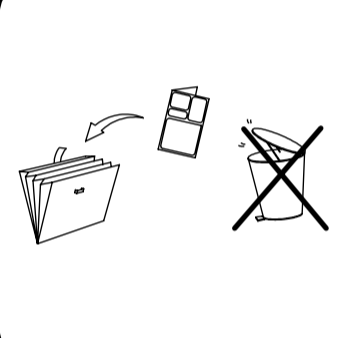
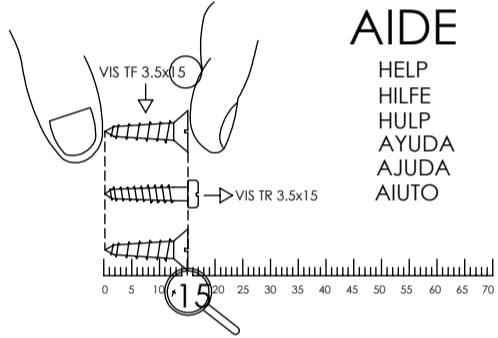

**KIT A - BENCH COULISSANT**

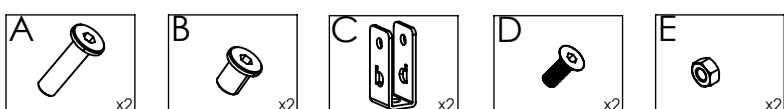
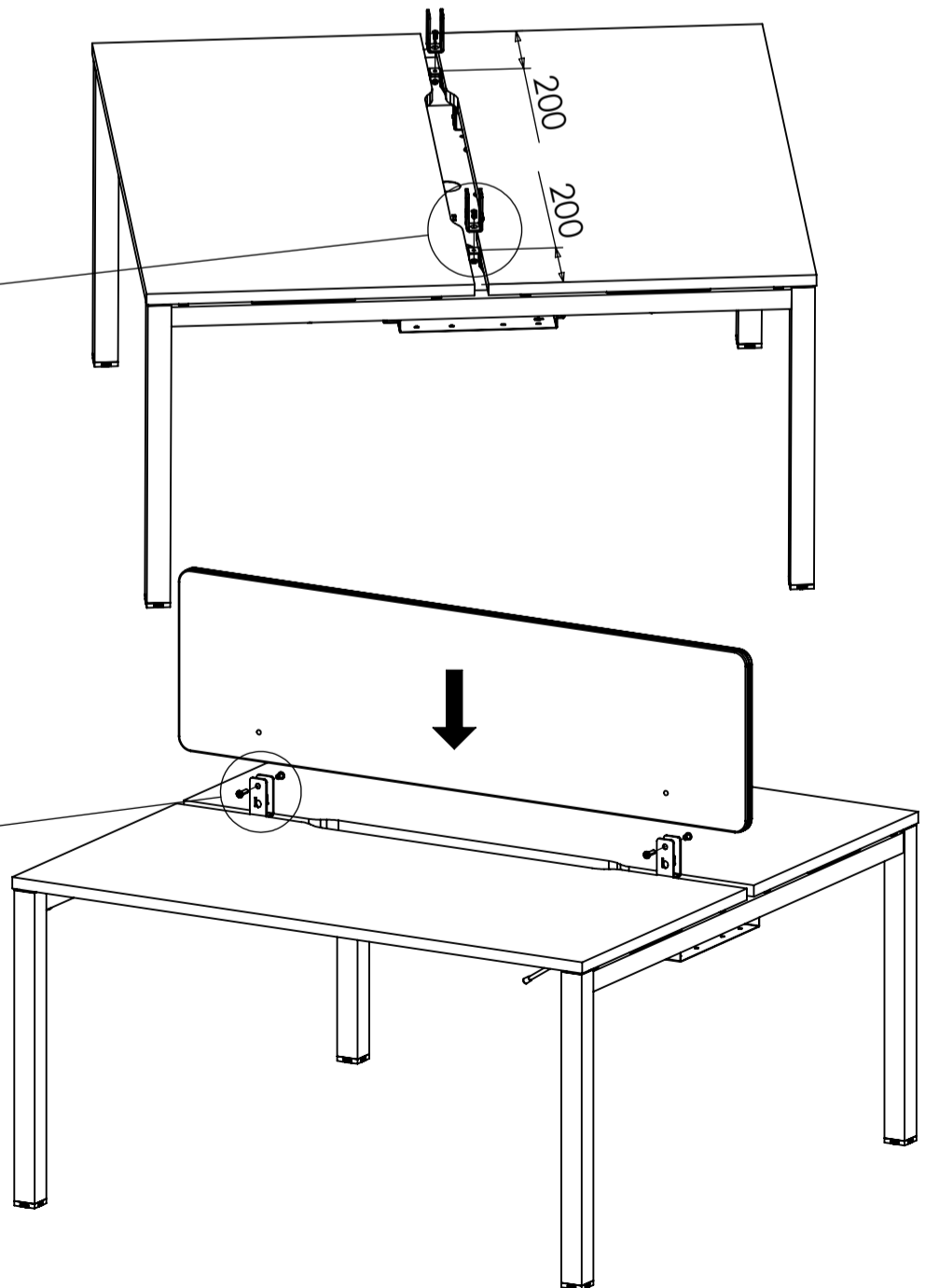
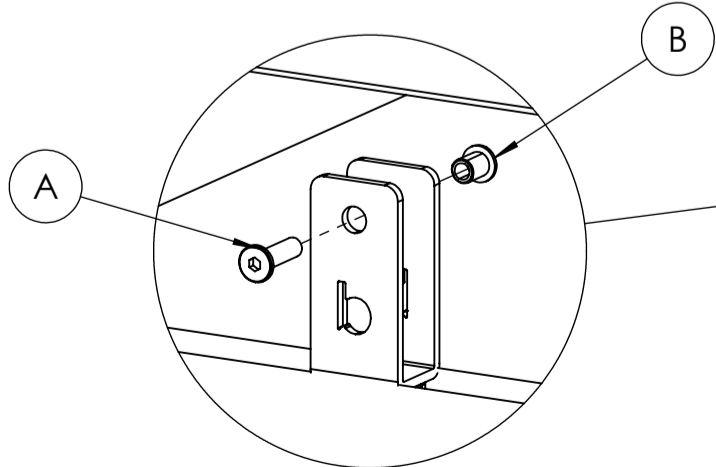
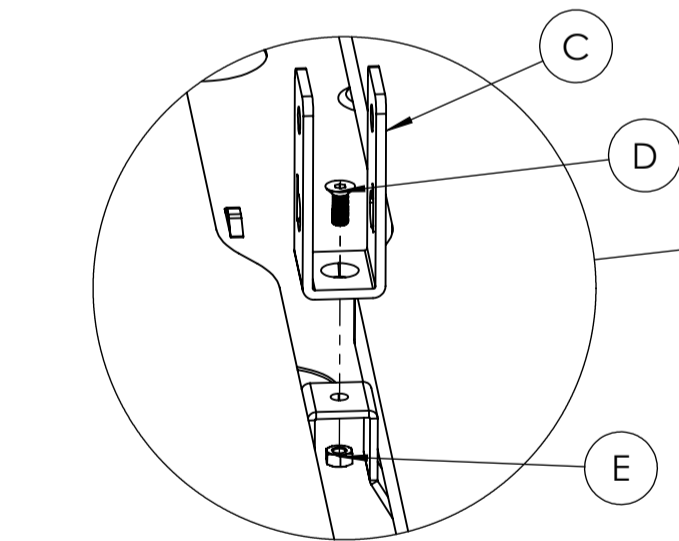

# KIT B - BENCH FIXE

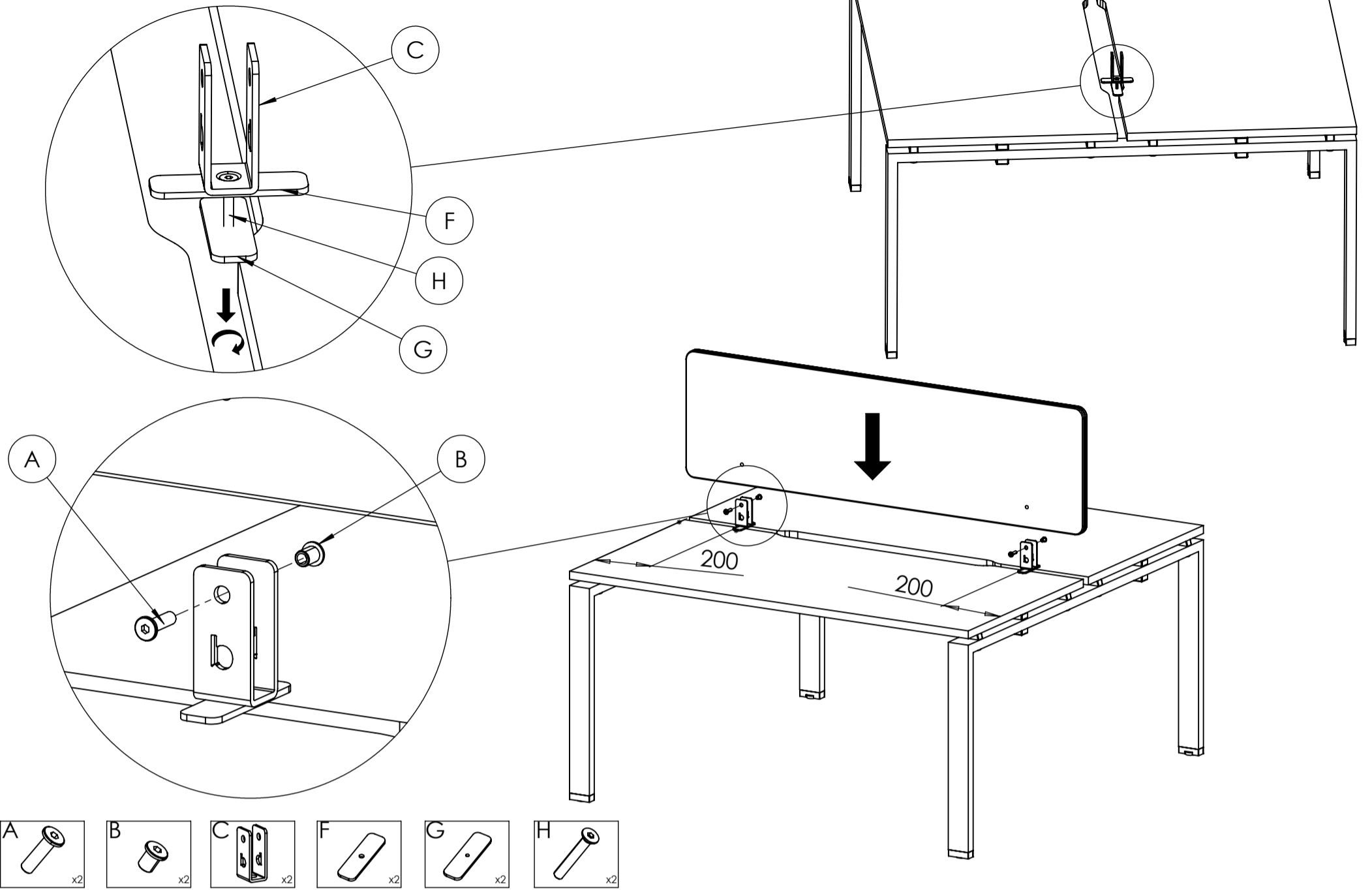

# KIT C - SOLO

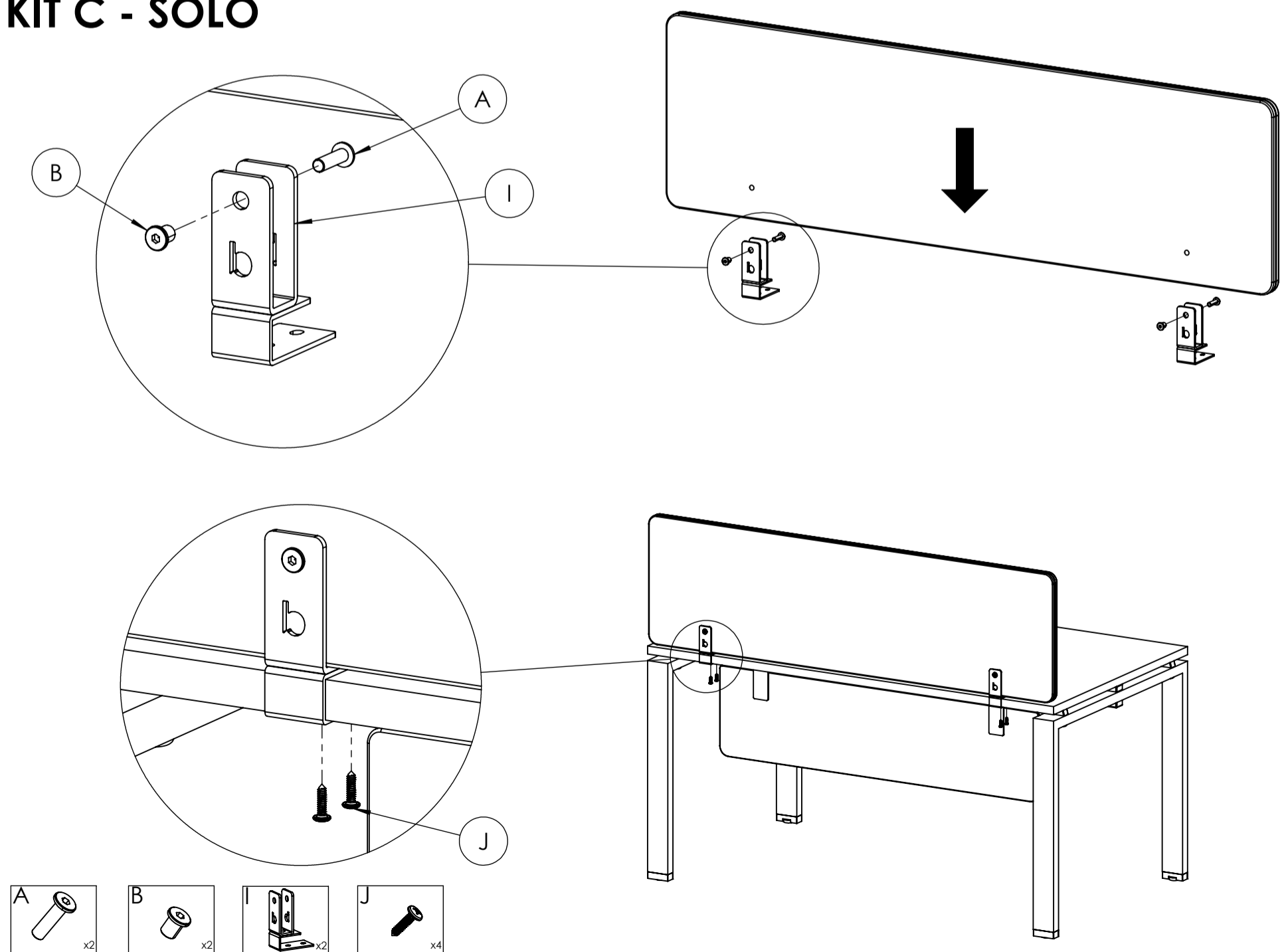

NOTICE DE MONTAGE  
INSTRUCTIONS FOR ASSEMBLY  
MONTAGEANLEITUNG  
GEBRUIKSAANWIJZING  
ISTRUZIONI DI MONTAGGIO  
INSTRUCCIONES DE MONTAJE  
INSTRUCCOES DE MONTAGEM

**buronomic**

FABRICANT FRANÇAIS

N° DV40837

CONCEPTION ET REALISATION BUREAU D'ETUDES BURONOMIC

**GARANTEE** (vices cachés)  
\_ Référence produit à nous communiquer impérativement en cas de litige :  
Voir étiquette apposée au dos du produit

**GARANTEE** (defekt)  
\_ In the event of complaint, it is essential to mention the product reference :  
See label affixed to the back of the product.

**GARANTIE** (fabrikatorfelhar)  
\_ Im streitfall sit uns die produktreferenz mitzuteilen :  
Siehe etikett auf produktruckseite.

**WAARBORG** (de verborgen gebreken)  
\_ Vermeld in geval van klachten altijd het productnummer :  
Zie label op de achterzijde van het product

**GARANZIA** (vizi occulti)  
\_ Specificare obbligatoriamente il riferimento prodotto in caso di contestazioni :  
Si veda l'etichetta applicata dietro il prodotto

**GARANTIA** (defectos ocultos)  
\_ Referencia de producto citese obligatoriamente en caso de reclamacion :  
Ver etiqueta en la parte posterior del producto.

**GARANTIA** (vicios ocultos)  
\_ Em caso de reclamacao indiqu-nos imperativamente a referencia do produto :  
Ver etiqueta fixada na parte posterior do produto

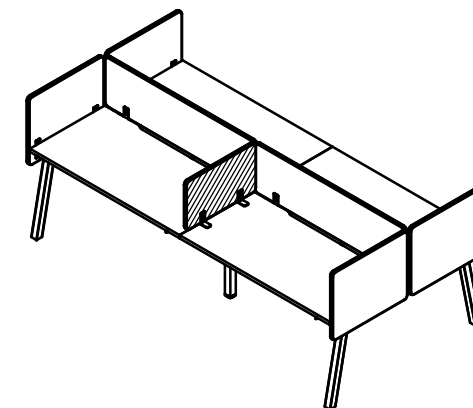
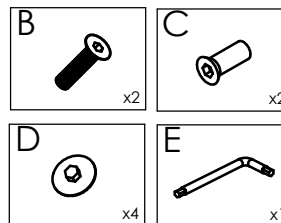
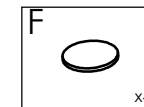
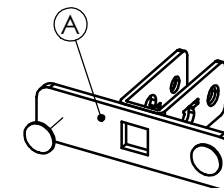
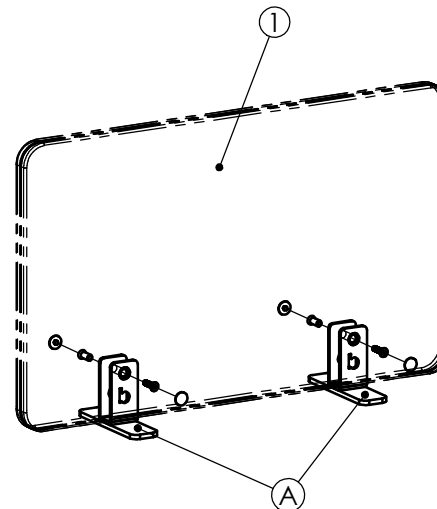
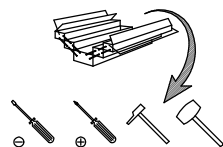
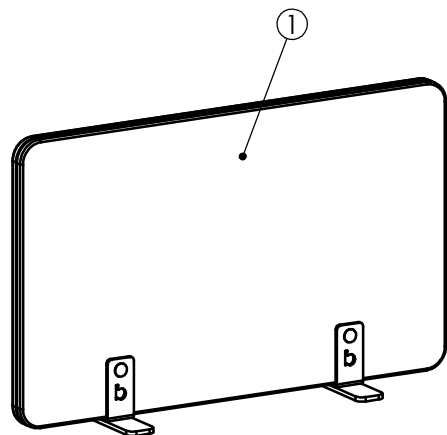

**NOMENCLATURE**

(Parts list)  
(Stückliste)  
(Onderdelenlijst)  
(Nomenclatura)  
(Lista de peças)

Rep.	Pièce	Qté
1	ECRAN LATERAL	1

**QUINCAILLERIE**

(Hardware)  
(Beschiège)  
(Ijzerwaren)  
(Ferramentas)  
(Herrajes)  
(Quinquilharia)

Rep.	Pièce	Qté	A	B	C	D	E	F	G	H	I	K	L	M
A	FIXATION U	2												
B	Vis TFHC M6x25	2												
C	Ecrou fraisé M6 lg20 Ø8	2												
D	Cache	4												
E	Clé 6 pans 4mm	2												
F	Pastille anti-dérapante	4												

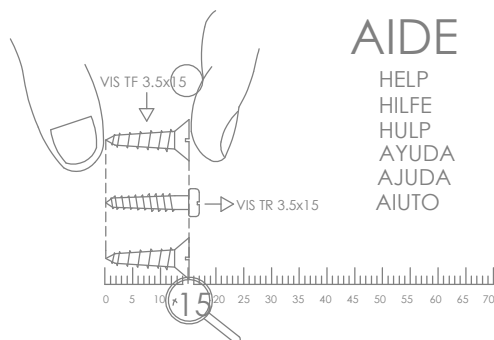

**AIDE**

HELP  
HILFE  
HULP  
AYUDA  
AJUDA  
AIUTO

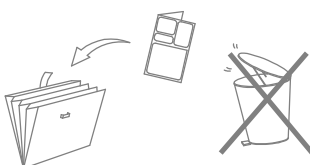

NOTICE DE MONTAGE  
INSTRUCTIONS FOR ASSEMBLY  
MONTAGEANLEITUNG  
GEBRUIKSAANWIJZING  
ISTRUZIONI DI MONTAGGIO  
INSTRUCCIONES DE MONTAJE  
INSTRUÇÕES DE MONTAGEM

**buronomic**  
FABRICANT FRANÇAIS

N° DV40834/01

CONCEPTION ET REALISATION BUREAU D'ETUDES BURONOMIC

**GARANTIE** (vices cachés)  
\_ Référence produit à nous communiquer impérativement en cas de litige :  
Voir étiquette apposée au dos du produit

**GARANTEE** (defekt)  
\_ In the event of complaint, it is essential to mention the product reference :  
See label affixed to the back of the product.

**GARANTIE** (fabrikationsfeil)  
\_ Im streifall sit uns die produktreferenz mitzuteilen :  
Siehe etikett auf produktseite.

**WAARBORG** (de verborgen gebreken)  
\_ Vermeld in geval van klachten altijd het productnummer :  
Zie label op de achterzijde van het product

**GARANZIA** (vizi occulti)  
\_ Specificare obbligatoriamente il riferimento prodotto in caso di contestazioni :  
Si veda l'etichetta applicata dietro il prodotto

**GARANTIA** (defectos ocultos)  
\_ Referencia de producto citese obligatoriamente en caso de reclamacion :  
Ver etiqueta en la parte posterior del producto.

**GARANTIA** (vices ocultas)  
\_ Em caso de reclamacao indiq-nos imperativamente a referencia do produto :  
Ver etiqueta fixada na parte posterior do produto

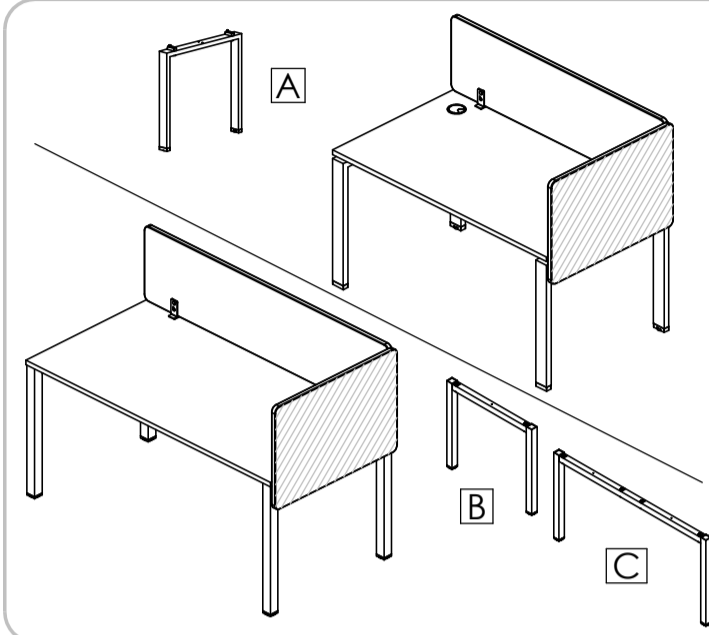

x1

10 Mn

CHIFFON DOUX  
SOFT RAG  
ZACHTE DOEK  
FANNO MORBIDO  
FANNO SUAVE  
PANO MACIO

SAVON  
SOAP  
SEIFE  
SAPONE  
JABON  
SABAO

CIRE  
WAX  
WACHS  
WAS  
CERA

ALCOOL A BRUIER  
METHYLATED SPIRITS  
BRANDSPIRITS  
ESANILIO  
ALCOHOL DE QUEMAR  
ALCOOL ETILICO

CHIFFON SEC  
PUTZTUEL  
SCHWAMPÖSSE  
CREMA SUCIARIE  
CREMA UMPIADORA  
CREMA DESINGORDURANTE

DEBANT  
PRODUCT DILUTED  
VERDUNNUNG  
VERDUNNUNGSMIDDEL  
DILUENTE  
DISOLVENTE

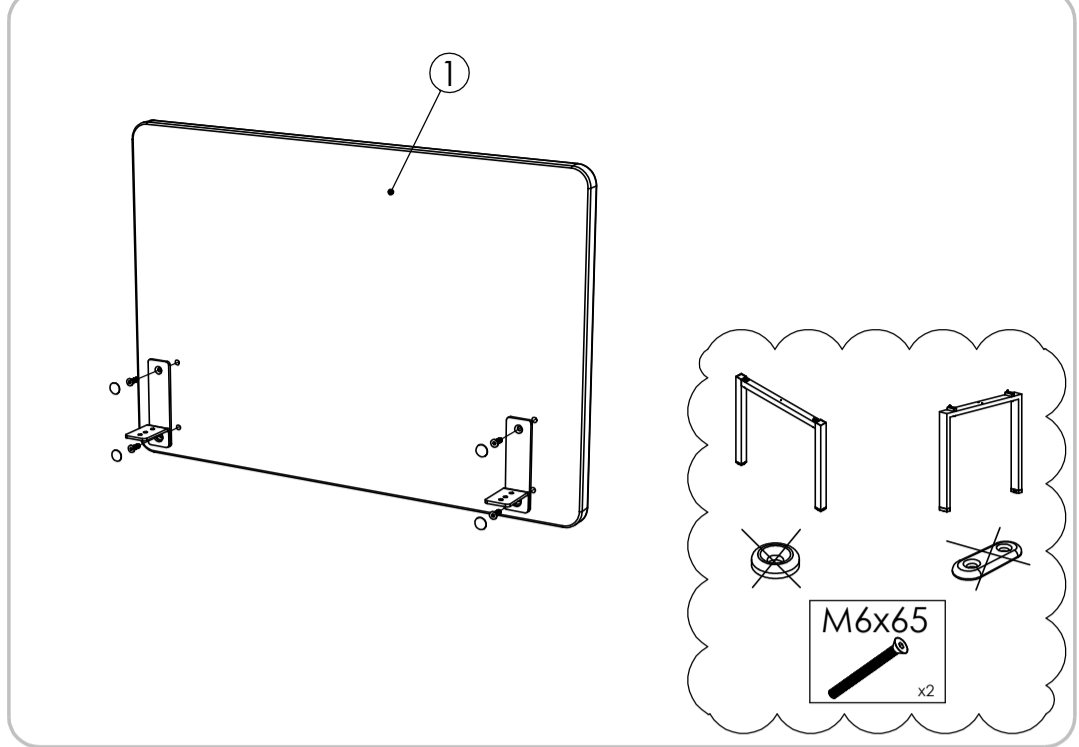

**NOMENCLATURE** (Parts list)  
(Stückliste)  
(Onderdelenlijst)  
(Nomenclatura)  
(Lista de peças)

Rep.	Pièce	Qté
1	ECRAN LATERAL	1

**QUINCAILLERIE** (Hardware)  
(Beschläge)  
(Ijzerwaren)  
(Ferramentas)  
(Herrajes)  
(Quinquilharia)

Rep.	Pièce	Qté	A	B	C
A	Support écran	2			
C	Vis TFHC M6x20	4			
D	Cache	4			
E	Clé 6 pans 4mm	1			
Rep.	Pièce	Qté	G	H	I
F	Vis TFHC M6x40	2			
G	Ecrou fraisé M6 lg20 Ø8	2			
			J	K	L
			M	N	O
			P	Q	R

**AIDE**  
HELP  
HILFE  
HULP  
AYUDA  
AJUDA  
AIUTO

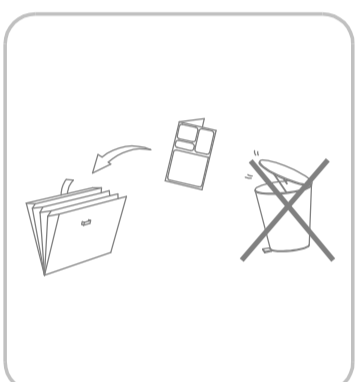

**1/A**

M6x65 x2

E x1

**1/B**

M6x65 x2

E x1

**1/C**

M6x65 x2

E x1

**1/C Coulissant**

F x2

G x2

2

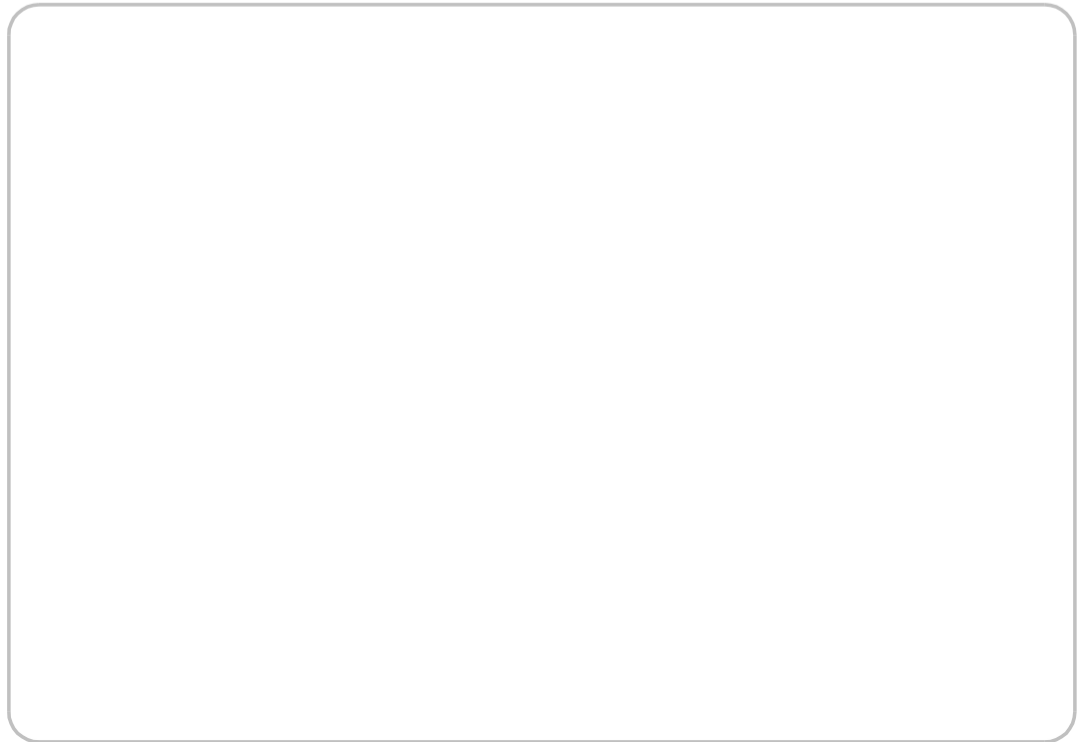
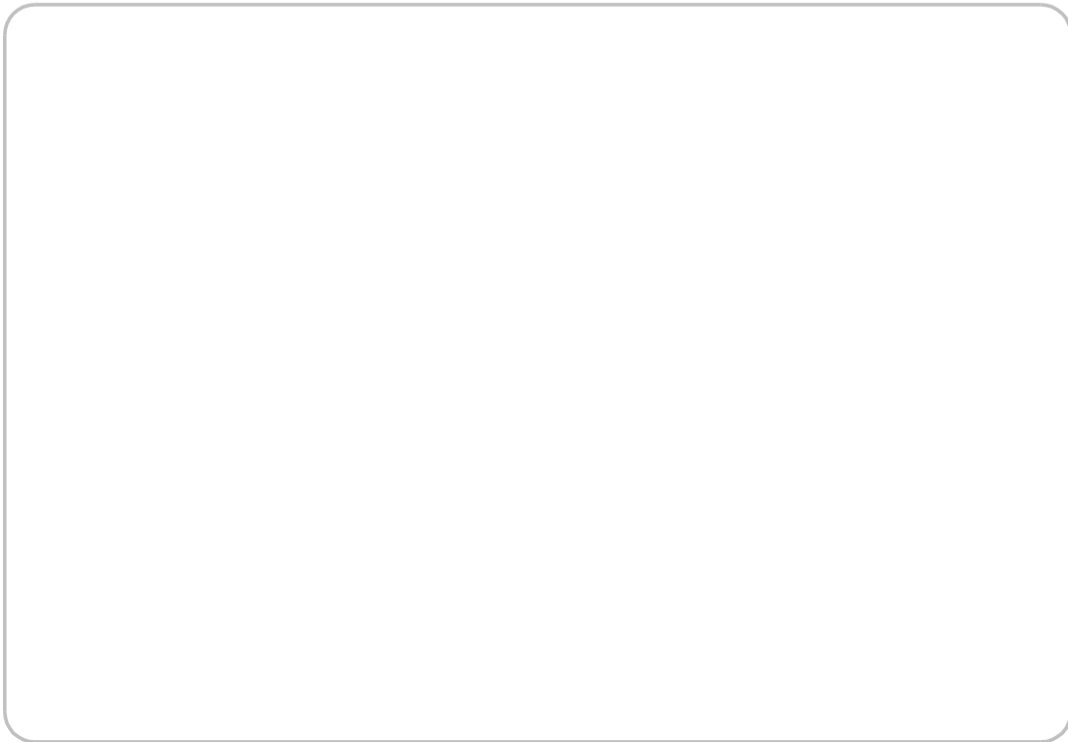
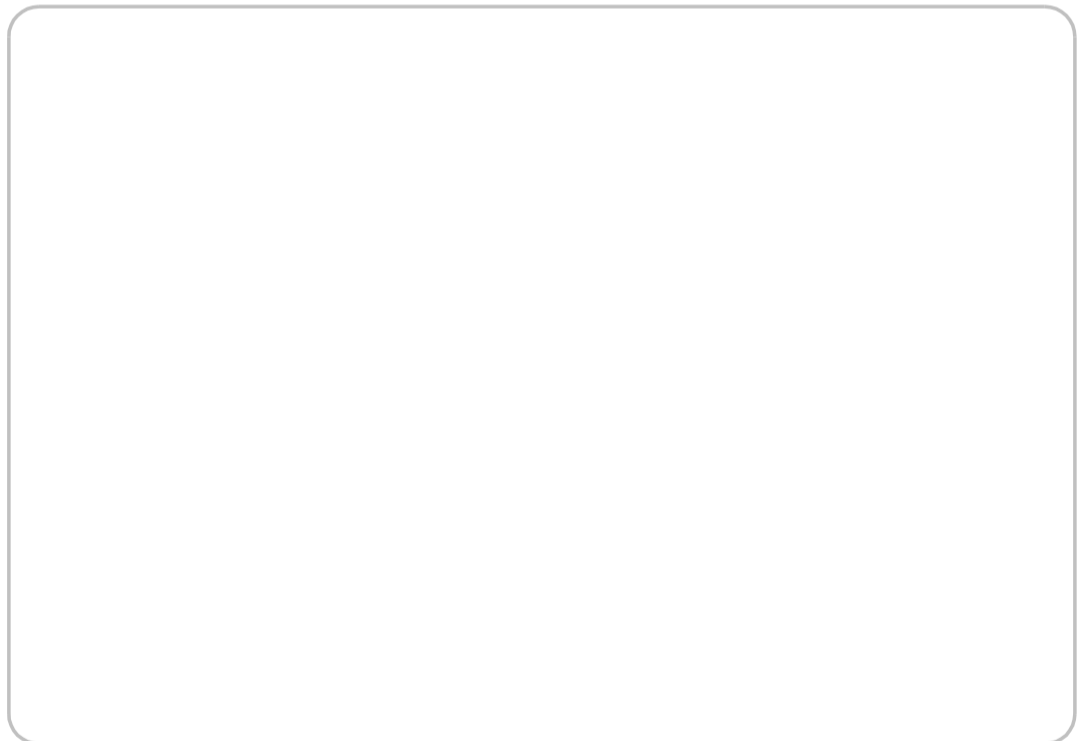
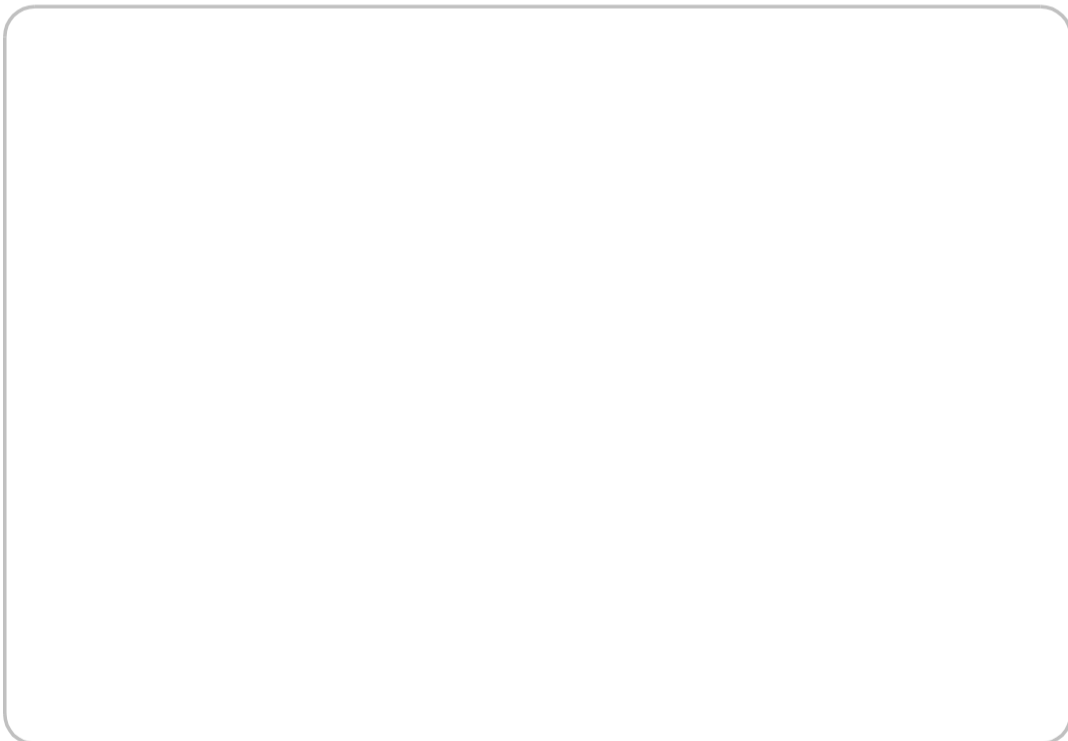
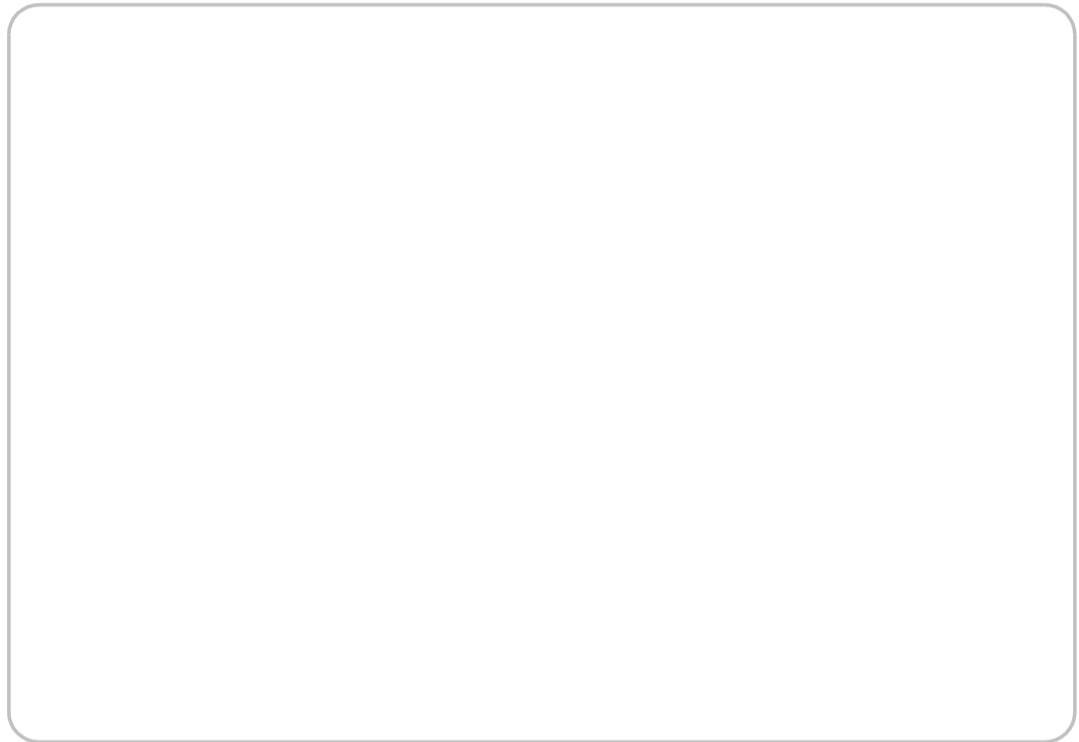
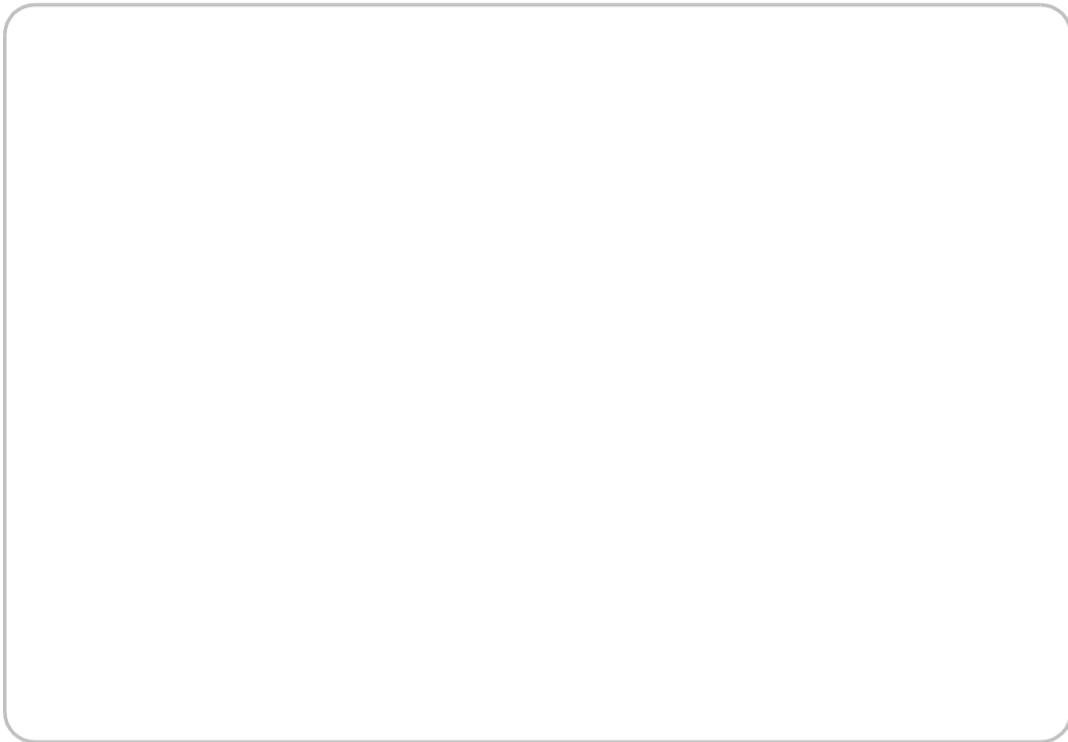
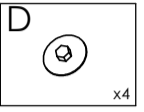
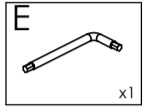
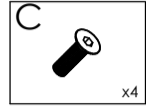
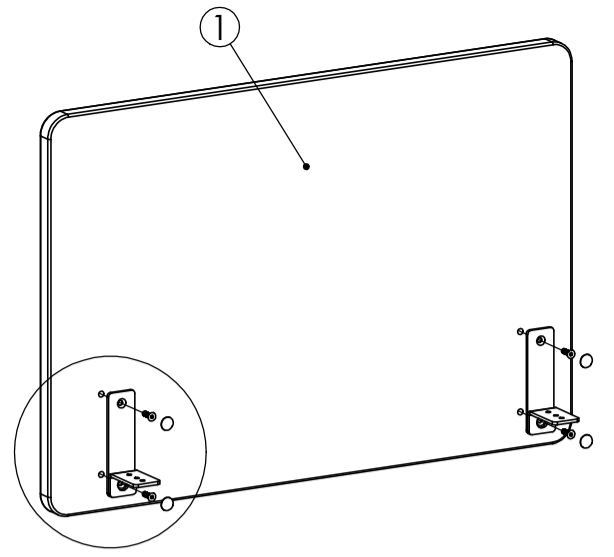
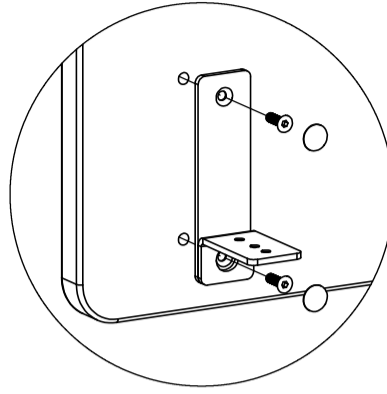
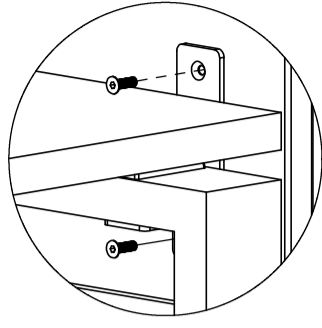
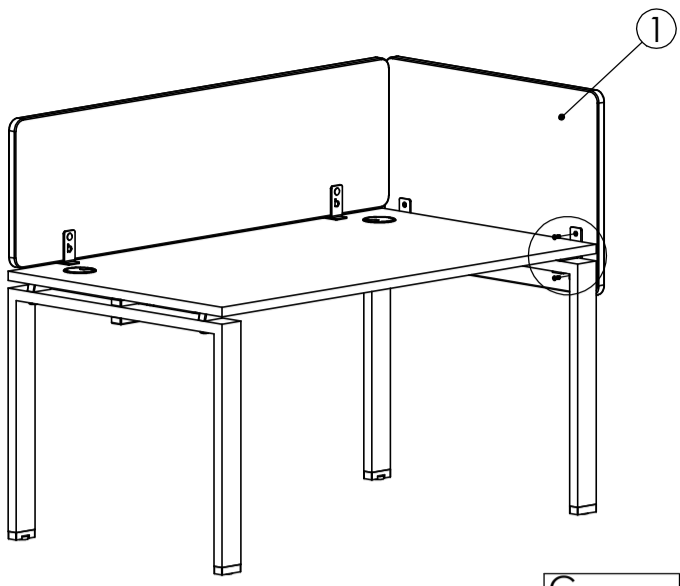

NOTICE DE MONTAGE  
INSTRUCTIONS FOR ASSEMBLY  
MONTAGEANLEITUNG  
GEBRUIKSAANWIJZING  
ISTRUZIONI DI MONTAGGIO  
INSTRUCCIONES DE MONTAJE  
INSTRUCCOES DE MONTAGEM

**buronomic**

FABRICANT FRANÇAIS

N° DV40835

CONCEPTION ET REALISATION BUREAU D'ETUDES BURONOMIC

**GARANTEE** (vices cachés)  
\_ Référence produit à nous communiquer impérativement en cas de litige :  
Voir étiquette apposée au dos du produit

**GARANTEE** (defekt)  
\_ In the event of complaint, it is essential to mention the product reference :  
See label affixed to the back of the product.

**GARANTIE** (fabrikationfelher)  
\_ Im streitfall sit uns die produktreferenz mitzuteilen :  
Siehe etikett auf produkdruckseite.

**WAARBORG** (de verborgen gebreken)  
\_ Vermeld in geval van klachten altijd het productnummer :  
Zie label op de achterzijde van het product

**GARANZIA** (vizi occulti)  
\_ Specificare obbligatoriamente il riferimento prodotto in caso di contestazioni :  
Si veda l'etichetta applicata dietro il prodotto

**GARANTIA** (defectos ocultos)  
\_ Referencia de producto citese obligatoriamente en caso de reclamacion :  
Ver etiqueta en la parte posterior del producto.

**GARANTIA** (vícios ocultos)  
\_ Em caso de reclamacao indiq-nos imperativamente a referência do produto :  
Ver etiqueta fixada na parte posterior do produto

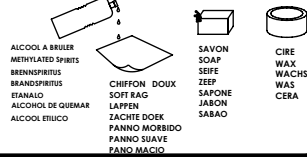
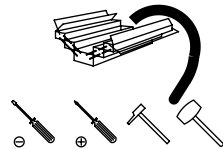
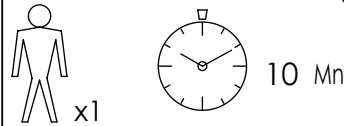
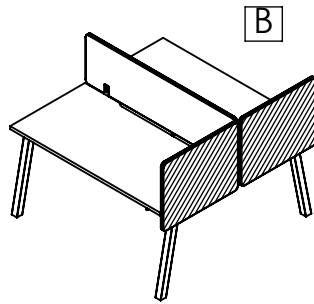
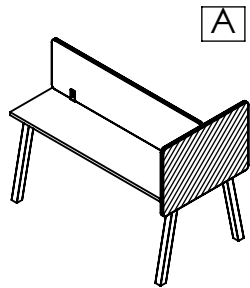

## AIDE

HELP  
HILFE  
HULP  
AYUDA  
AJUDA  
AIUTO

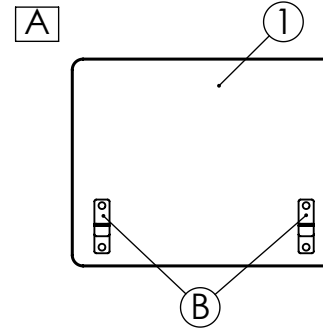
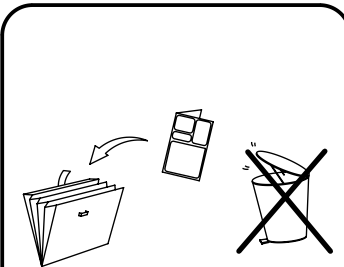
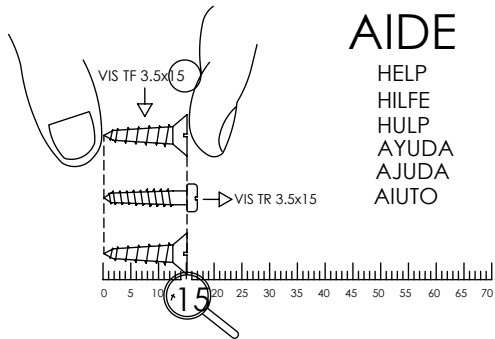

Solo

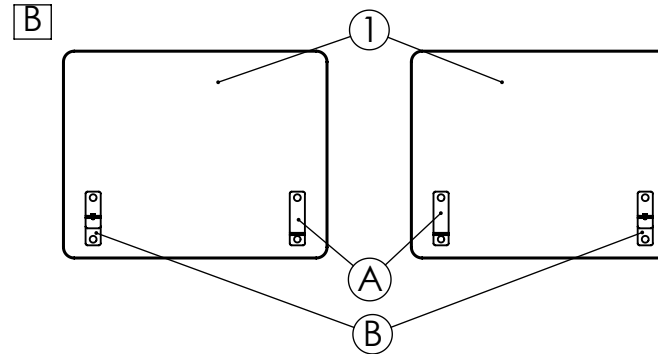

Bench

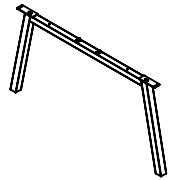

## NOMENCLATURE

(Parts list)  
(Stückliste)  
(Onderdelenlijst)  
(Nomenclatura)  
(Lista de peças)

Rep.	Pièce	Qté
1	Ecran latéral	1

## QUINCAILLERIE

(Hardware)  
(Beschlüge)  
(Ijzerwaren)  
(Ferramenta)  
(Herrajes)  
(Quinquilharia)

Rep.	Pièce	Qté
A	Equerre	2
C	Vis TFHC M6x20	4
E	Clé 6 pans 4mm	1
G	Cache	4
Rep.	Pièce	Qté
B	Equerre extrémité	2
C	Vis TFHC M6x20	4
D	Vis TFHC M5x14	2
E	Clé 6 pans 4mm	1
F	Clé 6 pans 3 mm	1
G	Cache	4

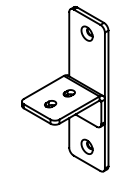
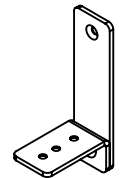

1/ **A** FIXE

COULISSANT

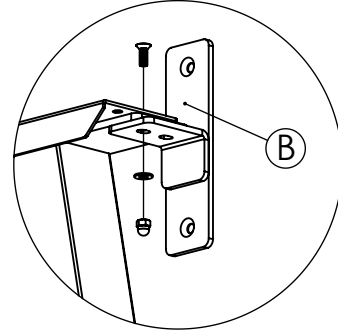
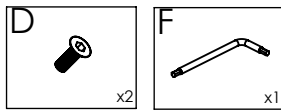
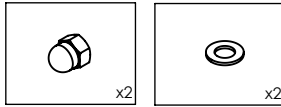
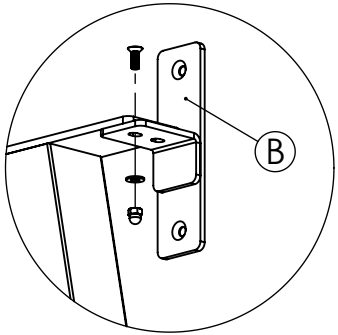
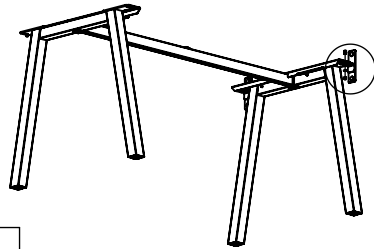
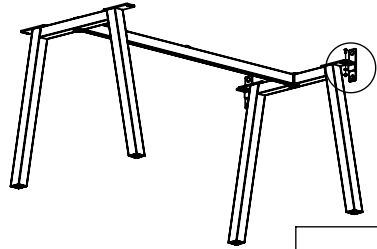

1/ **B** FIXE

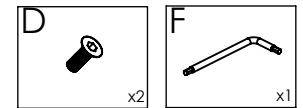
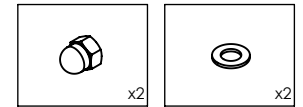
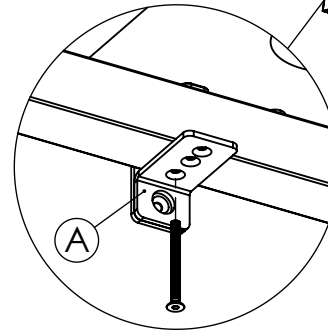
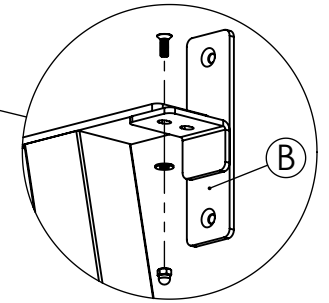
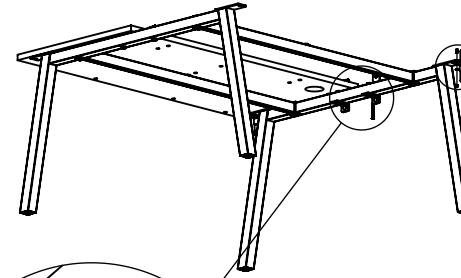

1/ **B** COULISSANT

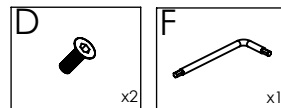
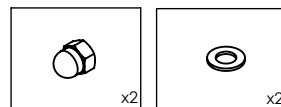
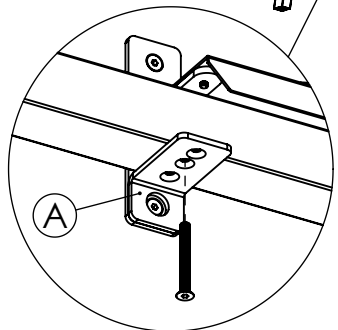
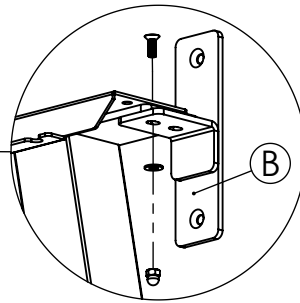
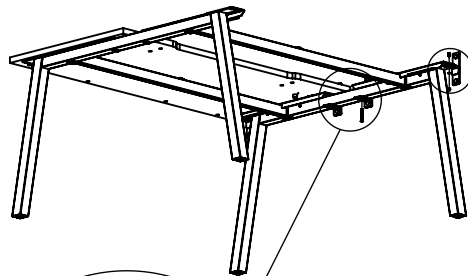

2

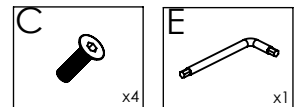
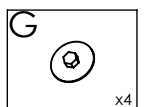
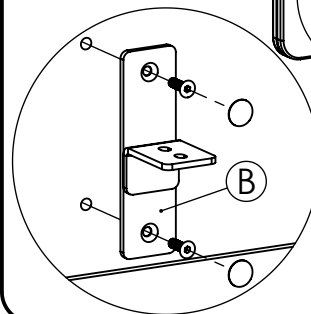
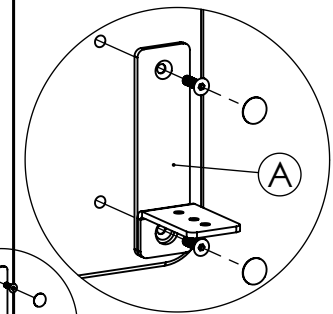
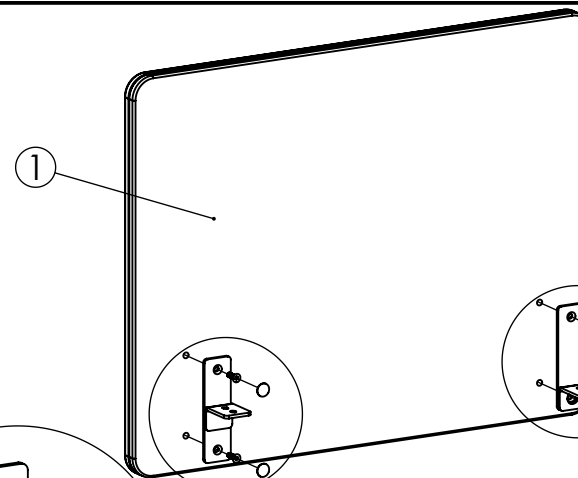

NOTICE DE MONTAGE  
INSTRUCTIONS FOR ASSEMBLY  
MONTAGEANLEITUNG  
GEBRUIKSAANWIJZING  
ISTRUZIONI DI MONTAGGIO  
INSTRUCCIONES DE MONTAJE  
INSTRUCCOES DE MONTAGEM

**buronomic**

FABRICANT FRANÇAIS

N° DV40836

CONCEPTION ET REALISATION BUREAU D'ETUDES BURONOMIC

**GARANTIE** (vices cachés)  
\_ Référence produit à nous communiquer impérativement en cas de litige :  
Voir étiquette apposée au dos du produit

**GARANTEE** (defekt)  
\_ In the event of complaint, it is essential to mention the product reference :  
See label affixed to the back of the product.

**GARANTIE** (fabrikationfelher)  
\_ Im streitfall sit uns die produktreferenz mitzuteilen :  
Siehe etikett auf produktruckseite.

**WAARBORG** (de verborgen gebreken)  
\_ Vermeld in geval van klachten altijd het productnummer :  
Zie label op de achterzijde van het product

**GARANZIA** (vizi occulti)  
\_ Specificare obbligatoriamente il riferimento prodotto in caso di contestazioni :  
Si veda l'etichetta applicata dietro il prodotto

**GARANTIA** (defectos ocultos)  
\_ Referencia de producto citese obligatoriamente en caso de reclamacion :  
Ver etiqueta en la parte posterior del producto.

**GARANTIA** (vícios ocultos)  
\_ Em caso de reclamacao indiq-nos imperativamente a referência do produto :  
Ver etiqueta fixada na parte posterior do produto

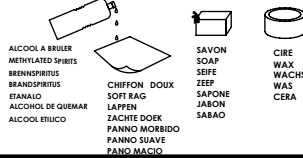
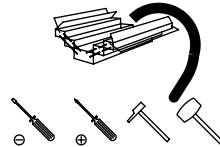
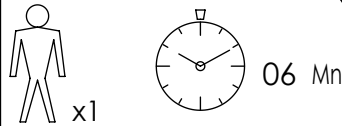
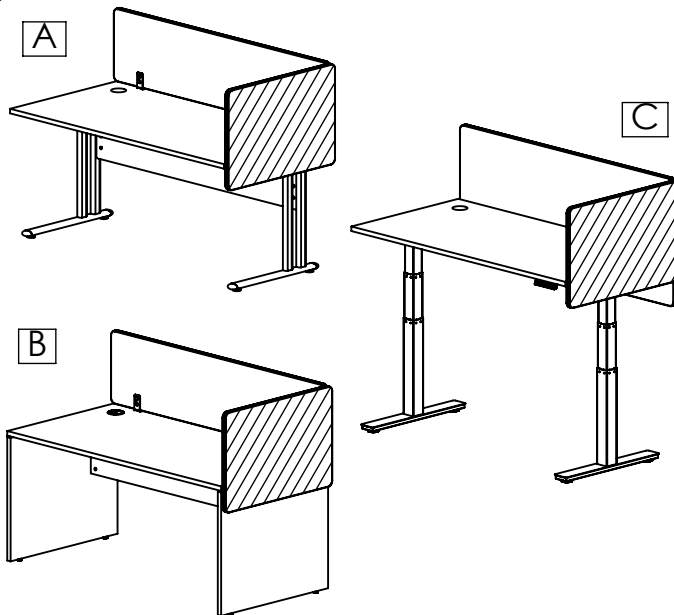
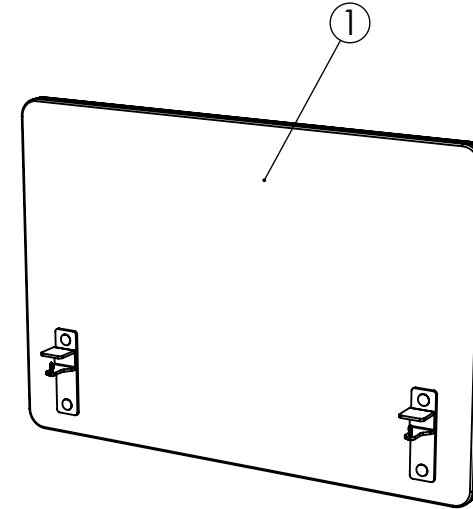

**NOMENCLATURE** (Parts list)  
(Stückliste)  
(Onderdelenlijst)  
(Nomenclatura)  
(Lista de peças)

Rep.	Pièce	Qté
1	ECRAN LATERAL	1

**QUINCAILLERIE** (Hardware)  
(Beschlüge)  
(Ijzerwaren)  
(Ferramenta)  
(Herrajes)  
(Quinquilharia)

Rep.	Pièce	Qté	A	B	C
A	Support écran	2			
B	Vis TFHC M6x20	4	D	E	F
C	Vis TCB 4x20	2			
D	Clé 6 pans 4mm	1			
E	Cache	4	G	H	I
			J	K	L
			M	N	O
			P	Q	R

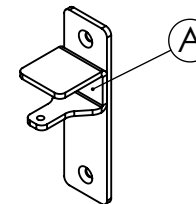

**AIDE**

HELP  
HILFE  
HULP  
AYUDA  
AJUDA  
AIUTO

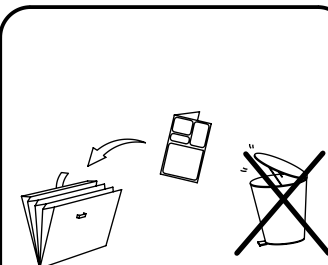
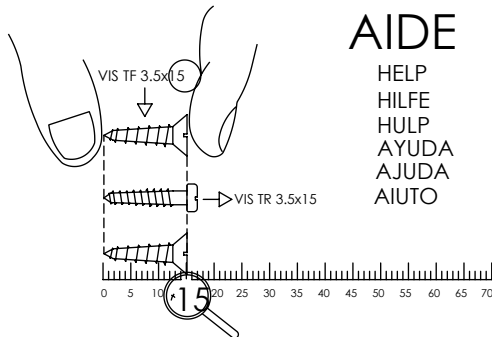



1

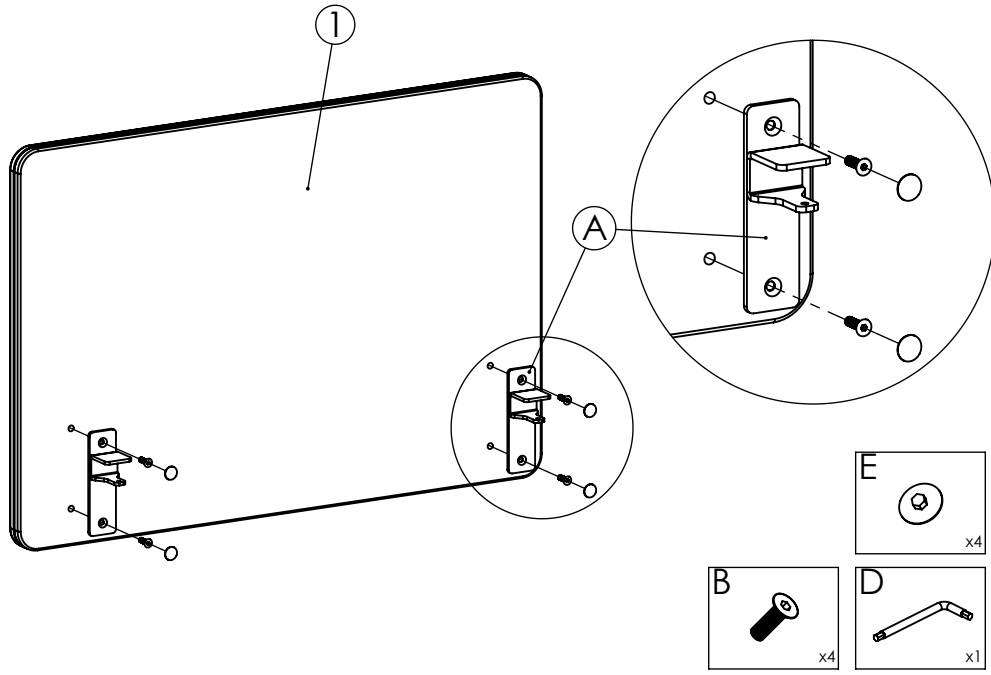

2/ A

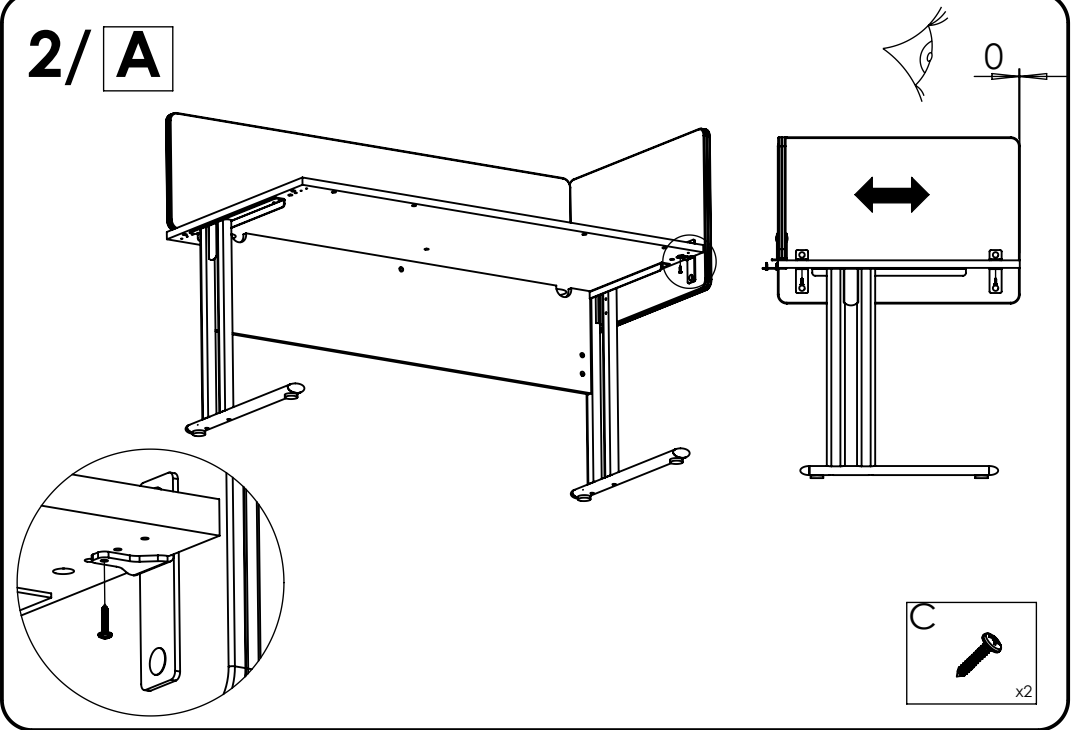

2/ B

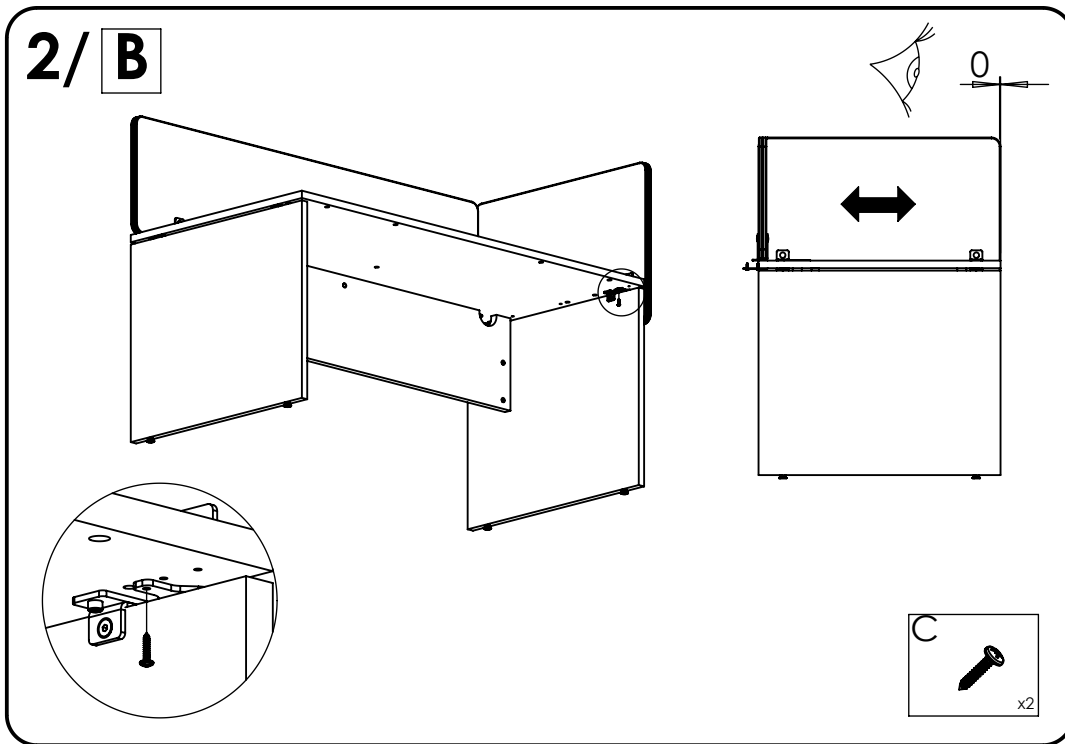

2/ C

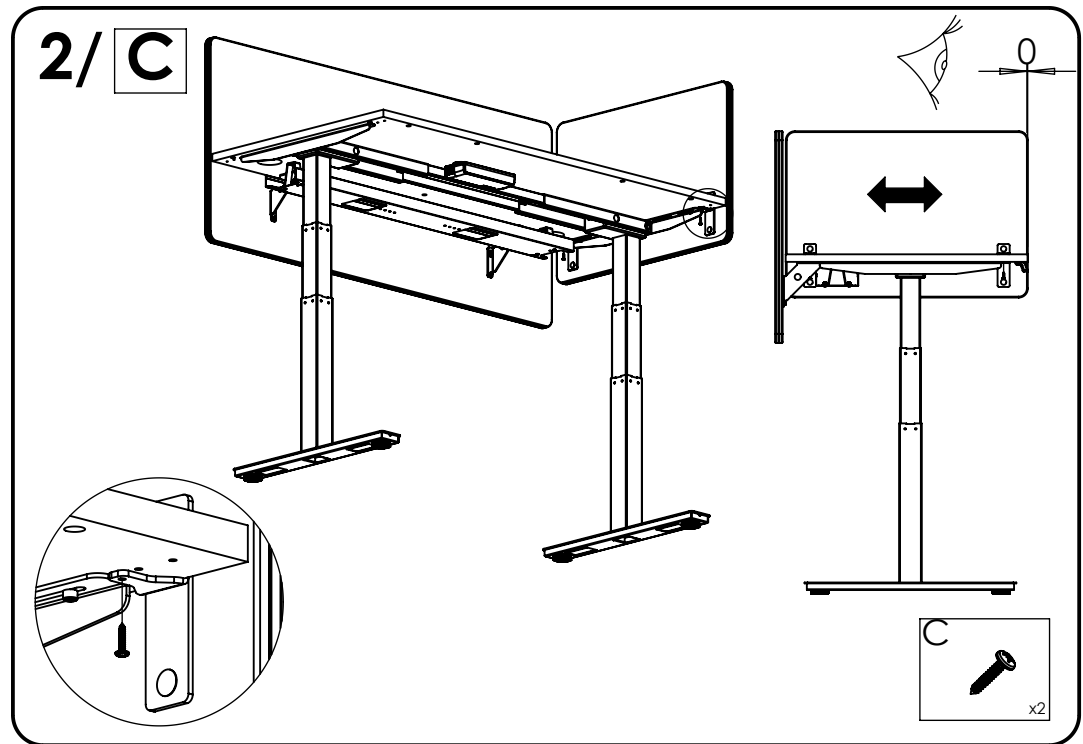

NOTICE DE MONTAGE  
INSTRUCTIONS FOR ASSEMBLY  
MONTAGEANLEITUNG  
GEBRUIKSAANWIJZING  
ISTRUZIONI DI MONTAGGIO  
INSTRUCCIONES DE MONTAJE  
INSTRUCCOES DE MONTAGEM

**buronomic**  
FABRICANT FRANÇAIS

N° DV40817\_1

CONCEPTION ET REALISATION BUREAU D'ETUDES BURONOMIC

**GARANTIE** (vices caches)  
\_ Référence produit à nous communiquer impérativement en cas de litige :  
Voir étiquette apposée au dos du produit

**GARANTEE** (defekt)  
\_ In the event of complaint, it is essential to mention the product reference :  
See label affixed to the back of the product.

**GARANTIE** (fabrikationsfeil)  
\_ Im streitfall sit uns die produktreferenz mitzuteilen :  
Siehe etikett auf produktruckseite.

**WAARBORG** (de verborgen gebreken)  
\_ Vermeld in geval van klachten altijd het productnummer :  
Zie label op de achterzijde van het product

**GARANZIA** (vizi occulti)  
\_ Specificare obbligatoriamente il riferimento prodotto in caso di contestazioni :  
Si veda l'etichetta applicata dietro il prodotto

**GARANTIA** (defectos ocullos)  
\_ Referencia de producto citese obligatoriamente en caso de reclamacion :  
Ver etiqueta en la parte posterior del producto.

**GARANTIA** (vices ocullos)  
\_ Em caso de reclamacao indiqu-nos imperativamente a referencia do produto :  
Ver etiqueta fixada na parte posterior do produto

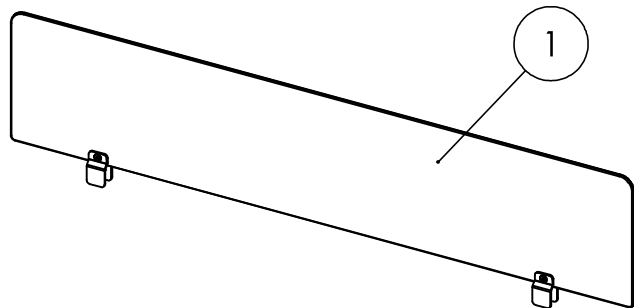
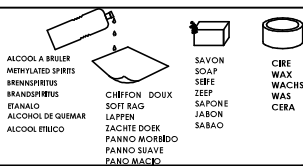
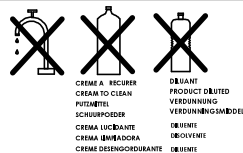
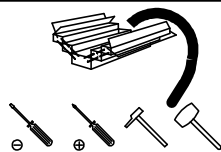
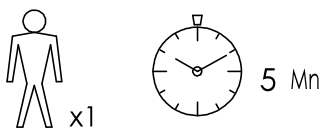

## AIDE

HELP  
HILFE  
HULP  
AYUDA  
AJUDA  
AIUTO

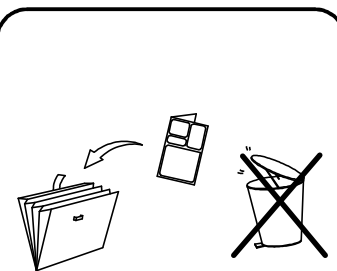
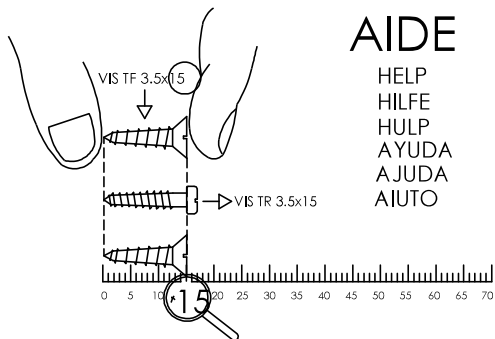

(Hardware)  
(Beschläge)  
(Ijzerwaren)  
(Ferramenta)  
(Herrajes)  
(Quinquilharia)

## QUINCAILLERIE

REP.	PIÉCE	QTÉ	A	B	C	D
1	REHAUSSE PLEXI	1				
A	DOUILLE M8X13	2				
B	VIS M8X10	2	E	F	G	H
C	FIXATION PLEXI	4				
D	KIT MOUSSE	1				
			I	J		

