

DISTRIB'GEL – Hydroalcoholic gel dispenser

Your handy protection!



- ✓ **No hand contact**
Pedal-activated hydroalcoholic gel dispenser, to avoid any hand contact with the tower.
- ✓ **Fully mechanical system**
Fully mechanical system fitted inside the column acting on the pump-bottle when the user's foot presses the pedal, located in the lower part of the tower. Stainless steel dispensing head with drip plug in the top part of the tower.
- ✓ **Universal**
Dispenser suitable for all types of disinfectant liquid (solution or gel), with its 450 ml pump-bottle (included).
- ✓ **Complete and ready to use**
Delivered ready to install. 2 metal accessories : support to display the user instructions and side shelf for a box of masks or gloves. Hydroalcoholic gel not supplied.
- ✓ **Robust and durable**
All-metal construction with steel column and stainless steel head. Mechanical bottle anti-theft system built into the stainless steel head.
- ✓ **Highly stable tower**
4 mm thick metal base plate, dimensions 30 x 30 cm, for a highly stable tower. 4 non-slip pads.
- ✓ **Quick and easy to install**
Easily installed in all indoor spaces (free-standing or attached to the floor). Pump-bottle easy to access and quick to fill.
- ✓ **Rechargeable pump-bottle included**
450 ml polyethylene pump-bottle supplied empty, rechargeable with all types of disinfectant liquid.

DISTRIB'GEL

Hydroalcoholic gel dispenser

With support for user instructions and side shelf

Overall dimensions :
D30 x H120 x 33,5 cm

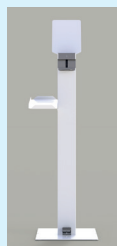

Each

Ref.

DM057S

Finish

White

Prices ex.VAT £ *

£ 286

* Dealer platform deliveries - Carriage fees will be applied according value of the orders:

- £30 for orders below £300 (net prices)
- £50 from £301 to £600 (net prices)
- Free carriage for orders above £601 (net prices). See our general sales conditions.

How to disinfect your hands properly in 7 steps



DISTRIB'GEL – Hydroalcoholic gel dispenser Your handy protection!

Protect yourself!
Disinfect your hands regularly

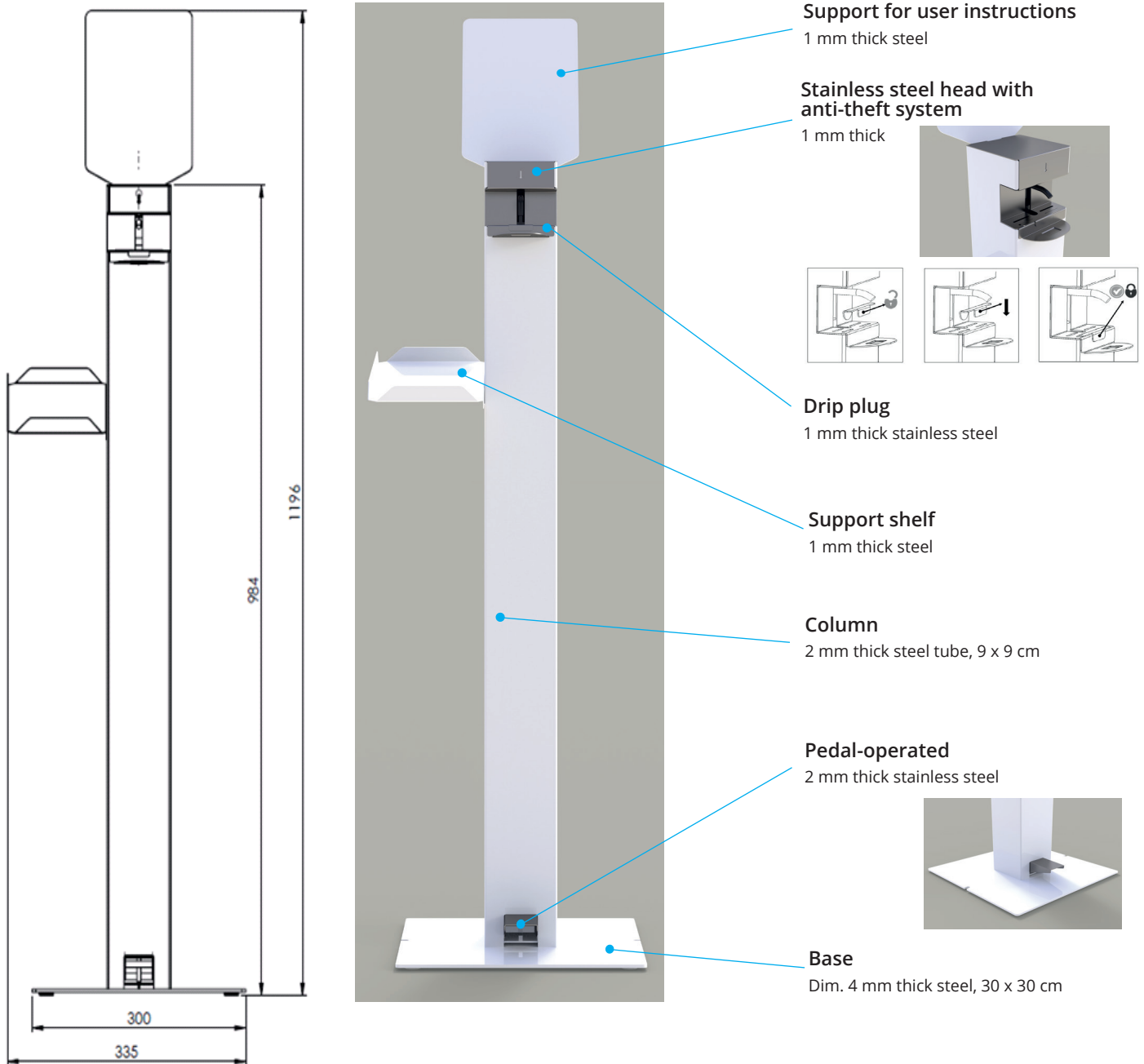

DISTRIB'GEL - Technical description

- Steel dispenser, 1 mm thick structure and 4 mm thick base, white epoxy finish (RAL 9003).
- Structure composed of a tubular square column, cross-section 90 x 90 mm, and a screwed base, cross-section 30 x 30 cm.
- Stainless steel removable head and stainless steel drip plug to dispense the hydroalcoholic gel.
- Pedal-operated system inside the column to dispense the required quantity of gel.
- Can only be used with the bottle supplied, capacity 450 ml.
- Hydroalcoholic gel not supplied.

